

EXISTING LEGEND

○	EXISTING MANHOLE	○	EXISTING TELEPHONE
○	EXISTING CLEANOUT	○	EXISTING OVERHEAD ELECTRIC
○	EXISTING SANITARY SEWER	○	EXISTING UNDERGROUND ELECTRIC
○	EXISTING OVERHEAD ELECTRIC & TELEPHONE	○	EXISTING UNDERGROUND TELEPHONE
○	EXISTING GAS	○	EXISTING WATER
○	EXISTING WATER & AIR	○	EXISTING WATER & AIR

PROPOSED IMPROVEMENTS

---	PROPERTY LINE / R.O.W.	---	PROPOSED OVERHEAD ELECTRIC
---	PROPOSED BUILDING	---	PROPOSED UNDERGROUND ELECTRIC
---	PROPOSED CURB AND GUTTER	---	PROPOSED OVERHEAD TELEPHONE
---	PROPOSED INLET	---	PROPOSED UNDERGROUND TELEPHONE
---	PROPOSED CURB INLET	---	PROPOSED GAS
---	PROPOSED STORM SEWER	---	PROPOSED WATER
---	PROPOSED CLEANOUT	---	PROPOSED WATER & AIR
---	PROPOSED SANITARY SEWER		
---	PROPOSED OVERHEAD ELECTRIC & TELEPHONE		
---	PROPOSED OVERHEAD ELECTRIC		
---	PROPOSED UNDERGROUND ELECTRIC		
---	PROPOSED OVERHEAD TELEPHONE		
---	PROPOSED UNDERGROUND TELEPHONE		
---	PROPOSED GAS		
---	PROPOSED WATER		
---	PROPOSED WATER & AIR		

LOVE'S TRAVEL STOP
I-75 EXIT 310 @ UNION GROVE ROAD
CALHOUN, GEORGIA

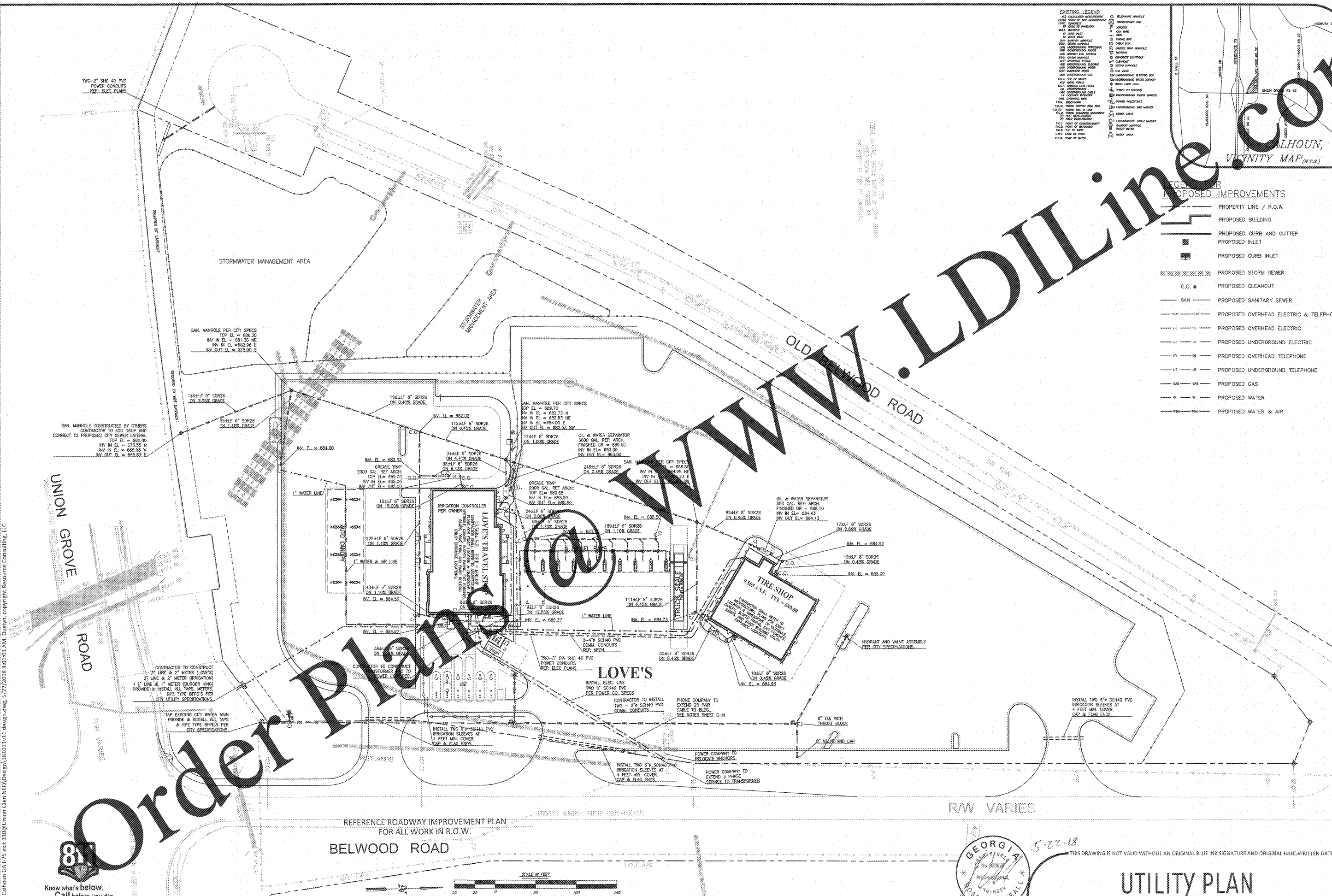
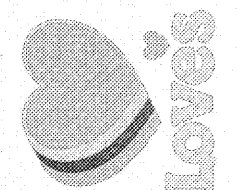

031 - Calhoun GA I-75 exit 310@Union Glen NEQ\Design\151031.dwg 5/22/2018 8:01:03 AM, D:\usr\ Copyright Resource Consulting, LLC

Order Plans
Know what's below.
Call before you dig.

REFERENCE ROADWAY IMPROVEMENT PLAN
FOR ALL WORK IN R.O.W.
BELWOOD ROAD



THIS DRAWING IS NOT VALID WITHOUT AN ORIGINAL BLUE INK SIGNATURE AND ORIGINAL HANDWRITTEN DATE OF A LICENSED PROFESSIONAL ENGINEER.

UTILITY PLAN

WWW.LDILine.com