

REFERENCE GRADING PLAN - SHEET C-3A FOR
BORROW AREA

R/W VARIES

LEGEND FOR
PROPOSED IMPROVEMENTS

- PROPERTY LINE / R.O.W.
- PROPOSED BUILDING
- PROPOSED CURB AND GUTTER
- PROPOSED INLET
- PROPOSED CURB INLET
- PROPOSED STORM SEWER
- PROPOSED ELEVATION

EXISTING LEGEND

- EXISTING ELEVATION
- EXISTING PROPERTY LINE
- EXISTING STORM SEWER
- EXISTING STORM INLET
- EXISTING CURB AND GUTTER
- EXISTING BUILDING
- EXISTING DRIVE
- EXISTING SIDEWALK
- EXISTING UTILITY
- EXISTING FENCE
- EXISTING TREE
- EXISTING POLE
- EXISTING SIGN
- EXISTING LIGHT
- EXISTING MAILBOX
- EXISTING DRIVEWAY
- EXISTING GARAGE
- EXISTING PATIO
- EXISTING PORCH
- EXISTING DECK
- EXISTING STAIR
- EXISTING RAMP
- EXISTING ELEVATION
- EXISTING PROPERTY LINE
- EXISTING STORM SEWER
- EXISTING STORM INLET
- EXISTING CURB AND GUTTER
- EXISTING BUILDING
- EXISTING DRIVE
- EXISTING SIDEWALK
- EXISTING UTILITY
- EXISTING FENCE
- EXISTING TREE
- EXISTING POLE
- EXISTING SIGN
- EXISTING LIGHT
- EXISTING MAILBOX
- EXISTING DRIVEWAY
- EXISTING GARAGE
- EXISTING PATIO
- EXISTING PORCH
- EXISTING DECK
- EXISTING STAIR
- EXISTING RAMP
- EXISTING ELEVATION

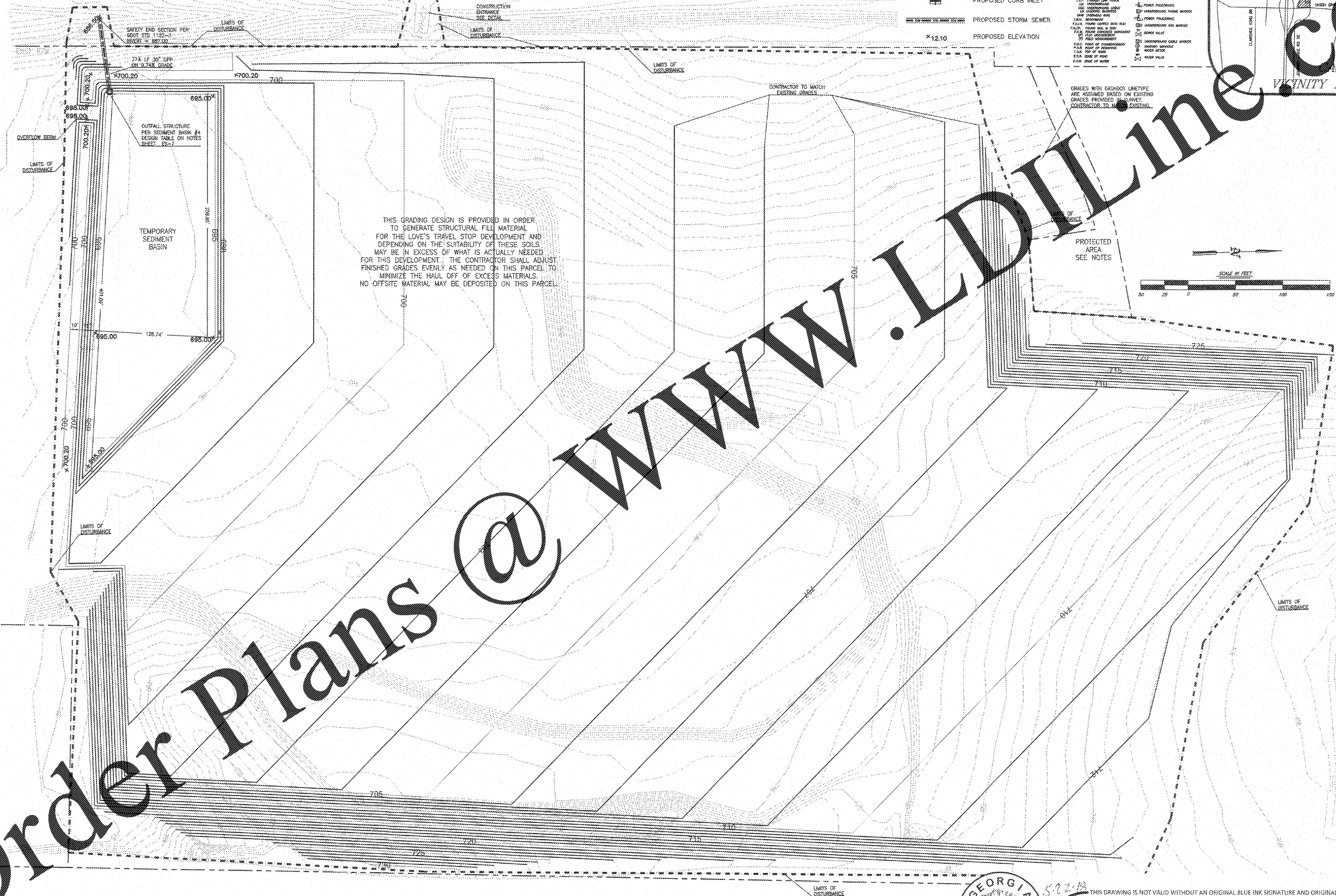

THIS GRADING DESIGN IS PROVIDED IN ORDER TO GENERATE STRUCTURAL FILL MATERIAL FOR THE LOVE'S TRAVEL STOP DEVELOPMENT AND DEPENDING ON THE SUITABILITY OF THESE SOILS MAY BE IN EXCESS OF WHAT IS ACTUALLY NEEDED FOR THIS DEVELOPMENT. THE CONTRACTOR SHALL ADJUST FINISHED GRADES EVENLY AS NEEDED ON THIS PARCEL TO MINIMIZE THE HAUL OFF OF EXCESS MATERIALS. NO OFFSITE MATERIAL MAY BE DEPOSITED ON THIS PARCEL.

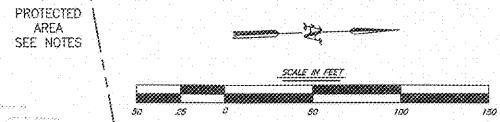

www.LDLine.com



Know what's below.
Call before you dig.



GRADING PLAN

C-3B

LOVE'S TRAVEL STOP
I-75 EXIT 310 @ UNION GROVE ROAD
CALHOUN, GEORGIA

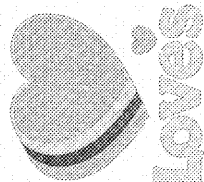

RESOURCE CONSULTING
CIVIL ENGINEERING
6700 Jefferson Highway - Suite 4A
Baton Rouge, Louisiana 70806
ResourceConsulting@gmail.com
Tel: (225) 761-9909, Fax: (225) 766-6672