

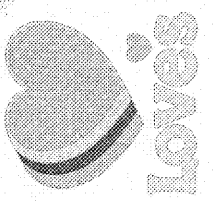

LOVE'S TRAVEL STOP
I-75 EXIT 310 @ UNION GROVE ROAD
CALHOUN, GEORGIA



C-3A

LEGEND FOR PROPOSED IMPROVEMENTS

- PROPERTY LINE / R.O.W.
- PROPOSED BUILDING
- PROPOSED CURB AND GUTTER
- PROPOSED INLET
- PROPOSED CURB INLET
- PROPOSED STORM SEWER
- PROPOSED ELEVATION
- FRENCH DRAINS

EXISTING LEGEND

- EXISTING ROADWAY
- EXISTING SIDEWALK
- EXISTING CURB AND GUTTER
- EXISTING INLET
- EXISTING CURB INLET
- EXISTING STORM SEWER
- EXISTING ELEVATION
- EXISTING FRENCH DRAINS

CALHOUN, GA
VICINITY MAP (N.T.S.)

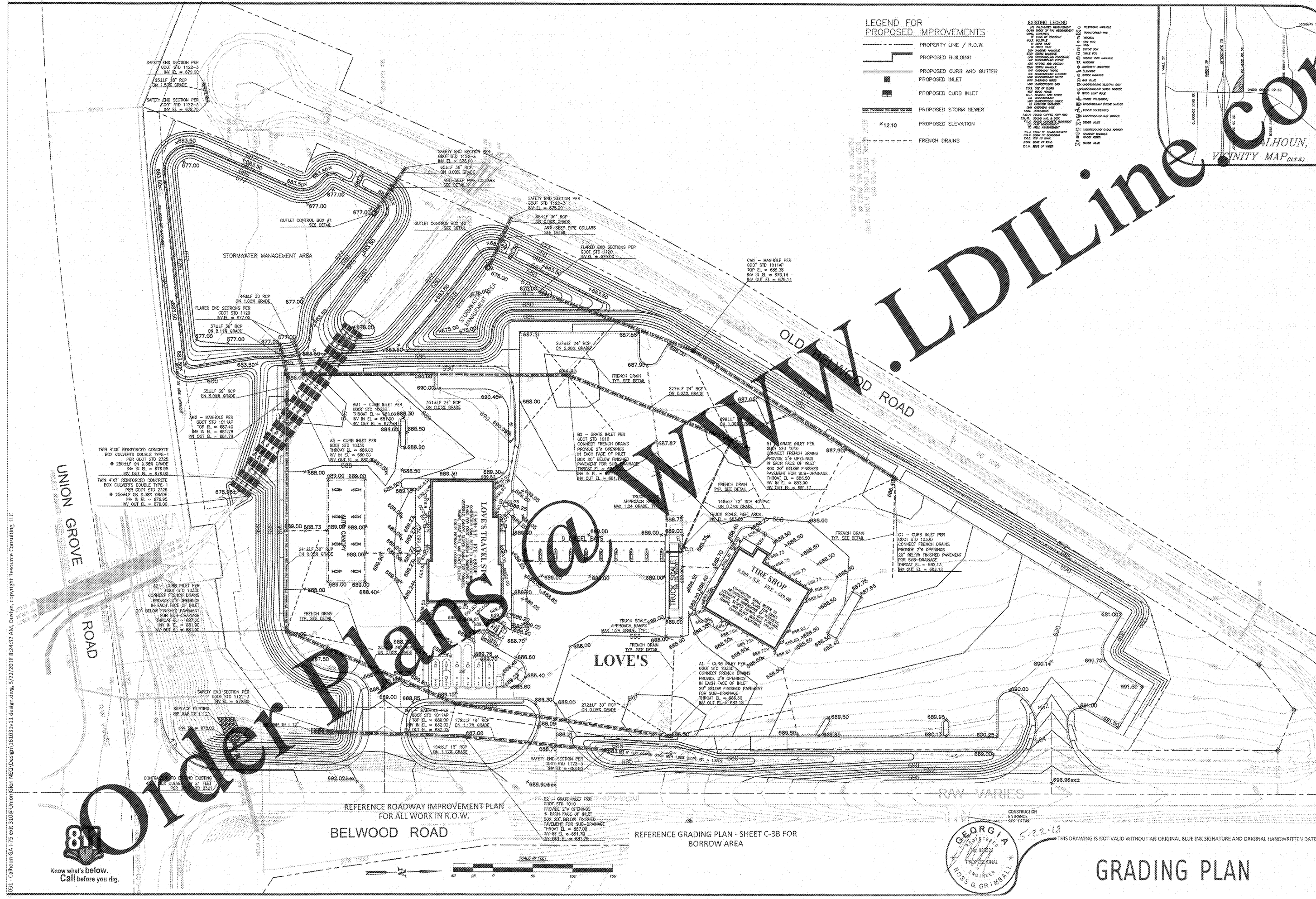

Order Plans

REFERENCE ROADWAY IMPROVEMENT PLAN
FOR ALL WORK IN R.O.W.
BELWOOD ROAD

REFERENCE GRADING PLAN - SHEET C-3B FOR
BORROW AREA

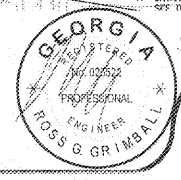

GRADING PLAN

THIS DRAWING IS NOT VALID WITHOUT AN ORIGINAL BLUE INK SIGNATURE AND ORIGINAL HANDWRITTEN DATE OF A LICENSED PROFESSIONAL ENGINEER.

0311 - Calhoun GA I-75 exit 310@UnionGroveRoad.dwg, 5/22/2018 8:24:32 AM, D:\Users\dustyn\OneDrive\Documents\161031v11.dwg, copyright Resource Consulting, LLC

Know what's below.
Call before you dig.