



LOVE'S TRAVEL STOP
 I-75 EXIT 310 @ UNION GROVE ROAD
 CALHOUN, GEORGIA



C-2

LEGEND FOR PROPOSED IMPROVEMENTS

- PROPERTY LINE / R.O.W.
- PROPOSED BUILDING
- PROPOSED CURB AND GUTTER
- PROPOSED SAW CUT JOINT
- PROPOSED SIDEWALK SAWED CONTRACTION JOINT
- PROPOSED EXTRA HEAVY DUTY ASPHALT PAVEMENT
- PROPOSED HEAVY DUTY ASPHALT PAVEMENT
- PROPOSED MEDIUM DUTY ASPHALT PAVEMENT
- PROPOSED LIGHT DUTY ASPHALT PAVEMENT
- PROPOSED EXTRA HEAVY DUTY CONCRETE PAVEMENT
- PROPOSED HEAVY DUTY CONCRETE PAVEMENT
- PROPOSED LIGHT DUTY CONCRETE PAVEMENT
- PROPOSED ROADWAY WIDENING ASPHALT PAVEMENT
- PROPOSED GRAVEL DRIVEWAY

EXISTING LEGEND

- EXISTING ASPHALT
- EXISTING CONCRETE
- EXISTING GRAVEL
- EXISTING SIDEWALK
- EXISTING CURB
- EXISTING GUTTER
- EXISTING DRIVEWAY
- EXISTING FENCE
- EXISTING UTILITY
- EXISTING TREE
- EXISTING LANDSCAPE
- EXISTING SIGN
- EXISTING LIGHT
- EXISTING STRUCTURE
- EXISTING WALL
- EXISTING POLE
- EXISTING SIGN
- EXISTING LIGHT
- EXISTING STRUCTURE
- EXISTING WALL
- EXISTING POLE

CALHOUN, GA
 VICINITY MAP (N.T.S.)

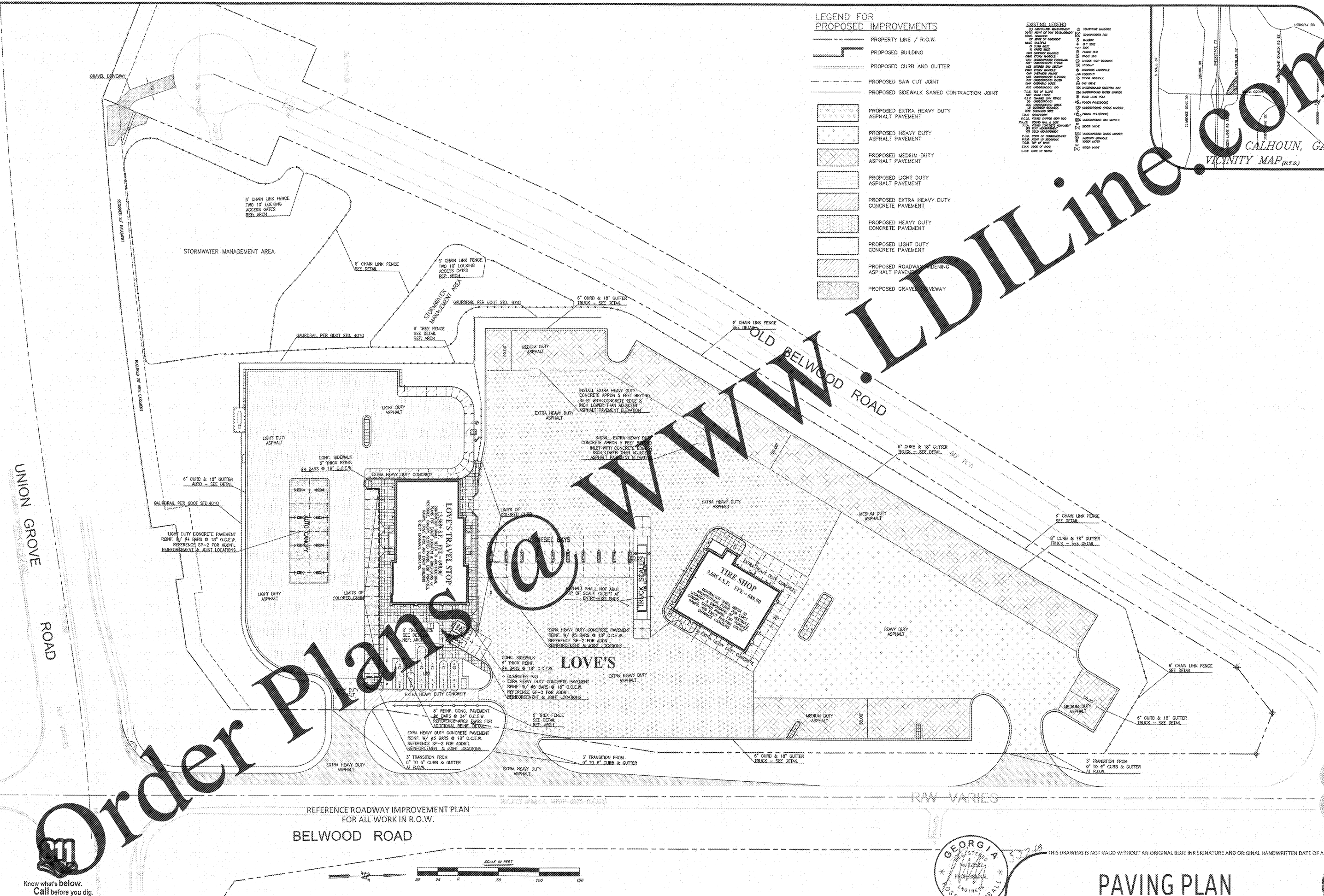

REFERENCE ROADWAY IMPROVEMENT PLAN
 FOR ALL WORK IN R.O.W.
BELWOOD ROAD

Order Plans
 Know what's below.
 Call before you dig.



PAVING PLAN

01/16/031 - Calhoun GA I-75 exit 310 @ Union Grove Road design.dwg, 5/22/2018 10:05:51 PM, jsmc, copyright Resource Consulting, LLC