

SIGNAGE AND MARKING PLAN

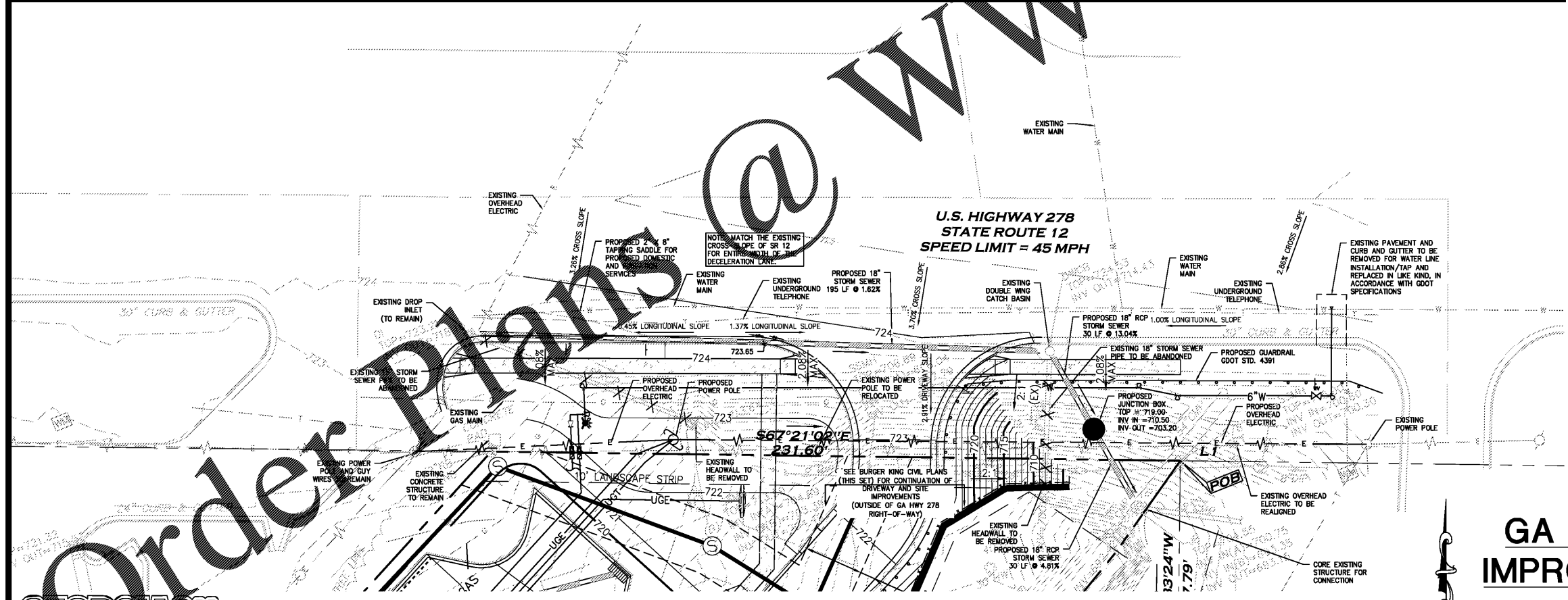

GRADING AND UTILITY PLAN

GA HWY 12 ROAD IMPROVEMENT PLAN

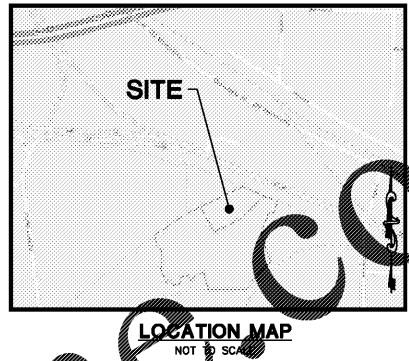
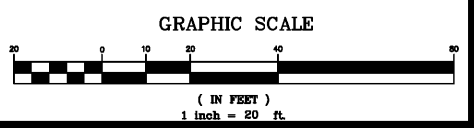

LEGEND FOR PROPOSED IMPROVEMENTS

- PROPOSED CURB AND GUTTER
- HEAVY DUTY ASPHALTIC PAVEMENT
- CONCRETE SIDEWALK
- HEAVY DUTY DOT ASPHALTIC PAVEMENT
- MILL AND INLAY EXISTING ASPHALTIC PAVEMENT
- X X X X X ITEMS TO BE REMOVED OR ABANDONED

Project Title
PROPOSED BURGER KING
COVINGTON, GA
BY: PREMIER HOLDINGS OF GEORGIA, LLC
MONTGOMERY, AL

REVISIONS	BY

DRAWN BY SCR
CHECKED BY THH
DATE 08/27/2018
SCALE 1" = 20'
JOB No. 17-CE-015
SHEET NUMBER

R-2

WOLVERSON
 Engineering, Inc.
 6745 Sugarloaf Parkway • Suite 100 • Duluth, Georgia 30017
 www.wolverson.com

USER: shnell\collman - Jul 03, 2018 - 2:06pm
 Z:\V\Project Data\Projects\2017\17-CE-015 Covington GA Premier Kings\CE\Production Drawings\17-CE-015 Main.dwg - LAYOUT: R-2 VERSION: -----
 ORDER PLANS @ WWW.LDMLINE.COM



OUT TO BID