

**PARKING ISLAND DETAIL**

NOT TO SCALE

N/F  
SPIRIT MASTER FUNDING VII, LLC  
DB-3212 PG-591

NOTE:  
SOME OF THE STREET TREES WERE  
LOCATED AWAY FROM THE LANDSCAPE  
STRIP DUE TO EASEMENTS & UTILITIES

U.S. HIGHWAY 278  
STATE ROUTE 12  
SPEED LIMIT 45 MRH

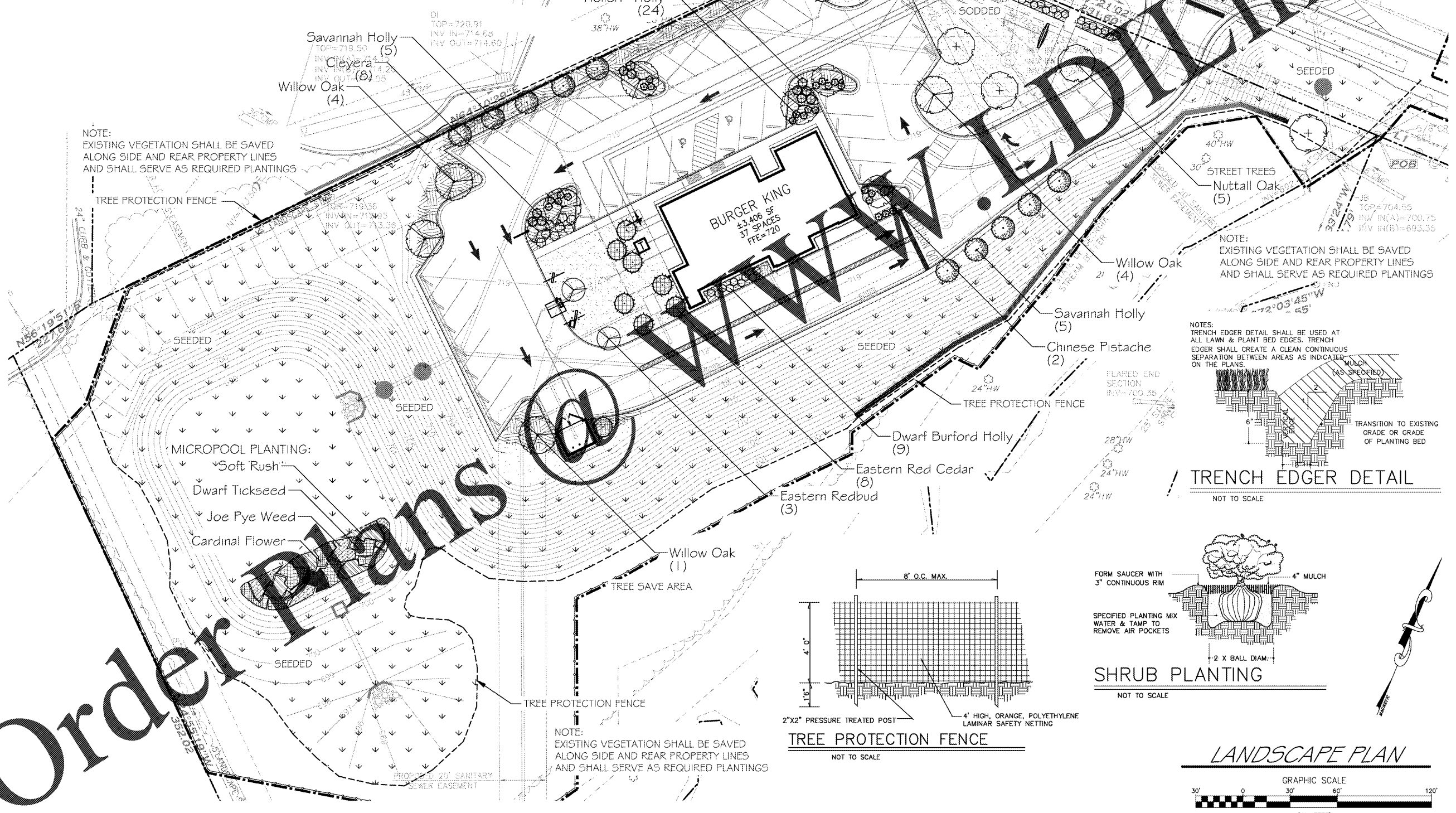

NOTE:  
EXISTING VEGETATION SHALL BE SAVED  
ALONG SIDE AND REAR PROPERTY LINES  
AND SHALL SERVE AS REQUIRED PLANTINGS

NOTE:  
EXISTING VEGETATION SHALL BE SAVED  
ALONG SIDE AND REAR PROPERTY LINES  
AND SHALL SERVE AS REQUIRED PLANTINGS

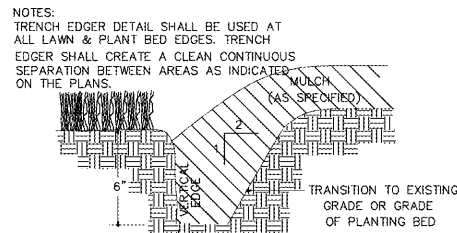

**TRENCH EDGER DETAIL**

NOT TO SCALE

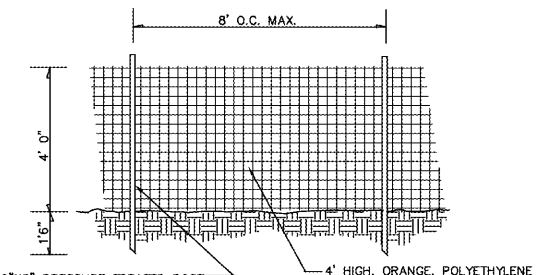

**TREE PROTECTION FENCE**

NOT TO SCALE

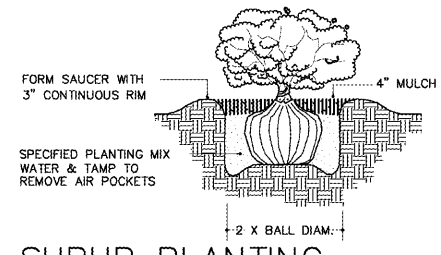

**SHRUB PLANTING**

NOT TO SCALE

**LANDSCAPE PLAN**

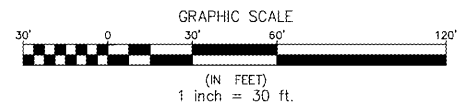

Order Plans

DAVID ALBRIGHT & ASSOCIATES  
PLANNERS & LANDSCAPE ARCHITECTS  
78 U.S. HIGHWAY 278  
NEWNAN, GEORGIA 30568  
TEL: (404) 862-0380 E-MAIL: DAVID@ALBRIGHT.COM



Project Title  
**PROPOSED BURGER KING  
COVINGTON, GA**  
BY: PREMIER HOLDINGS OF GEORGIA, LLC  
MONTGOMERY, AL

REVISIONS	BY
Revised 7-3-18 City Comments	DFA

DRAWN BY dfa  
CHECKED BY dfa  
DATE: 05/09/2018  
SCALE: 1" = 30'  
JOB No. 18-023  
SHEET NUMBER