

USER: sheredd/robison - Jul 03, 2018 - 2:05pm
 Z:\All Project Data\Projects\2017\17-CE-015 Covington GA Premier King\CE\Production Drawings\17-CE-015 Details.dwg

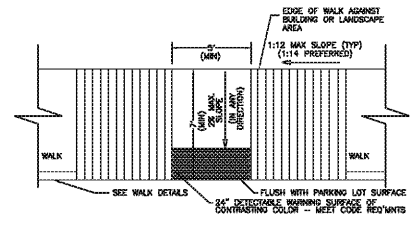

ACCESSIBLE PARKING RAMP
 SCALE: NO SCALE
 OCTOBER 28, 2010

BURGER KING CORPORATION		1
SCALE: NONE	DATE: 11/13/99	OF 1
REVISION: 10/28/10	DESCRIPTION: ACCESSIBLE PARKING RAMP	

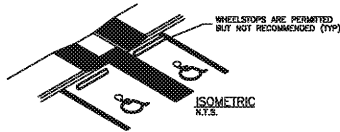
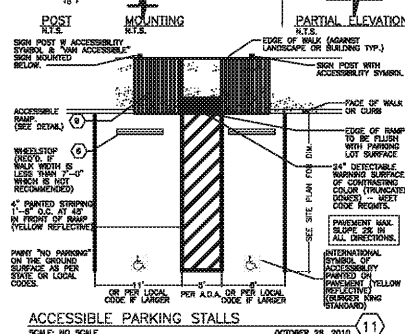
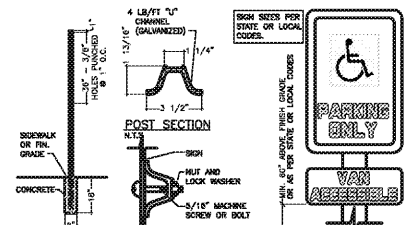

ACCESSIBLE PARKING STALLS
 SCALE: NO SCALE
 OCTOBER 28, 2010

BURGER KING CORPORATION		1
SCALE: AS NOTED	DATE: 7/15/99	OF 1
REVISION: 10/28/10	DESCRIPTION: ACCESSIBLE PARKING STALLS	

6" BARRIER CURB
 SCALE: 1/4" = 1'-0"
 APRIL 18, 2008

BURGER KING CORPORATION		1
SCALE: 1/4" = 1'-0"	DATE: 7/15/99	OF 1
REVISION: 4/18/08	DESCRIPTION: 6" BARRIER CURB	

WHEELSTOP (PRECAST CONCRETE)
 SCALE: NO SCALE
 JUNE 12, 2008

BURGER KING CORPORATION		1
SCALE: NONE	DATE: 7/15/99	OF 1
REVISION: 6/12/08	DESCRIPTION: WHEELSTOP (PRECAST CONCRETE)	

BURGER KING CORPORATION
 ALT. CONCRETE RAMP - INTERNAL
 SCALE: NO SCALE
 OCTOBER 28, 2010

BURGER KING CORPORATION		1
SCALE: NONE	DATE: 7/15/99	OF 1
REVISION: 10/28/10	DESCRIPTION: ALT. CONCRETE RAMP - INTERNAL	

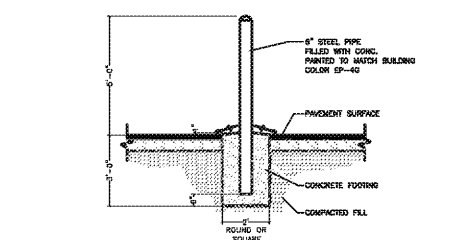

TYPICAL GUARD POST
 SCALE: NO SCALE
 JULY 8, 2010

BURGER KING CORPORATION		1
SCALE: NONE	DATE: 7/15/99	OF 1
REVISION: 7/8/10	DESCRIPTION: TYPICAL GUARD POST	

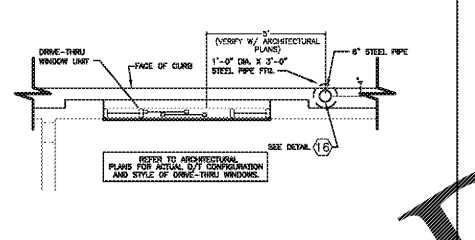

GUARD POST @ D/T WINDOW
 SCALE: NO SCALE
 OCTOBER 28, 2010

BURGER KING CORPORATION		1
SCALE: NONE	DATE: 7/15/99	OF 1
REVISION: 10/28/10	DESCRIPTION: GUARD POST @ D/T WINDOW	

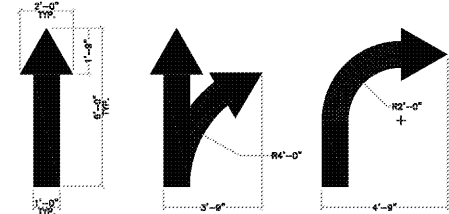

PAINTED TRAFFIC ARROWS
 SCALE: N.T.S.
 JULY 15, 1999

BURGER KING CORPORATION		1
SCALE: N.T.S.	DATE: 7/15/99	OF 1
REVISION: 7/15/99	DESCRIPTION: PAINTED TRAFFIC ARROWS	

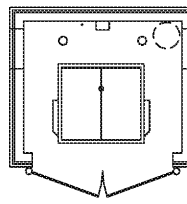

DUMPSTER PLAN
 SCALE: 1/4" = 1'-0"

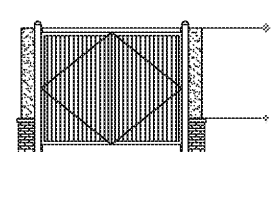

DUMPSTER FRONT ELEVATION
 SCALE: 1/4" = 1'-0"

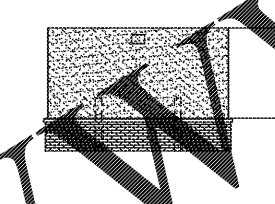

DUMPSTER REAR ELEVATION
 SCALE: 1/4" = 1'-0"

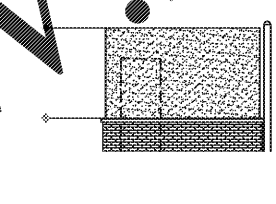

DUMPSTER SIDE ELEV.
 SCALE: 1/4" = 1'-0"

DUMPSTER DETAIL
 N.T.S.

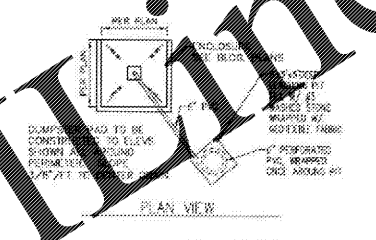

CITY OF COVINGTON
 DUMPSTER ENCLOSURE DETAIL
 N.T.S.

BELSON
 OUTDOORS
 Model # CBBR-SUR-BK
 Dimension Sheet

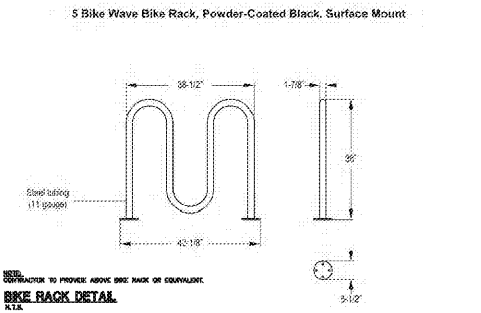

BIKE RACK DETAIL
 N.T.S.

Order Plans @



GSWCC# 22364

Project Title
**PROPOSED BURGER KING
 COVINGTON, GA**
 BY: PREMIER HOLDINGS OF GEORGIA, LLC
 MONTGOMERY, AL

REVISIONS	BY

DRAWN BY: SCR
 CHECKED BY: THH
 DATE: 08/27/2018
 SCALE: NO SCALE
 JOB No.: 17-CE-015
 SHEET NUMBER

D-1B

SITE PLAN DETAILS