

USER: shnell/robinnen - Jul 03, 2018 - 2:04pm
 Z:\V\Project Data\Projects\2017\17-CE-015 Covington GA Premier Kings\CE\Production Drawings\17-CE-015 Main.dwg -- LAYOUT: ST-1 VERSION: -----

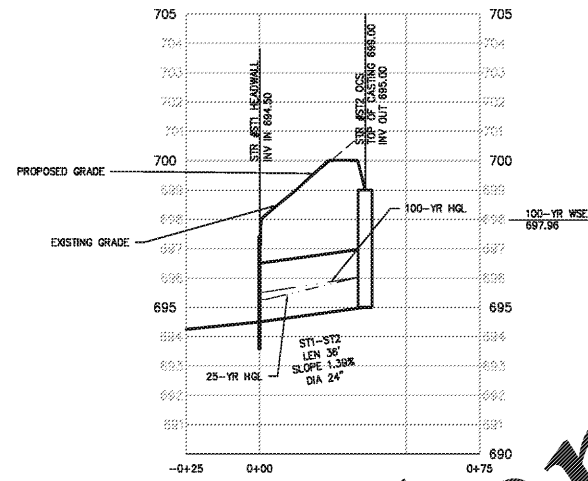

Know what's below.
 Call before you dig.

**** NOTE ****
 CONTRACTOR IS RESPONSIBLE FOR COMPARING THE STORM AND SANITARY
 SEWER SCHEDULES WITH THE PROFILES FOR THE STORM AND SEWER LINES
 AND INFORMING THE ENGINEER OF ANY CONFLICTS OR DISCREPANCIES PRIOR
 TO COMMENCEMENT OF CONSTRUCTION.



ST1 THRU ST2
 scale: 1"=30' horizontal
 1"=3' vertical

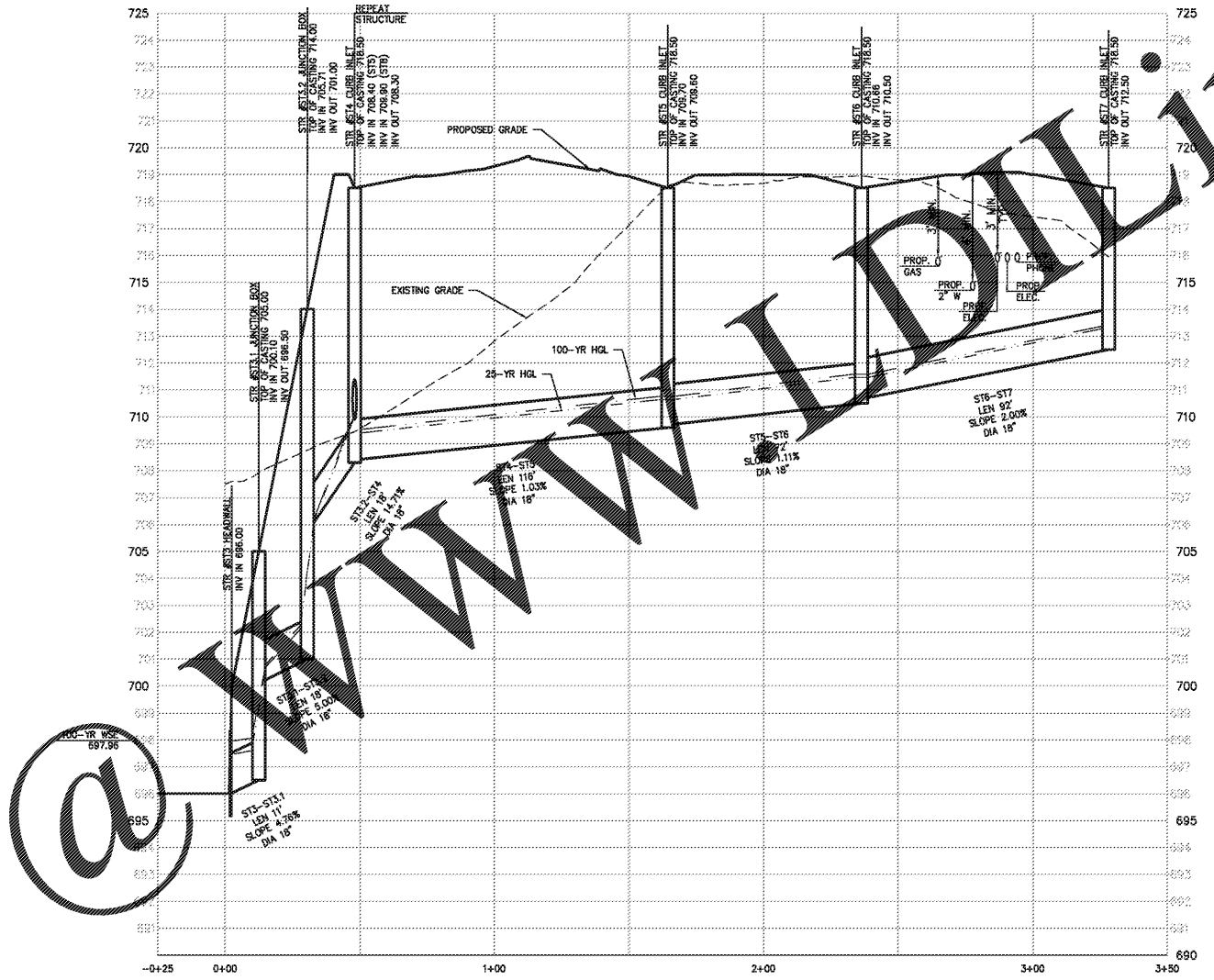

ST3 THRU ST7
 scale: 1"=30' horizontal
 1"=3' vertical

**STORM SEWER
 PROFILES**

REVISIONS	BY

DRAWN BY: SCR
 CHECKED BY: THH
 DATE: 08/27/2018
 SCALE: 1"= 60'
 JOB No. 17-CE-015
 SHEET NUMBER

ST-1

Project Title
**PROPOSED BURGER KING
 COVINGTON, GA**
 BY: PREMIER HOLDINGS OF GEORGIA, LLC
 MONTGOMERY, AL

GSWCC# 22364

WOLVERTON
 Engineering, Surveying, & Construction
 6745 Sugarloaf Parkway • Suite 100 • Duluth, Georgia 30017
 www.wolvertongroup.com

OUT TO BID