

USER: shnell\collinsen - Jul 03, 2018 - 2:04pm
 Z:\V\Project Data\Projects\2017\17-CE-015 Covington GA Premier Kings\CE\Production Drawings\17-CE-015 Main.dwg - LAYOUT: SS-1 REVISION: -----

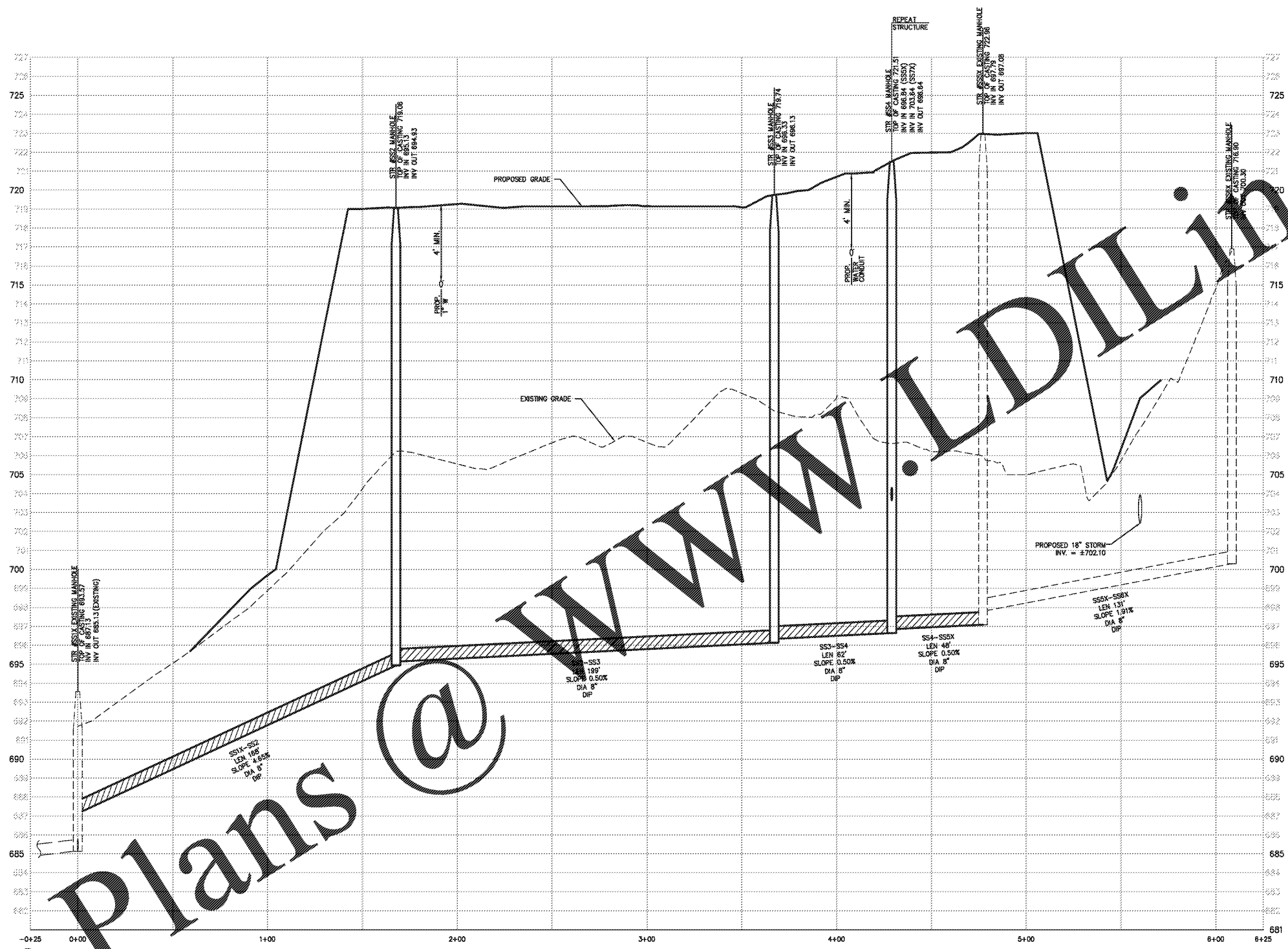

ST1X THRU ST6X
 scale: 1"=30' horizontal
 1"=3' vertical



**** NOTE ****
 CONTRACTOR IS RESPONSIBLE FOR COMPARING THE STORM AND SANITARY SEWER SCHEDULES WITH THE PROFILES FOR THE STORM AND SEWER LINES AND INFORMING THE ENGINEER OF ANY CONFLICTS OR DISCREPANCIES PRIOR TO COMMENCEMENT OF CONSTRUCTION.

**SANITARY SEWER
 PROFILES**

REVISIONS	BY

DRAWN BY SCR
 CHECKED BY THH
 DATE 08/27/2018
 SCALE 1"= 30'
 JOB No. 17-CE-015
 SHEET NUMBER

SS-1

GSWCC# 22364

Project Title
**PROPOSED BURGER KING
 COVINGTON, GA**
 BY: PREMIER HOLDINGS OF GEORGIA, LLC
 MONTGOMERY, AL

W WOLVERTON
 Engineering, Inc.
 6745 Sugarloaf Parkway • Suite 100 • Duluth, Georgia 30017
 www.wolvertoninc.com

Order Plans @

WWW.LDILINE.COM

OUT TO BID