

INDIVIDUAL ARCHITECTURAL
REGISTRATION NO.:
3458

GENERAL NOTES

- (A) REFER TO PROJECT MANUAL FOR ADDITIONAL REQUIREMENTS.
- (B) EXISTING CONDITIONS BASED UPON OWNER'S INFORMATION. FIELD VERIFY EXISTING CONDITIONS BY DETAILED INSPECTION PRIOR TO SUBMITTING BID AND BEGINNING CONSTRUCTION. NOTIFY ARCHITECT IF EXISTING CONDITIONS DEVIATE SUBSTANTIAL FROM THOSE INDICATED HEREIN.
- (C) EXISTING CONSTRUCTION TO BE REWORKED AS NOTED FOR INSTALLATION OF NEW CONSTRUCTION. FIELD VERIFY TYPE OF WORK REQUIRED.
- (D) CONTRACTOR TO SCHEDULE WORK WITH OWNER. OWNER TO MAINTAIN OPERATION OF BUILDING DURING NORMAL BUSINESS HOURS. BUILDING TO BE SEIZURABLE AFTER BUSINESS HOURS.
- (E) CONTRACTOR TO MAINTAIN CLEAR UNOBSTRUCTED PATHS OF EGRESS AND EXITS AT ALL TIMES. BUILDING IS OCCUPIED DURING CONSTRUCTION. PROVIDE TEMPORARY EMERGENCY LIGHTING, EXIT SIGNS AND FIRE EXTINGUISHING SYSTEMS AS REQUIRED.
- (F) EXISTING CONSTRUCTION IS TO REMAIN TO BE PROTECTED AS REQUIRED. REMOVE AND REPLACE DAMAGED CONSTRUCTION DUE TO CONTRACTOR'S ACTIVITIES.
- (G) PROVIDE TEMPORARY SHORING OR BRACING OF EXISTING STRUCTURAL SYSTEM AS REQUIRED FOR INSTALLATION OF NEW CONSTRUCTION.
PROVIDE TEMPORARY DUST PROTECTION AS REQUIRED.
- (I) ALL SALVAGE TO CONTRACTOR UNLESS OTHERWISE NOTED.
- (J) WHEN NECESSARY TO INTERRUPT UTILITY SERVICES, PROVIDE A MINIMUM OF 48 HOURS ADVANCE NOTICE TO THE OWNER. INTERRUPTIONS IN UTILITY SERVICES SHALL BE OF THE SHORTEST POSSIBLE DURATION FOR THE WORK AT HAND AND SHALL BE APPROVED IN ADVANCE BY THE OWNER.
- (K) REFER TO MECHANICAL, ELECTRICAL, AND PLUMBING DRAWINGS FOR ADDITIONAL REQUIREMENTS.

Reilly AUTO PARTS
CORPORATE OFFICES
233 SOUTH PATTERSON
SPRINGFIELD, MISSOURI 65802
(417) 862-2674 TELEPHONE

KEY NOTES

- (1) EXISTING WALL CONSTRUCTION TO BE REMOVED AS REQUIRED FOR INSTALLATION OF NEW CONSTRUCTION.
- (2) EXISTING DOOR CONSTRUCTION TO BE REMOVED AS REQUIRED FOR INSTALLATION OF NEW CONSTRUCTION.
- (3) EXISTING PLUMBING FIXTURE AND ASSOCIATED ACCESSORIES TO BE REMOVED. REFER TO PLUMBING PLANS FOR ADDITIONAL INFORMATION.
- (4) EXISTING SLAB TO BE SAW CUT AND REMOVED AS REQUIRED FOR DEMOLITION OF EXISTING WASTE AND VENT PIPING. REFER TO PLUMBING PLANS. REPAIR/REPLACE SLAB TO MATCH EXISTING.

PROJECT: (ADDITION)
O'REILLY AUTO PARTS STORE
2730 HIGHWAY 80 EAST
PEARL, MISSISSIPPI
DEMOLITION FLOOR PLAN

**ENVIRONMENTAL
GENERAL NOTES**

- (A) AN ENVIRONMENTAL ANALYSIS HAS BEEN PERFORMED ON THE EXISTING SITE. REFER TO PROJECT MANUAL.
- (B) IF THIS PROJECT CONTAINS HAZARDOUS MATERIALS, CONTRACTOR TO PROVIDE WORK REQUIRED FOR PROPER REMOVAL, HANDLING, AND DISPOSAL PER ENVIRONMENTAL ANALYSIS RECOMMENDATIONS.

Buddy Webb, NCARB, AIA
Architect - Consultant
3057 EAST CAIRO
SPRINGFIELD, MISSOURI 65802
(417) 877-1385 TELEPHONE
(417) 877-9786 FAX

SYMBOLS LEGEND

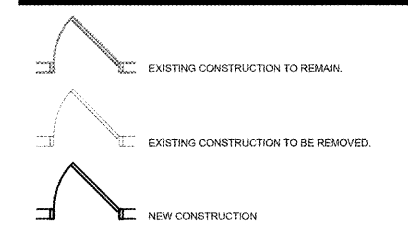

DRAWN BY: **EW** CHECKED BY: **RV**
DATE: **04/26/18**
REVISION:
PROJECT NUMBER: **PEA-0994**
SHEET NUMBER: **D2.1**

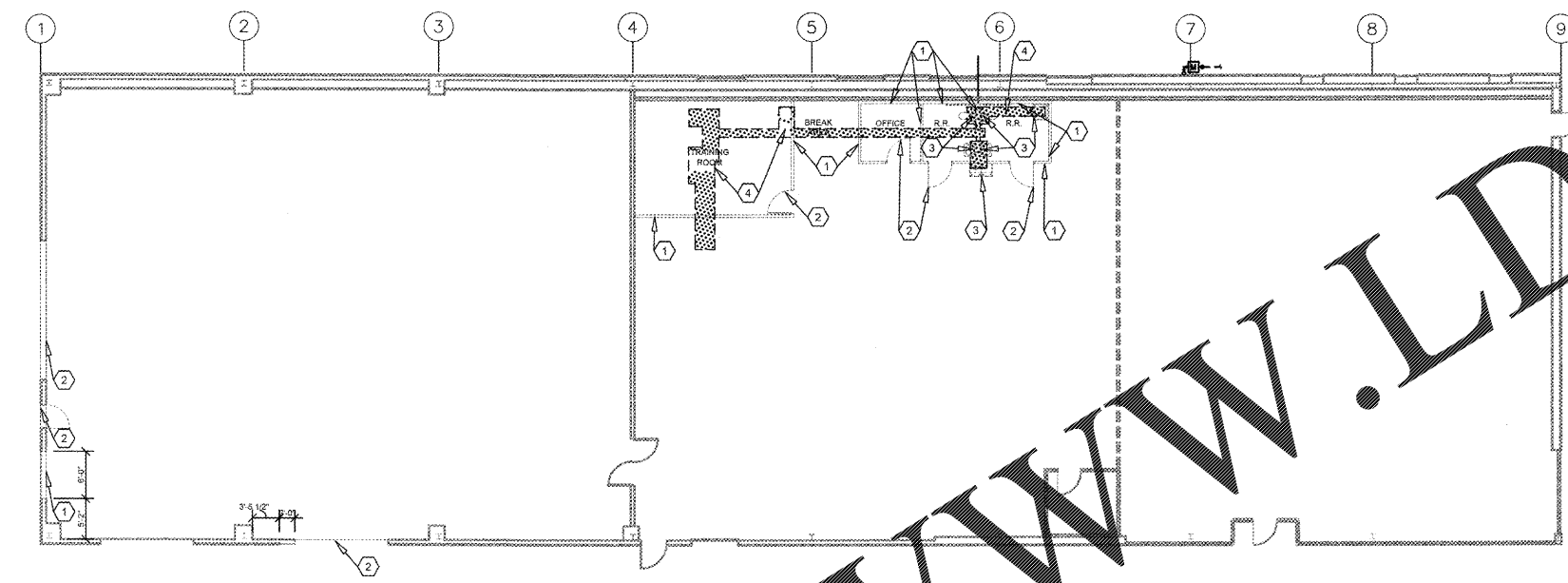

1 DEMOLITION FLOOR PLAN
D2.1 SCALE: 3/32" = 1'-0"

Order Plans @ www.LDILiving.com

COPYRIGHT 2018. DESIGNS, DRAWINGS AND SPECIFICATIONS ARE INSTRUMENTS OF SERVICE AND ARE THE PROPERTY OF THE DESIGN PROFESSIONAL. REPRODUCTION PROHIBITED WITHOUT THE EXPRESSED WRITTEN CONSENT OF THE DESIGN PROFESSIONAL.