

GENERAL NOTES

- A REFER TO PROJECT MANUAL AND SCOPE OF WORK SCHEDULE FOR ADDITIONAL REQUIREMENTS.
- B SITE DIMENSIONS TO FACE OF CONCRETE FOUNDATION, SIDEWALK CURB GUTTER LINE, PROPERTY LINE, OR CENTER LINE OF STRIP, UNLESS OTHERWISE NOTED.
- C COORDINATE WORK WITH OTHER SITE RELATED DEVELOPMENT DRAWINGS.
- D PRIOR TO INSTALLATION, CONTRACTOR TO VERIFY LOCATIONS OF LIGHT POLES, LANDSCAPING, AND UTILITIES DO NOT CONFLICT WITH SITE SIGN LOCATION SHOW HEREON. VERIFY WITH UTILITY LOCATIONS. IF CONFLICT IS DISCOVERED, CONTRACTOR TO NOTIFY OWNER'S REPRESENTATIVE PRIOR TO PROCEEDING WITH THE WORK.
- E "COMING SOON" TEMPORARY CONSTRUCTION SIGN TO BE PROVIDED BY CONTRACTOR. ALL SIGNAGE GRAPHICS TO BE OWNERS FURNISHED AND CONTRACTOR INSTALLED. LOCATE TEMPORARY CONSTRUCTION SIGN ON SITE SO AS TO BE VISIBLE TO PUBLIC FROM RIGHT-OF-WAY. REFER TO DETAIL 1/SG1.2.

PROVIDE LANDSCAPING TO MAINTAIN AND OBSCURING VISIBILITY OF SITE SIGN FROM RIGHT OF WAY WITH LARGE PLANTINGS AND LANDSCAPING. SUBMIT LANDSCAPING LAYOUT FOR FINAL OWNER REVIEW AND APPROVAL PRIOR TO INSTALLATION.

KEY NOTES

- 1 SITE SIGN, TO BE REFACED.

INDIVIDUAL ARCHITECTURAL REGISTRATION NO.: 3458



O'Reilly Auto Parts
CORPORATE OFFICES
233 SOUTH PATTERSON
SPRINGFIELD, MISSOURI 65802
(417) 862-2674 TELEPHONE

PROJECT: (ADDITION)
O'REILLY AUTO PARTS STORE
2730 HIGHWAY 80 EAST
PEARL, MISSISSIPPI

Buddy Webb, NCARB, AIA
Architect - Consultant
3057 EAST CAIRO
SPRINGFIELD, MISSOURI 65802
(417) 877-1385 TELEPHONE
(417) 877-8736 FAX



DRAWN BY: EW
CHECKED BY: RV

DATE: 04/26/18
REVISION:

PROJECT NUMBER: PEA-0994

SHEET NUMBER: **SG1.1**

CAUTION: INFORMATION ON THIS DRAWING CONCERNING TYPE AND LOCATION OF UNDERGROUND AND OTHER UTILITIES IS NOT GUARANTEED TO BE ACCURATE OR ALL INCLUSIVE. THE CONTRACTOR IS RESPONSIBLE FOR MAKING HIS OWN DETERMINATION AS TO THE TYPE AND LOCATION OF UNDERGROUND AND OTHER UTILITIES AS MAY BE NECESSARY TO AVOID DAMAGE THERETO.

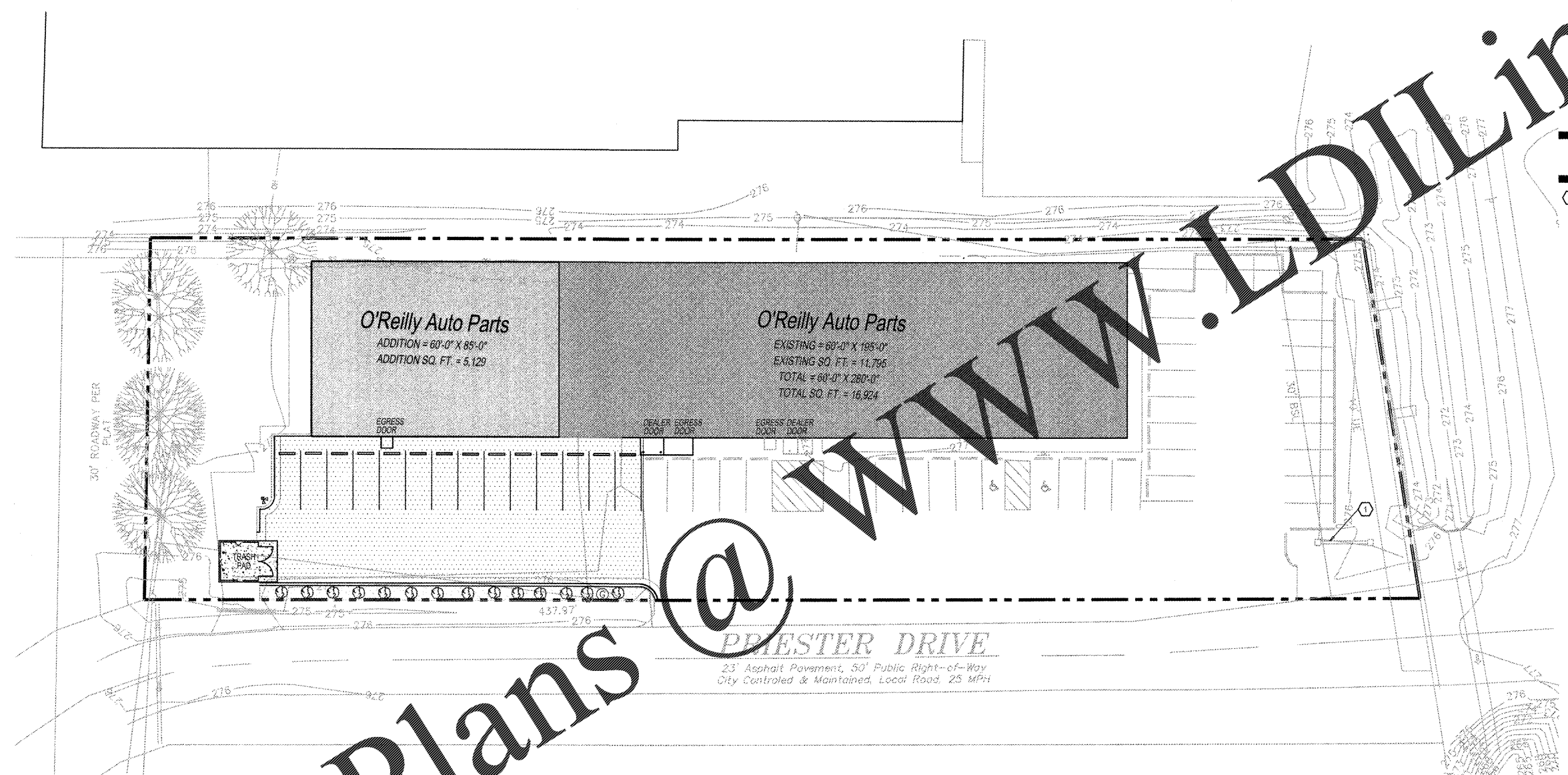

Order Plans @ WWW.LDILLING.COM

1 SITE SIGNAGE PLAN
SQ1.1 SCALE: 1" = 20'-0"

REPRODUCTION PROHIBITED WITHOUT THE EXPRESSED WRITTEN CONSENT OF THE DESIGN PROFESSIONAL. COPYRIGHT 2018