

INDIVIDUAL ARCHITECTURAL  
REGISTRATION NO. 3456

**Buddy Webb**  
ARCHITECT  
3057 EAST CAIRO  
SPRINGFIELD, MISSOURI 65802  
(417) 877-1986

SHEETS BEARING THIS SEAL ARE  
AUTHENTICATED. RESPONSIBILITY FOR  
ALL OTHER PLANS, SPECIFICATIONS  
OR INSTRUMENTS ARE DISCLAIMED.

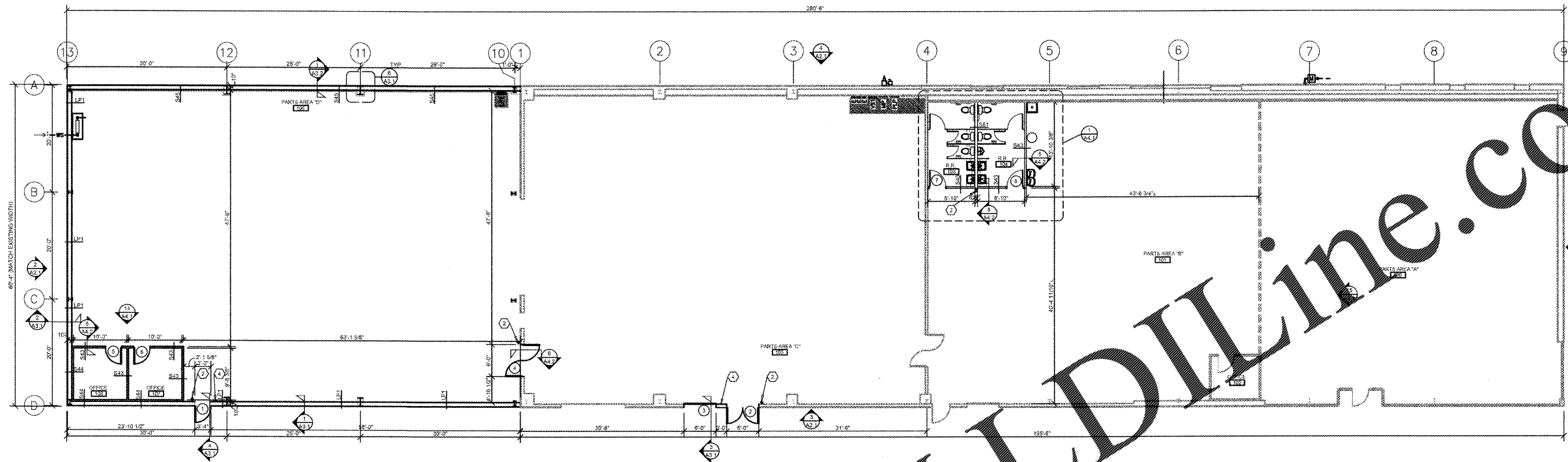

**1 FLOOR PLAN**  
A1.1 SCALE: 3/32" = 1'-0"

**Reilly AUTO PARTS**  
CORPORATE OFFICES  
233 SOUTH PATTERSON  
SPRINGFIELD, MISSOURI 65802  
(417) 862-2674 TELEPHONE

PROJECT: (ADDITION)  
**O'REILLY AUTO PARTS STORE**  
2730 HIGHWAY 80 EAST  
PEARL, MISSISSIPPI

**Buddy Webb, NCARB, AIA**  
**Architect - Consultant**  
3057 EAST CAIRO  
SPRINGFIELD, MISSOURI 65802  
(417) 877-1986 TELEPHONE  
(417) 877-9736 FAX

DRAWN BY: **EW** CHECKED BY: **RV**  
DATE: **04/26/18**  
REVISION:  
PROJECT NUMBER: **PEA-0994**  
SHEET NUMBER

**A1.1**

**GENERAL NOTES**

- (A) REFER TO PROJECT MANUAL FOR ADDITIONAL REQUIREMENTS.
- (B) ALL DIMENSIONS TO ROUGH FACE OF ROUGH FRAMING, CONCRETE, MASONRY OR CENTERLINE OF STRUCTURE, UNLESS OTHERWISE NOTED. COLD FORM METAL STUD INTERIOR PARTITION DIMENSIONS 3-5/8" UNLESS OTHERWISE INDICATED AND NOT SHOWN FOR CLARITY.
- (C) REFER TO EXTERIOR AND INTERIOR FINISH SCHEDULES FOR ADDITIONAL REQUIREMENTS.
- (D) REFER TO PRE-ENGINEERED METAL BUILDING SHOP DRAWINGS FOR ADDITIONAL REQUIREMENTS. NOTIFY ARCHITECT IF FINAL DESIGN CONDITIONS DEVIATE SUBSTANTIALLY FROM THOSE INDICATED HEREIN.

**KEY NOTES**

- (1) NEW WALL CONSTRUCTION - PATCH & REPAIR AS REQUIRED - TO MATCH EXISTING.
- (2) SURFACE MOUNTED PORTABLE FIRE EXTINGUISHER, REFER TO DETAIL 10/A4.2.
- (3) PROVIDE NEW P.E.M.B. JAMB AND HEAD SEE SECTIONS TO MATCH EXISTING WALL WIDTH WITH NEW SHEET METAL CLOSURE TRIM TO MATCH EXISTING WALL CONSTRUCTION. OPENING HEIGHT TO BE 7'-2".
- (4) TACTILE EXIT SIGN AT EXIT DISCHARGE DOOR STATING "EXIT" WITH BRAILLE LETTERING. SIGN TYPE TO COMPLY WITH ANSI A117.1 AND MOUNTED AT 6'-0" A.F.F. TO CENTERLINE.

**INTERIOR WALL & CEILING NOTES**

- 1. GENERAL:  
A. REFER TO FINISH SCHEDULES FOR ADDITIONAL WALL FINISH MATERIAL APPLICATIONS.
- B. REFER TO WALL SECTIONS AND DETAILS FOR ADDITIONAL CONDITIONS.
- 2. FRAMING:  
A. PROVIDE FIRE TREATED 2X BLOCKING AS REQUIRED FOR INSTALLATION OF ACCESSORIES PER MANUFACTURER'S RECOMMENDATIONS.
- B. PROVIDE DIAGONAL WALL BRACING (3" X 16 GA. FLAT STRIP) AT CORNER FACES OF FREE STANDING PARTITION SYSTEMS.
- C. WHERE WALL FRAMING EXTENDS TO BOTTOM OF ROOF DECK OR STRUCTURE, PROVIDE DEFLECTION CHANNELS AT TOP TRACK FOR 1 1/2" MINIMUM DEFLECTION.
- D. REFER TO STRUCTURAL DRAWINGS FOR STRUCTURAL STUD REQUIREMENTS.
- E. REFER TO WINDOW AND DOOR HEAD, JAMB AND SILL DETAILS FOR ADDITIONAL FRAMING REQUIREMENTS.
- F. PROVIDE HORIZONTAL STUD BRIDGING AT 4'-0" O.C. VERTICAL.
- 3. GYPSUM AND BACKING BOARD:  
A. EXPANSION/CONTROL JOINTS: INSTALL EXPANSION/CONTROL JOINTS IN CEILINGS EXCEEDING 2500 SQ. FT. IN AREA AND IN PARTITION WALL LENGTHS EXCEEDING 30 FEET. DO NOT EXCEED A DISTANCE OF 50 FEET IN ANY DIRECTION BETWEEN CEILING JOINTS. INSTALL CONTROL JOINTS WHERE FRAMING OR FURRING CHANGES DIRECTION.
- B. PROVIDE MOISTURE RESISTANT TYPE "X" GYPSUM BOARD AT ALL WET LOCATIONS (RESTROOMS, WET WALLS, AND JANITOR'S SINK AREAS).
- C. PROVIDE "J" MOLDING, REGLETS, OR CORNER BEAD AT GYPSUM BOARD PERIMETER CONDITIONS TRANSITIONING TO DISSIMILAR EXPOSED FINISH MATERIALS.
- 4. INSULATION:  
A. INSULATION SHALL HAVE A FLAME SPREAD RATING OF 0-25 AND A SMOKE DEVELOPMENT RATING OF 0-450.
- B. PROVIDE SEALANT ON BOTH SIDES OF STUD BOTTOM TRACKS AT ACOUSTICAL INSULATED WALL LOCATIONS.
- 5. FIRE STOPPING:  
A. PROVIDE FIRE STOPPING AND FIRE SEALANT MATERIALS AS REQUIRED AT ALL FIRE RATED ASSEMBLY TRANSITIONS, PENETRATIONS, AND PERIMETER CONDITIONS. RATING TO BE EQUAL TO RATED ASSEMBLY.

**INTERIOR WALL TYPES**

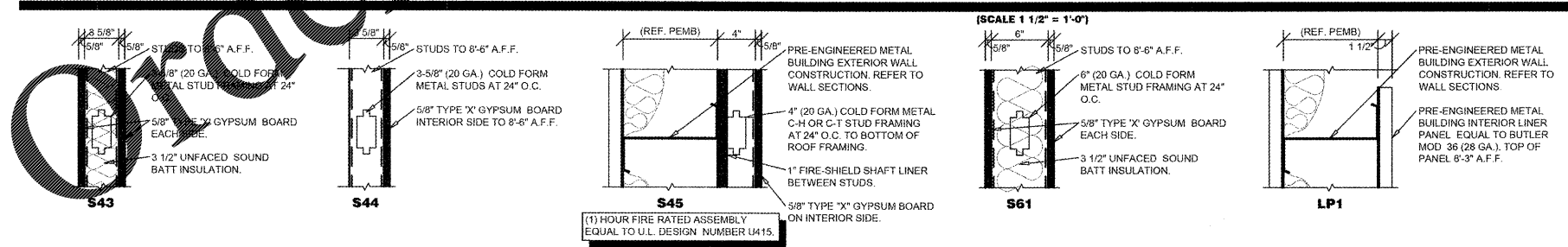

Order Plans @ www.LDILine.com

REPRODUCTION PROHIBITED WITHOUT THE EXPRESSED WRITTEN CONSENT OF THE DESIGN PROFESSIONAL. DRAWINGS AND SPECIFICATIONS ARE INSTRUMENTS OF SERVICE AND ARE THE PROPERTY OF THE DESIGN PROFESSIONAL.