

GENERAL NOTES

- (A) REFER TO PROJECT MANUAL FOR ADDITIONAL REQUIREMENTS.
- (B) SITE CONDITIONS BASED UPON SURVEY PROVIDED BY OWNER. CONTRACTOR TO FIELD VERIFY EXISTING CONDITIONS BY DETAILED INSPECTION PRIOR TO SUBMITTING BID AND BEGINNING CONSTRUCTION. NOTIFY ARCHITECT IF EXISTING CONDITIONS DEVIATE SUBSTANTIALLY FROM THOSE INDICATED HEREIN.
- (C) REFER TO CIVIL DRAWINGS FOR ADDITIONAL REQUIREMENTS. COORDINATE WORK WITH OTHER SITE RELATED DEVELOPMENT DRAWINGS.
- (D) ALL PLANTING TYPES SHALL COMPLY WITH LOCAL GOVERNING CODES AND REGULATIONS. CONSULT THE REQUIREMENTS OF PLANT LIST AND TO THE AMERICAN ASSOCIATION OF NURSERYMEN "AMERICAN STANDARD OF NURSERY STOCK AND CULTURAL STANDARDS" AS TO SPECIES, SIZE, AND PLANTING RECOMMENDATIONS.
- (E) NO MATERIAL SUBSTITUTIONS SHALL BE MADE WITHOUT THE ARCHITECT'S PRIOR WRITTEN APPROVAL. ALTERNATE MATERIALS OF SIMILAR SIZE AND CHARACTER MAY BE CONSIDERED IF SPECIFIED PLANT MATERIAL CANNOT BE OBTAINED.
- (F) PLANT QUANTITIES ARE APPROXIMATE. ADJUST AS NECESSARY TO MATCH CONDITIONS IN THE FIELD.
- (G) QUANTITIES OF MATERIALS SHOWN ON LANDSCAPING PLAN TAKE PRECEDENCE OVER QUANTITIES SHOWN ON PLANTING SCHEDULE. CONTRACTOR SHALL BE RESPONSIBLE FOR VERIFYING ALL QUANTITIES ON LANDSCAPING PLAN.
- (H) PROVIDE 4" TOPSOIL AT ALL SOD, SEED AND PLANTING AREAS. GRADE SHALL BE ADJUSTED FOR SOD THICKNESS. REFER TO CIVIL SITE GRADING PLAN FOR SLOPE REQUIREMENTS.
- (I) WHEN CLAY SOIL IS ENCOUNTERED IN THE ESTABLISHED AREA OF THE LAWN OR THE INSTALLATION OF PLANT MATERIAL IT SHALL BE IMPROVED IN ACCORDANCE WITH STANDARD TRADE PRACTICE.
- (J) RE-ESTABLISH TURF IN AREAS DISTURBED BY GRADING OR UTILITY TRENCHING IN THE RIGHT-OF-WAY.
- (K) PRIOR TO INSTALLATION, GENERAL CONTRACTOR TO CONFIRM THAT LIGHT POLES, LANDSCAPING AND UTILITIES DO NOT CONFLICT WITH SIGN LOCATION SHOWN. IF ANY POTENTIAL CONFLICT IS DISCOVERED, GENERAL CONTRACTOR IS TO CONTACT OWNER'S REPRESENTATIVE BEFORE PROCEEDING WITH THE WORK.

KEY NOTES

- 1 AREA OF HYDRO MULCH OR SEED AND STRAW. UNLESS NOTED OTHERWISE, ALL AREAS DISTURBED BY CONSTRUCTION ARE FIRST TO BE FINE GRADED AND THEN FOLLOWED BY HYDRO MULCH OR SEED AND STRAW OVER MIN. 4" TOPSOIL STOCKPILED FROM SITE OR HAULED IN AS REQUIRED.
- 2 AREA OF SOD, REFER TO DETAIL 1/L1.2.
- 3 CREEK GRAVEL, REFER TO DETAIL 2/L1.2.
- 4 LANDSCAPE EDGING, REFER TO DETAIL 2/L1.2. PROVIDE AT ALL GROUND COVER TYPE TRANSITIONS.

SYMBOLS LEGEND

NOTE: REFER TO SURVEY SHEET FOR SYMBOLS LEGEND OF EXISTING CONDITIONS.

- 1,025 S.F. AREA OF SOD OR MULCH IN SQUARE FEET
- NEW AREA OF LANDSCAPE GRAVEL
- NEW AREA OF SOD
- SHRUB PLANTING
- UNDER STORY TREE
- CANOPY TREE

CAUTION:
INFORMATION ON THIS DRAWING CONCERNING TYPE AND LOCATION OF UNDERGROUND AND OTHER UTILITIES IS NOT GUARANTEED TO BE ACCURATE OR ALL INCLUSIVE. THE CONTRACTOR IS RESPONSIBLE FOR MAKING HIS OWN DETERMINATION AS TO THE TYPE AND LOCATION OF UNDERGROUND AND OTHER UTILITIES AS MAY BE NECESSARY TO AVOID DAMAGE THERETO.

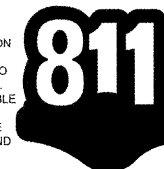

Know what's below
Call before you dig.

PROJECT: (ADDITION)
O'Reilly Auto Parts Store
2730 HIGHWAY 80 EAST
PEARL, MISSISSIPPI

Buddy Webb, NCARB, AIA
Architect - Consultant
3057 EAST CAIRO
SPRINGFIELD, MISSOURI 65802
(417) 877-1385 TELEPHONE
(417) 877-9736 FAX

DRAWN BY: **EW** CHECKED BY: **RV**
DATE: **04/26/18**
REVISION:
PROJECT NUMBER:
PEA-0994
SHEET NUMBER

L1.1

REPRODUCTION PROHIBITED WITHOUT THE EXPRESSED WRITTEN CONSENT OF THE DESIGN PROFESSIONAL. COPYRIGHT 2018 BY B.W. DESIGN, DRAWINGS AND SPECIFICATIONS ARE INSTRUMENTS OF SERVICE AND ARE THE PROPERTY OF THE DESIGN PROFESSIONAL.

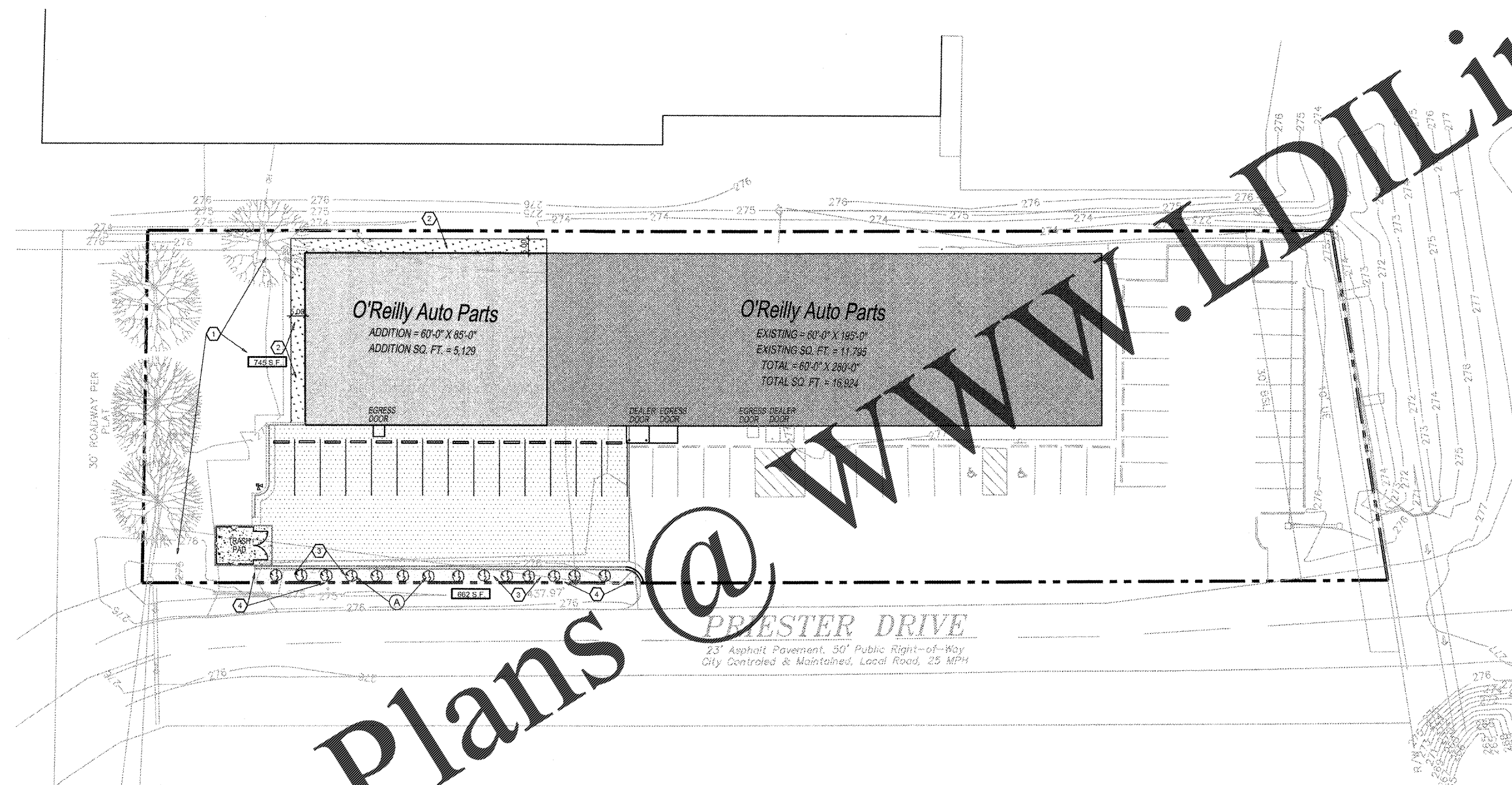

PLANTING SCHEDULE						
REFER TO PROJECT MANUAL FOR ADDITIONAL REQUIREMENTS ALL PLANTINGS MAY BE SUBSTITUTED DUE TO REGION OR LOCAL REQUIREMENTS IF NECESSARY						
MARK	COMMON NAME	BOTANICAL NAME	QUANTITY	SIZE	DETAIL	NOTES
(A)	LITTLE LEAF BOXWOOD	BUXUS MICROPHYLLA	14	2' HEIGHT MIN.	4/L1.2	FULL PLANT

Order Plans @ WWW.L1DILLING.COM

1 LANDSCAPE PLAN
L1.1 SCALE: 1" = 20'-0"