

ELEVATOR SPECIAL NOTES

- ELECTRICAL WORK FOR ELEVATOR SHALL BE IN STRICT COMPLIANCE WITH INSTRUCTIONS FROM ELEVATOR CONTRACTOR AND AUTHORITY HAVING JURISDICTION. SEE ELEVATOR SHOP DRAWINGS.
- ELECTRICAL CONTRACTOR SHALL MAKE FINAL CONNECTIONS TO ELEVATOR EQUIPMENT.
- ELEVATOR DISCONNECTS SHALL BE CAPABLE OF BEING LOCKED IN THE OPEN POSITION.

PROJECT SPECIAL NOTES

- NO CONDUIT SHALL BE INSTALLED IN ANY FLOOR SLAB THAT IS NOT ON GRADE. NO EXCEPTIONS. CONDUIT SHALL BE INSTALLED OVERHEAD OR ROUTED THROUGH THE SLAB AND INSTALLED ABOVE THE CEILING OF THE LEVEL BELOW.

POWER PLAN NOTES

- CONTRACTOR SHALL BE RESPONSIBLE FOR DETERMINING NUMBER OF CONDUCTORS IN BRANCH CIRCUITS AND SWITCH LEGS.
- SEE SHEET E2.01 FOR POWER PLAN KEYNOTES.

ROBERTSON ROOF ARCHITECTS ENGINEERS
 3458 Parkside Ridge, Marietta, GA 30065
 770.474.3000 / www.robertsonroof.com



Dawson County College and Career Academy
 Dawsonville, Georgia
 Dawson County Schools
 Overall Squarefootage = 35,800 SF
 PFE = 1025
 (Utility No. 642-0198)

REVISIONS

NO.	DESCRIPTION

DATE: 04-24-2018
 PROJECT NUMBER: 17-303
 SHEET NUMBER: E2.02
 POWER PLAN - UPPER LEVEL

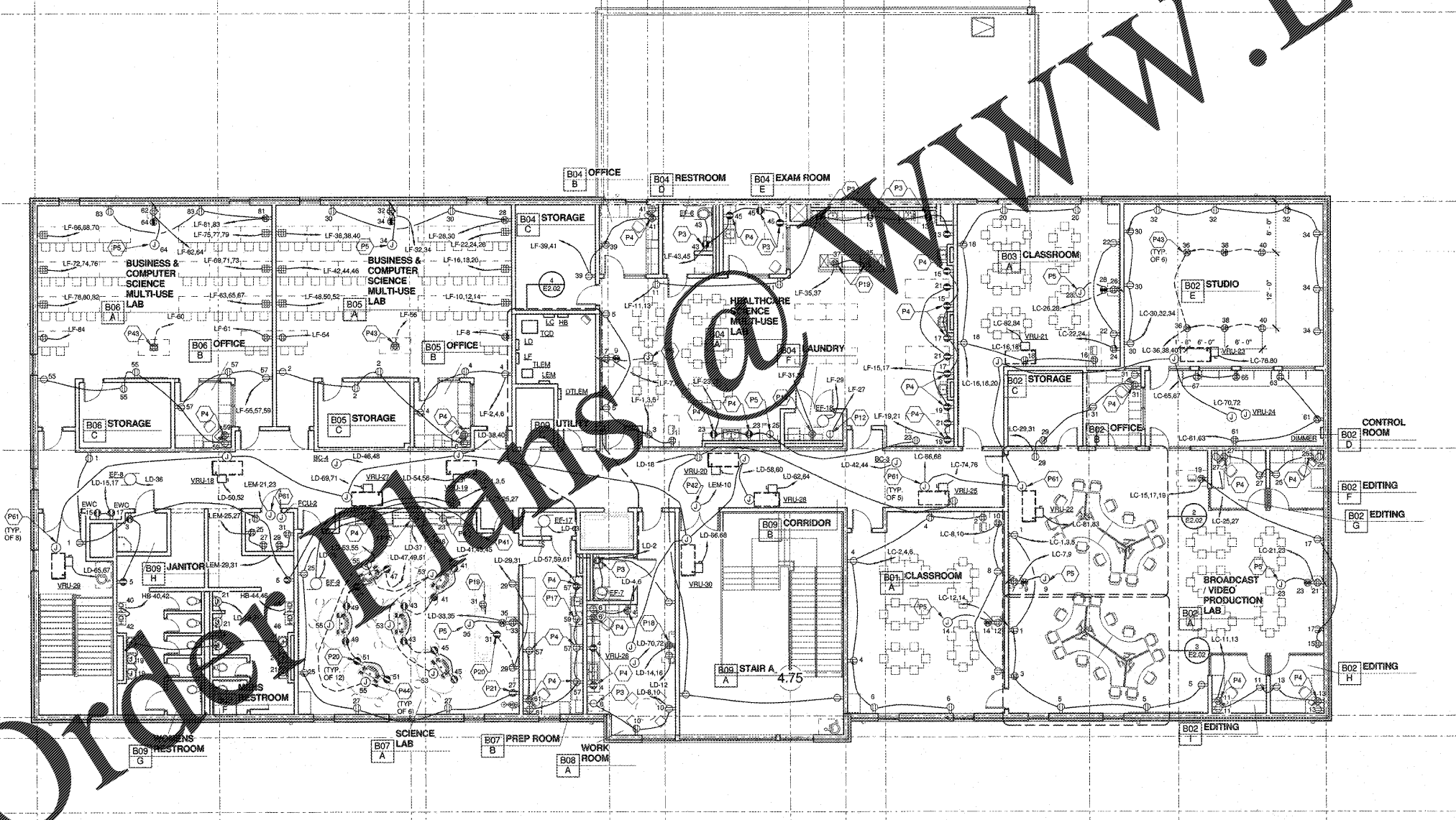
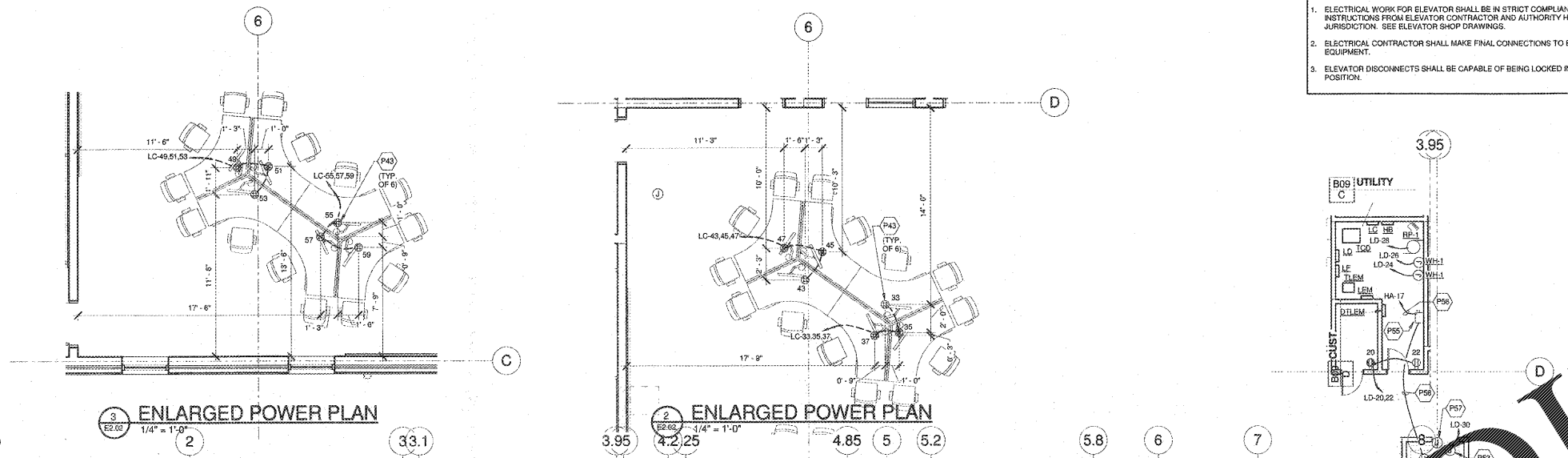

1 POWER PLAN - UPPER LEVEL
 1/8" = 1'-0"

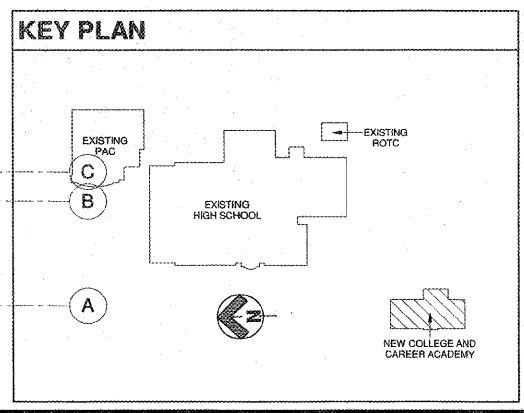

Order Plans @ WWW.LDLine.com