



FINISH PLAN LEGEND

NIC EQUIPMENT DEFINED WITH SCREENED PENWEIGHT FOR FINISHES

GENERAL NOTES

THE FINISHES DEFINED ON THIS DRAWING SHALL BE USED FOR BID PURPOSES ONLY. THE CONTRACTOR SHALL BE RESPONSIBLE FOR ACQUIRING AN UPDATED AND FINAL LIST OF FINISHES, CONTRACTOR TO ACQUIRE AN UPDATED AND FINAL LIST OF FINISHES FROM THE FINISH SCHEDULE FOR GENERAL FINISH EXTENTS. THE FINISHES DEFINED ON THIS SHEET TO BE USED IN CONJUNCTION WITH THE FINISH SCHEDULE.

REFER TO "EXTERIOR ELEVATIONS" FOR EXTERIOR FINISH EXTENTS. REFER TO "FLOOR PATTERN PLANS" FOR FLOOR PATTERN EXTENTS. REFER TO "CASEWORK ELEVATIONS" FOR GENERAL CASEWORK NOTES. ADDITIONAL WALL FINISHES DEFINED ON "INTERIOR ELEVATIONS" AND "CASEWORK ELEVATIONS".

SEE FINISH ABBREVIATION KEY ON "INTERIOR FINISH SCHEDULE" SHEET FOR A COMPLETE LIST OF FINISH ABBREVIATIONS AND THEIR DEFINITIONS.

FINISH COLORS DEFINED ON THIS SHEET TO BE USED IN CONJUNCTION WITH A PROJECT SPECIFIC "COLOR SCHEDULE" DOCUMENT. IF A FINISH COLOR IS NOT DEFINED ON THE "COLOR SCHEDULE" CONTRACTOR TO SUBMIT CHOSEN MANUFACTURER'S COLOR OPTIONS TO ARCHITECT FOR COLOR SELECTION PRIOR TO THE PURCHASE AND INSTALLATION OF FINISHES. CONTRACTOR TO COORDINATE FINISH COLORS, AS DEFINED IN "COLOR SCHEDULE" WITH CHOSEN MANUFACTURER'S COLOR OPTIONS. WHEN DISCREPANCIES OCCUR CONTRACTOR SHALL SUBMIT MANUFACTURER'S COLOR OPTIONS TO ARCHITECT FOR COLOR SELECTION.

PAINT FINISHES SHALL BE SEMI-GLOSS, UNLESS NOTED OTHERWISE. PROVIDE FLAT FINISH PAINT ON ALL GYPSUM BOARD CEILINGS, SOFFITS OR HEADERS, UNLESS NOTED OTHERWISE. CONTRACTOR TO PROVIDE UP TO 10 DIFFERENT INTERIOR PAINT G.W.C. COLORS (T.B.D.).

WALLS SHALL BE PAINTED PT-1, UNLESS NOTED OTHERWISE. GYPSUM BOARD CEILINGS SHALL BE PAINTED PT-2, UNLESS NOTED OTHERWISE. INTERIOR EXPOSED DUCTWORK, CONDUIT, ROOF DECK AND STRUCTURE SHALL BE PAINTED OF 2, PER SPECIFICATIONS, UNLESS NOTED OTHERWISE. HOLLOW METAL FRAMES SHALL BE PAINTED PT-3, UNLESS NOTED OTHERWISE. SEE "EXTERIOR ELEVATIONS" FOR EXTERIOR HOLLOW METAL FRAME COLOR DESIGNATIONS.

WHERE "OVERHEAD FINISH COLOR" IS INDICATED, COLOR DEFINED TO WRAP ALL EXPOSED SIDES OF OVERHEAD ELEMENT, UNLESS NOTED OTHERWISE. SEE DETAIL 1 OF STANDARD FINISH DETAILS, SHEET A7.0.

WOOD DOORS TO RECEIVE STAIN STN-1, UNLESS NOTED OTHERWISE. S. COORDINATE TACKBOARD AND MARKER BOARD INSTALLATION HEIGHT WITH OWNER, UNLESS NOTED OTHERWISE IN DRAWINGS. SEE RECOMMENDED INSTALLATION HEIGHTS PER SCHEDULE BELOW.

T. WHERE PORCELAIN FLOOR TILE (PCT) IS SCHEDULED, AREA TO RECEIVE PCT-1, UNLESS NOTED OTHERWISE.

U. WHERE CARPET TILE (CPT) IS SCHEDULED, AREA TO RECEIVE CPT-1, UNLESS NOTED OTHERWISE.

V. WHERE LUXURY VINYL TILE (LVT) IS SCHEDULED, AREA TO RECEIVE LVT-1, UNLESS NOTED OTHERWISE.

X. WHERE RUBBER FLOORING TILE (RUB) IS SCHEDULED, AREA TO RECEIVE RUB-1, UNLESS NOTED OTHERWISE.

Y. WHERE RESILIENT BASE (RB) IS SCHEDULED, AREA TO RECEIVE RB-1, UNLESS NOTED OTHERWISE.

Z. FLOORING TRANSITIONS TO OCCUR AT THE CENTER OF DOOR THRESHOLDS, UNLESS NOTED OTHERWISE. SEE FLOOR TRANSITION SCHEDULE ON "INTERIOR FINISH SCHEDULE" SHEET.

MARKER BOARD & TACKBOARD MOUNTING HEIGHT SCHEDULE

GRADE LEVEL	K-1	2	3	4	5	6	7	8-12
HEIGHT TO BOTTOM OF UNIT, A.F.F.	34"	25"	28"	27"	28"	25"	31"	33"

FLOOR PLAN SYMBOL LEGEND

SUITE DESIGNATION	M.B. MARKERBOARD LOCATION
ROOM NAME	T.B. TACKBOARD LOCATION
ROOM DESIGNATION	STR SHORT THROW PROJECT
INTERIOR ELEVATION	COMPUTER (NIC)
ENLARGED FINISH PLAN	NETWORK PRINTER (NIC)
DRAWING NOTE REFERENCE	REFRIGERATOR (NIC)
ATYPICAL FLOOR TRANSITION LOCATION - SEE "FLOOR TRANSITION SCHEDULE"	MICROWAVE (NIC)
FLOOR FINISH TYPE & COLOR DESIGNATION - SEE INTERIOR FINISH SCHEDULE SHEET FOR ABBREVIATION DEFINITIONS. SEE COLOR SCHEDULE FOR COLOR DESIGNATION	DISHWASHER (NIC)
WALL FINISH TYPE & COLOR DESIGNATION - SEE INTERIOR FINISH SCHEDULE SHEET FOR ABBREVIATION DEFINITIONS. SEE COLOR SCHEDULE FOR COLOR DESIGNATION	WASHER (NIC)
OVERHEAD ELEMENT FINISH TYPE & COLOR DESIGNATION - SEE INTERIOR FINISH SCHEDULE SHEET FOR ABBREVIATION DEFINITIONS. SEE COLOR SCHEDULE FOR COLOR DESIGNATION	DRYER - GE GTD485AJ OR APPROVED EQ.
	T.CAB TEACHERS CABINET - SEE CASEWORK NOTES

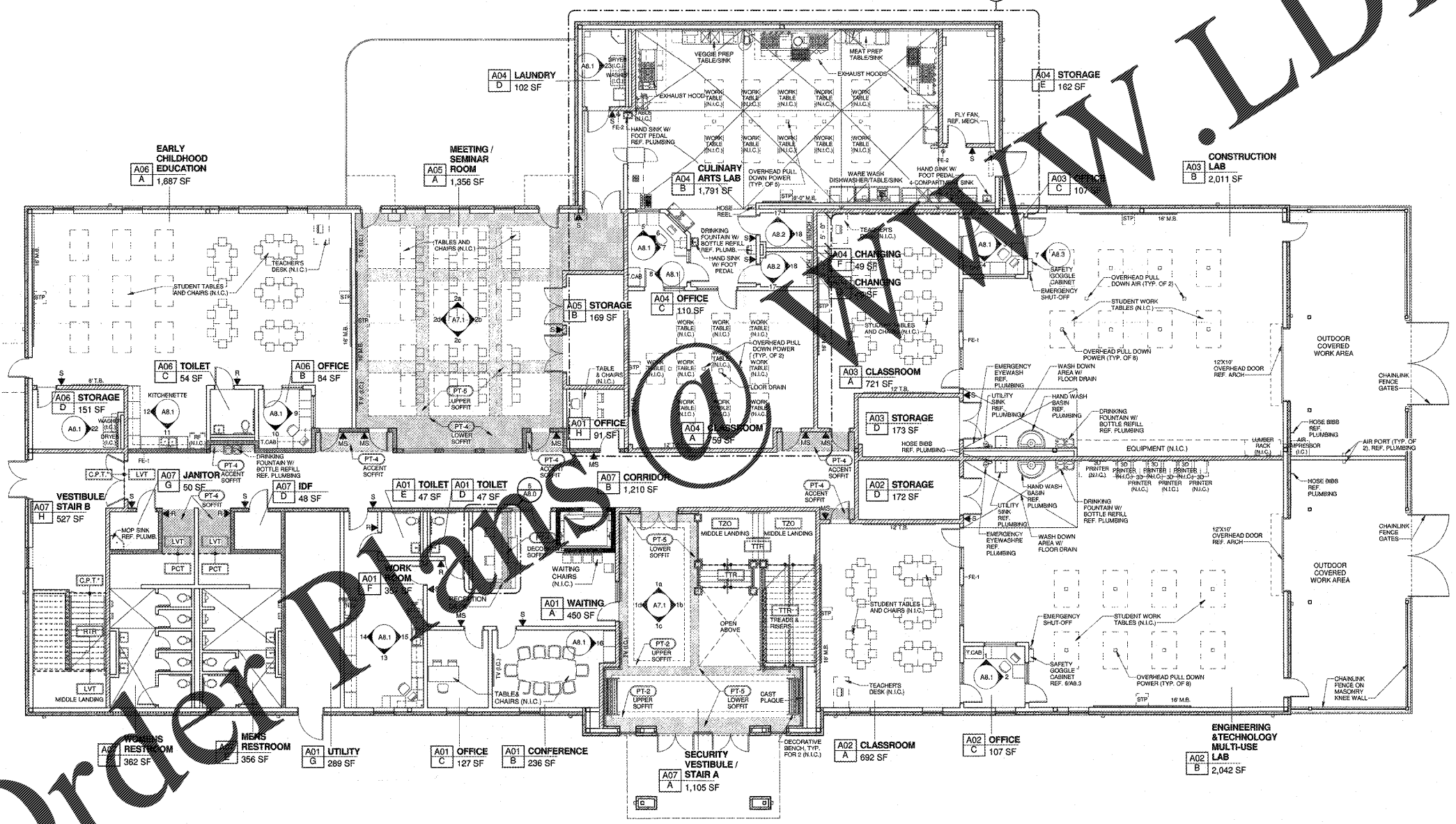
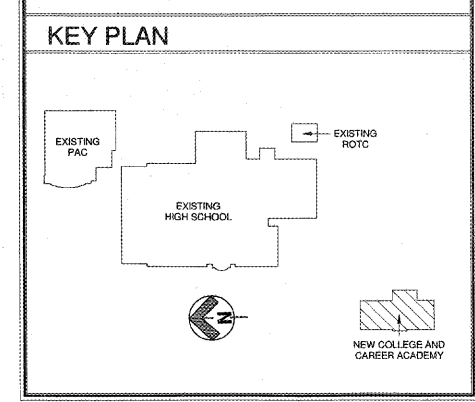

LOWER LEVEL FINISH PLAN

1/8" = 1'-0"

Order Plans