

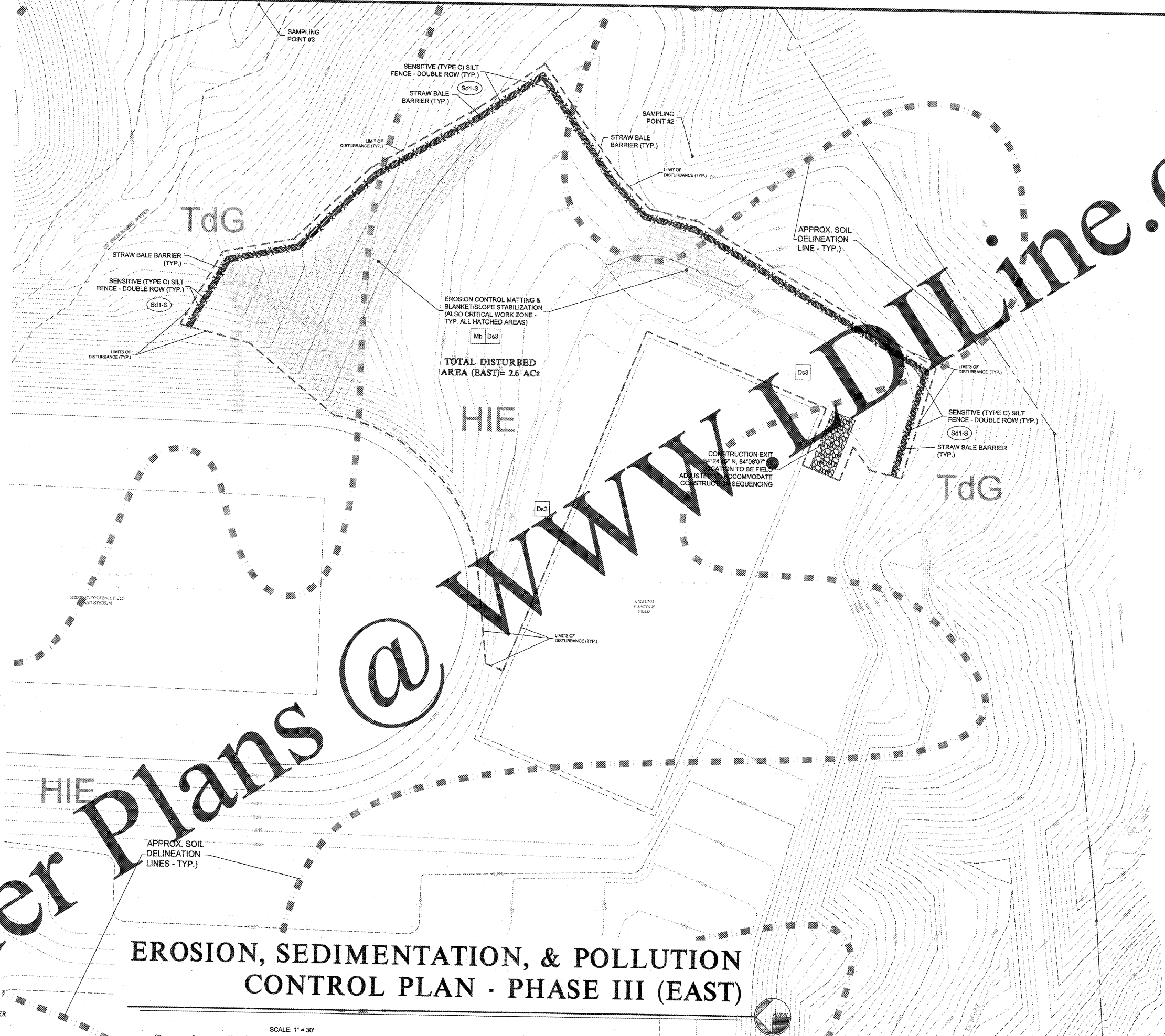

(Facility No. 642-0198)
Dawson County College and Career Academy
 Dawsonville, Georgia
 FOR: **Dawson County Schools**
 Overall Squarefootage = 35,800 SF
 ILS - 74 (Existing) + 11 (New) = 85 IL3

NO.	DATE	REVISIONS

EROSION, SEDIMENTATION, & POLLUTION CONTROL PLAN - PHASE III (EAST)
 DATE: 05-07-2018
 PROJECT NO: 17-303
 SHEET NO: C-4.3.1



EROSION, SEDIMENTATION, & POLLUTION CONTROL PLAN - PHASE III (EAST)

SCALE: 1" = 30'
 0 30 60 90 FEET

MATCH LINE (C-4.3.1)
 MATCH LINE (C-4.3)

MATCH LINE (C-4.3.1)
 MATCH LINE (C-4.3)

24 HR EMERGENCY CONTACT
 MR. C. MITT MORAN
 PHONE: 706-265-3244

IF YOU DIG GEORGIA...
 CALL US FIRST!
 UTILITIES PROTECTION CENTER
 IT'S THE LAW
 Call before you dig

Order Plans @ www.wdline.com