

SOIL TYPES

SOIL DESCRIPTIONS OBTAINED FROM A SOIL SURVEY OF DAWSON, LUMPKIN, AND WHITE COUNTIES, GEORGIA

MAP SYMBOL - DESCRIPTION - SLOPES

FBE2 - FANNIN SANDY CLAY LOAM, 10 TO 25 PERCENT SLOPES, ERODED.

HIB - HAYESVILLE SANDY LOAM, 2 TO 4 PERCENT SLOPES.

HIE - HAYESVILLE SANDY LOAM, 10 TO 25 PERCENT SLOPES.

TdG - TALLAPOOSA SOILS, 25 TO 70 PERCENT SLOPES.

CONTRACTOR SHALL NOTIFY ENGINEER BY WRITTEN EMAIL AND BY PHONE - (770) 574-2800 - WITHIN TWENTY-FOUR (24) HOURS AFTER INSTALLATION OF THE INITIAL SEDIMENT STORAGE REQUIREMENTS AND PERIMETER CONTROL BMPs.

STRUCTURAL PRACTICES

CODE	PRACTICE	DETAIL	MAP SYMBOL	DESCRIPTION
Co	CONSTRUCTION			CONSTRUCTION FROM THE LOCATION OF THE DISTURBED AREA TO THE PERIMETER ROAD SHALL BE LIMITED TO THE DISTURBED AREA AND SHALL BE LIMITED TO THE PERIMETER ROAD.
D	DRAINAGE			CONSTRUCTION SHALL BE LIMITED TO THE DISTURBED AREA AND SHALL BE LIMITED TO THE PERIMETER ROAD.
Sd1	SEDIMENTATION			CONSTRUCTION SHALL BE LIMITED TO THE DISTURBED AREA AND SHALL BE LIMITED TO THE PERIMETER ROAD.
Sd4	SEDIMENTATION			CONSTRUCTION SHALL BE LIMITED TO THE DISTURBED AREA AND SHALL BE LIMITED TO THE PERIMETER ROAD.
Tr	TR			CONSTRUCTION SHALL BE LIMITED TO THE DISTURBED AREA AND SHALL BE LIMITED TO THE PERIMETER ROAD.

VEGETATIVE MEASURES

CODE	DETAIL	SYMBOL	DESCRIPTION
D	DRAINAGE		CONSTRUCTION SHALL BE LIMITED TO THE DISTURBED AREA AND SHALL BE LIMITED TO THE PERIMETER ROAD.
Sd1	SEDIMENTATION		CONSTRUCTION SHALL BE LIMITED TO THE DISTURBED AREA AND SHALL BE LIMITED TO THE PERIMETER ROAD.
Sd4	SEDIMENTATION		CONSTRUCTION SHALL BE LIMITED TO THE DISTURBED AREA AND SHALL BE LIMITED TO THE PERIMETER ROAD.
Tr	TR		CONSTRUCTION SHALL BE LIMITED TO THE DISTURBED AREA AND SHALL BE LIMITED TO THE PERIMETER ROAD.

MULCH/ SEED RATES

CODE	PLANTING DATE	SPECIES	APPLICATION RATE
Ds1	APR 15 - JUN 15	NO ON ORY STRIPS	2" - 2"
Ds2	APR 15 - JUN 15	WOOD SHIP BONE MEAL	2" - 2"

THE FOLLOWING APPLICATION RATES ARE FOR EROSION CONTROL. PURPOSES ONLY. SEE LANDSCAPE PLAN FOR PERMANENT VEGETATION.

- PHASE I SCHEDULE**
- INSTALL TREE PROTECTION FENCES
 - INSTALL SILT FENCES & STRAW BALE BARRIER AT TOE OF EXISTING SLOPES
 - INSTALL CONSTRUCTION ENTRANCES
 - CONSTRUCT TEMPORARY SEDIMENTATION TRAPS
 - EXCAVATE TEMPORARY DIVERSION CHANNELS
 - START DEMOLITION, CLEARING, AND GRUBBING
 - START GRADING OPERATIONS
 - DUST CONTROL

ROBERTSON INDIA ROOF ARCHITECTS & ENGINEERS

3460 Preston Ridge Rd., Suite 275 - Marietta, GA 30065
770.474.1097 / www.rif.com



Dawson County College and Career Academy
Dawsonville, Georgia
Dawson County Schools
Overall Square Footage = 35,800 SF
FTE = 1025

REVISIONS

NO.	DATE	DESCRIPTION

EROSION, SEDIMENTATION, & POLLUTION CONTROL PLAN - PHASE I

DATE: 05-07-2018
PROJECT NUMBER: 17-303
C - 4.1

APPENDIX B, NTU TABLES

Nephelometric Turbidity Unit (NTU) TABLES

Cold Water (Treat Water)

NTU	10	20	30	40	50	60	70	80	90	100
10	10	20	30	40	50	60	70	80	90	100

Warm Water (Supporting Warm Water Fisheries)

NTU	10	20	30	40	50	60	70	80	90	100
10	10	20	30	40	50	60	70	80	90	100

To use these tables, the size (area) of the facility or structure, the NTU value, and the NTU value to use in Part II.C.4.

EROSION, SEDIMENTATION, & POLLUTION CONTROL PLAN - PHASE I

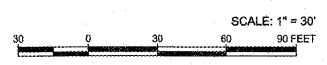

IF YOU DIG GEORGIA... CALL US FIRST! UTILITIES PROTECTION CENTER IT'S THE LAW. Know what's below. Call before you dig.

24 HR EMERGENCY CONTACT
Mr. SCOTT MORGAN
PHONE: 706-265-3246

Order Plans

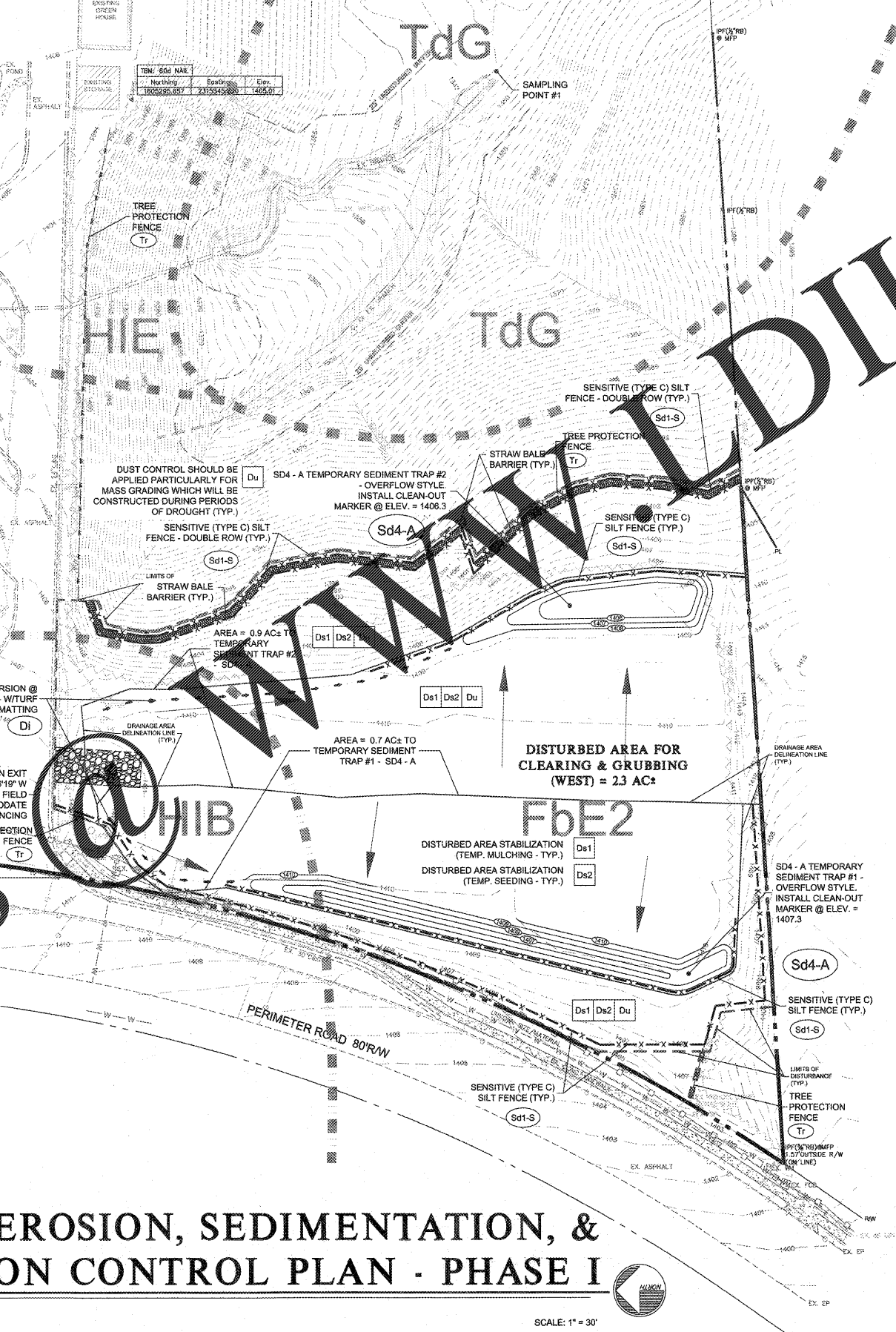

SEDIMENT TRAP VOLUME CALCULATIONS - Sd4-A-#1

Project Name: DAWSON COUNTY COLLEGE & CAREER ACADEMY
Date: 3/30/2018
By: S.Z.
Drainage Area: 0.70 AC

Elevation	Stage	(ft)	A _{up} (ft ²)	A _d (ft ²)	Slope Depth (ft)	Sub Volume (ft ³)	Cumulative Volume (ft ³)	Ac-ft
1407.0	0.0		830	630	0.0	0	0	0.00
1408.0	1.0		830	2,334	1.0	1,388	1,388	0.62
1409.0	2.0		2324	-1294	1.0	3,166	4,556	0.10

Required Wet Pool Volume (ETC/AC) = 1,292 ft³

Required Minimum Wet Pool Elevation = 1407.0 ft

Actual Provided Wet Pool Elevation = 1408.0 ft

Additional Required Dry Sediment Storage Above Wet Pool (ETC/AC) = 2,264 ft³

Dry Storage Elevation (1 Foot Max. Above Wet Pool) = 1408.4 ft

Cleanout Volume (200/AC) = 418 ft³

Cleanout Elevation = 1407.5 ft

SEDIMENT TRAP VOLUME CALCULATIONS - Sd4-A-#2

Project Name: DAWSON COUNTY COLLEGE & CAREER ACADEMY
Date: 3/30/2018
By: S.Z.
Drainage Area: 0.50 AC

Elevation	Stage	(ft)	A _{up} (ft ²)	A _d (ft ²)	Slope Depth (ft)	Sub Volume (ft ³)	Cumulative Volume (ft ³)	Ac-ft
1408.0	0.0		1,033	1,033	0.0	0	0	0.00
1407.0	1.0		1503	2,302	1.0	1,888	1,888	0.94
1408.0	2.0		2302	-1,264	1.0	2,193	4,081	0.11

Required Wet Pool Volume (ETC/AC) = 1,026 ft³

Required Minimum Wet Pool Elevation = 1407.0 ft

Actual Provided Wet Pool Elevation = 1407.0 ft

Additional Required Dry Sediment Storage Above Wet Pool (ETC/AC) = 1,826 ft³

Dry Storage Elevation (1 Foot Max. Above Wet Pool) = 1407.5 ft

Cleanout Volume (200/AC) = 535 ft³

Cleanout Elevation = 1408.3 ft