

EQUIPMENT SCHEDULE

TAG	QTY.	GENERAL EQUIPMENT INFORMATION		WATER		WASTE		PLUMBING				ELECTRICAL				REMARKS	
		DESCRIPTION		H.W.	C.W.	DIR.	IND.	REMARKS	VOLTS	PHASE	AMPS	CIRCUIT SIZE	SUPPLIED W/ PLUG	RECEPT. SPEC. (NEMA)	HEIGHT A.F.F.		
45	1	Rinse Sink - 18"W X 36"L with 12" Splash Guards		1/2"	1/2"	1-1/2"	-	SINK BOWL 10" X 14" X 10" DEEP									
50H	1	Cup Caddy															
82A	2	Bakery Rack 4 x 4															
96J	LOT	Espresso Syrup Rack															
96Q	1	Wirelab Speed Rail															
98	1	Schoerer Barista Espresso Machine		1/2"		1-1/2"			220	1	30	Y	L6-30R	46"			
101C	1	Dairy Dispenser							120	1	3	20				46" A.F.F. if located at Drive-thru coffee station	
101G	3	Speed Rail for Lids - 20"															
101H	1	Sugar/Tea Bag/Stirrer Holder - 13"															
101L	1	Sugar Shot Dispenser							120	1	5	20	Y			46" A.F.F. if located at Drive-thru coffee station	
101Q-3	1	Multi-Hopper Grinder and Storage System - Used with Axiom Brewer							120	1	11	20		5-15		Card with NEMA 5-15p Plug. 46" A.F.F. if located at Drive-thru coffee station	
102A	1	Flavor Shot 9 Pump Countertop Rack															
108A	1	Hot Winter Beverage Dispenser		N/A	1/2"	N/A	N/A	20-90 PSI. Supplied with 1/4" male flare fitting	120/208	1	21.7	30	Y	L14-30	46"		
116	1	Magnablander Island Oasis		N/A	1/2"	N/A	2"	Indirect Waste to Open Site Drain with Air Gap per Local Code 1/4" ID - 3/8" OD Quick Connect Hose/Fitting	120	1	5.3	20	Y	5-20	46"		One GFI outlet can serve each Island Oasis Machine
116E	1	Island Oasis Shelf Kit							120	1	0.8		Y	5-20			
116F	1	Island Oasis Mix-In Kit															
120F	1	Under Counter Refrigerator (Door Hinge per Plan)							115	1	5	20	Y	5-15	18"		
121F	1	Under Counter Refrigerator with 2 Drawers						1/4" ID - 3/8" OD Quick Connect Hose/Fitting	120	1	2.8		Y	5-15			
124A	2	Next Gen Double Soft Coffee Brewer		N/A	1/2"			20-90 PSI. Supplied with 1/4" male flare fitting	120/240	1	25		Y				
124B	4	Next Gen High Capacity Coffee Server															
171B	1	Drive Thru Staging Mat															
200A	1	Iced Coffee Brewer #C3-0BC W/ICDD		N/A	1/2"	N/A	N/A	20-90 PSI. Supplied with 3/8" OD male flare fitting	120/208	1	19.5	30	N	L14-30	46"		GC Shall provide 6' Card
201A	1	Ice Caddy															
215	2	TurboChef Oven							208	1	30	30	Y	6-30			See FS Sheets for Height to outlet
215I	1	TurboChef Oven Stand															
244	1	Dual Line Smart Toaster							208	1	23.8	30	Y	6-30			See FS Sheets for Height to outlet
245A-1	1	Defield 27" Toaster Station															
246A-1	1	12 Bay Holding Unit 33"W x 16"D x 16.5"H							120	1	15		Y	6-20			See FS Sheets for Height to outlet
247-1	1	33" Assembly Station											Y	5-15P			See FS Sheets for Height to outlet
249-1	1	18" Expeditor Station															
257	1	Tap System - Micromatic Back Bar Refrigerator							115	1	6.5		Y	5-15R			8' cord, 1/3 HP condenser
258	1	Nitrogen Generator							120		2						1/4 HP
261	1	Water Chiller				3/8"			115		3.5						1/5 HP compressor
395	2	Hand washing sink with side splashes. Can be used in front or back room.		1/2"	1/2"	1-1/2"		1-1/2"-2" Per local code									
402	2	Lockers															
409C	1	Ice Bins		N/A	N/A	N/A	3/4"	3/4" FPT Bin Drain									
413	1	Prodigy Ice Maker, Cube Style, air cooled, up to 800 lbs/24 hrs.					3/4"		208/230	1	10.2	15					61" Disconnected MA 3R/30A
420A-E	LOT	Shelf, 24" x 24", 24" x 36", 24" x 48", 24" x 48", 24" x 60", or 24" x 72"															
421A-L	LOT	Shelf, 18" x 36", 18" x 48", 18" x 48", 18" x 60", or 18" x 72"															
424A	1	90" x 23-3/4" three compartment sink. Bows 18"x18"x14"(2) 18" drain boards		3/4"	3/4"	2"	N/A	Direct/indirect waste as determined by local codes									
435A	1	90" Sink Trax Shelving Workstation.															
463A	1	Stainless Steel worktable (48" x 30") with backsplash, fixed SS under shelf and 12" Cantilevered over shelf															
541A-E	LOT	Bakery pan rack															
543	LOT	Bakery pan rack															
552B	1	Fresh Baked Double Convection Oven with Stand					3/4"	Provide pressure reducing valve, pressure gauge & shut-off valve at plumbing connection to oven	208	1	21.5	30	Y	L15-30	36"		2 Separate calls required per oven. Also requires (1) 120V/30W/1PI/15A NEMA 5-15 dedicated circuit
561	LOT	Finished Product Rack															
590C	1	High Efficiency RO System WITH softening (Hot Side) MRS-600HE II		3/4"	3/4"												

INSTALLATION NOTES:

- EQUIPMENT SUPPLIER TO PLACE ALL NEW EQUIPMENT
- GENERAL CONTRACTOR TO PLACE ALL EXISTING EQUIPMENT
- GENERAL CONTRACTOR TO MAKE ALL MECHANICAL, PLUMBING, AND ELECTRICAL CONNECTIONS FOR ALL EQUIPMENT
- THE ASTERISKS "*" IN THE "ITEM NO." INDICATES THAT THERE ARE MULTIPLE CHOICES AVAILABLE FOR THE RESPECTIVE PIECE OF EQUIPMENT OR MILLWORK.
- IT IS UP TO THE FRANCHISEE AND/OR FIELD TEAM TO MAKE THE APPROPRIATE SELECTION FOR THE LOCATION

NOTE:

REFER TO DUNKIN' BRANDS MULTIBRAND EQUIPMENT SPECIFICATIONS ON DUNKIN' BRANDS WEBSITE, <http://franchise.dunkinbrands.com> FOR COMPLETE EQUIPMENT AND UTILITY FORMS. DUNKIN' BRANDS WEB SITE ALWAYS TAKES PRECEDENCE OVER DRAWINGS IN INSTANCE OF CONFLICT.

Order Please

WWW.LD@

WALK-IN BOX SCHEDULE

BRAND:	DO
LOCATION OF WALK-IN BOX:	INTERIOR
CEILING & STRUCTURAL HEIGHT OF BOX LOCATION:	Ceiling Height: 10'-0" Structural Height: 15'-7"
OVERALL DIMENSIONS OF BOX:	7'-0" X 15'-0"
COOLER DIMENSIONS:	7'-0" X 7'-0"
FREEZER DIMENSIONS:	7'-0" X 8'-0"
ANTEROOM DIMENSIONS:	N/A
REFRIGERATION SYSTEM:	CAPSULE PACK
REFRIGERATION LOCATION:	TOP OF UNIT
REFRIGERATION LINESET NEEDED:	N/A
ELECTRICAL PHASE:	3- PHASE (208/230)
IF EXTERIOR:	
WILL BOX REQUIRE PAINTING ?	NO
WILL MASONRY SURROUND BOX ?	NO
OPTIONAL ACCESSORIES:	
PLASTIC STRIP CURTAIN AT DOORS	YES
INTERIOR RAMP	YES
EXTERIOR RAMP	NO
CASTORS FOR SHELVING	NO
HURRICANE TIE-DOWN	NO
SEISMIC TIE-DOWN	NO
DADE COUNTY SPEC'S	NO
MASONRY TIES ON EXT. OF BOX FOR BRICK	NO
INTERNAL BLOCKING FOR EXTERIOR FINISH	NO

DUNKIN BRANDS DATA

IMAGE TYPE:	SINGLE BRAND/ COMBO (DO-BD/BR)	DO
FLAVOR PALETTE:	NEXT GEN	
BUILDING TYPE:	IN-LINE	
STORE DIMENSIONS:		
RETAIL SERVICE AREA	480 S.F.	
SEATING/CUSTOMER AREA	404 S.F.	
KITCHEN PREP AREA	306 S.F.	
OFFICE	20 S.F.	
WALK-IN COOLER/FREEZER	105 S.F.	
RESTROOMS	61 S.F.	
TOTAL:	1,356 S.F.	
RESTROOMS:		
NUMBER OF RESTROOMS	1	
PUBLIC ACCESS TO RESTROOMS	YES	
HANDICAP ACCESSIBLE	YES	
DRIVE-THRU:		
NUMBER OF DRIVE THRU WINDOWS	1	
MENU BOARD SIZE	DO	
CAR LENGTHS FROM MENU TO WINDOW	5	
STACKING (TOTAL # OF VEHICLES)	9	
ESCAPE LANE	NO	
DRIVER THRU TIMER SYSTEM	BY DUNKIN DONUTS	
SEATING:		
# OF TABLES	2	0
# OF SEATS	6	0
# OF BARRIER FREE SEATING UNITS	1	0
STAND UP COUNTERS	NO	NO
SUB TOTAL NUMBER OF SEATS	6	0
TOTAL NUMBER OF SEATS	6	0

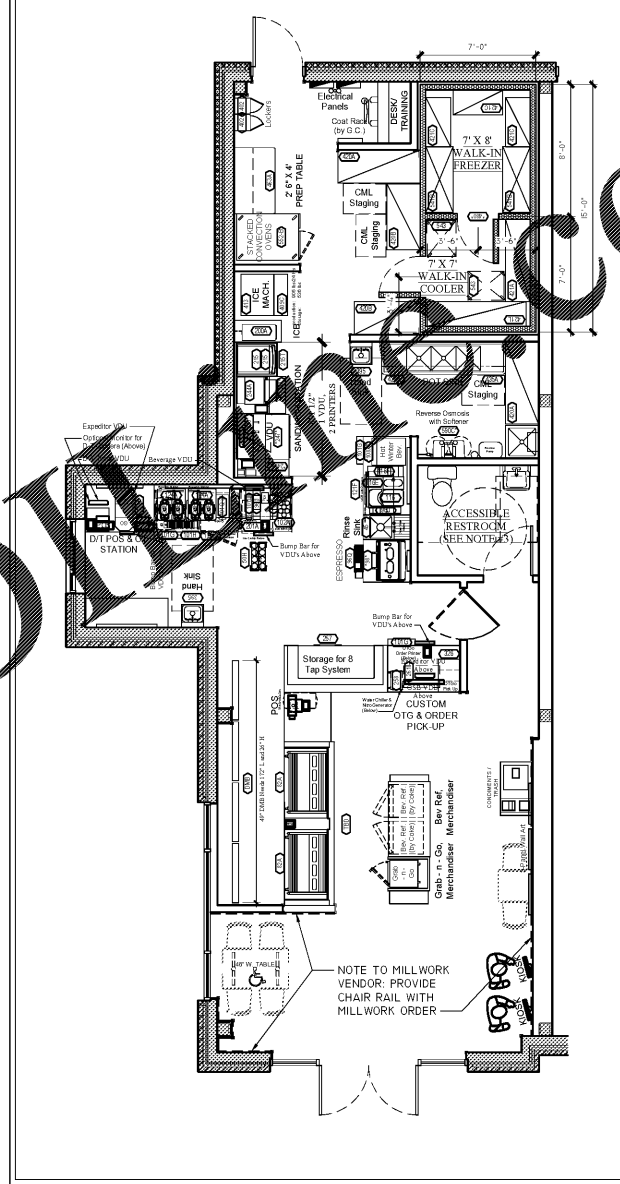

1 EQUIPMENT PLAN
3/16" = 1'-0" NOTE:

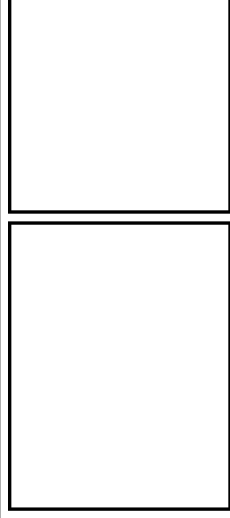

dunkin' brands.
STORE #357281
JEFFERSON DAVIS HWY
DUMFRIES, VA

REVISION		
No.	DATE	DESCRIPTION

DWG DATE: 06-29-2018
DRAWN BY: STAFF
PROJECT No.: 17157
DWG TITLE:

EQUIPMENT PLAN & SCHEDULE

SHEET No.
K-1