

POS-COMM. EQUIPMENT SCHEDULE		
KEY NOTE #	DESCRIPTION	LOCATION
POS EQUIPMENT		
1	POINT OF SALES (POS)	(1) DD FRONT COUNTER, (1) DT, (1) DT
1A	POINT OF SALES SELF-SERVE KIOSK (POS)	(2) CUSTOMER AREA
2	RECEIPT PRINTER	(1) DD FRONT COUNTER, (1) DT
3	PREP PRINTER	(1) BAKERY, (2) SANDWICH STATION, (1) ORDER PICK-UP
3A	CUP LABEL PREP PRINTER	(1) BEVERAGE STATION
4	VDU	(1) D/T POS, (1) ORDER PICK-UP, (1) SANDWICH STATION, (1) BEV. STATION
5	VDU CONTROLLER (PC BASED)	(1) D/T POS, (1) ORDER PICK-UP, (1) SANDWICH STATION, (1) BEV. STATION
6	POS NETWORK HUB / SWITCH	POS COUNTER FRONT CHASE
7	PC SITE CONTROLLER	OFFICE
8	PRINTER / FAX / COPIER (B.O.H.)	OFFICE
9	SCANNER	(1) DD FRONT COUNTER, (1) DT
10	PRICE CONFIRMATION DISPLAY	MOUNT UNDERSIDE OF DT WINDOW
12	CASH DRAWER	UNDER CTR-ALL POS EXCL. D.T. O.T.
X	ORDER STATUS BOARD	(1) ORDER PICK-UP
OTHER COMMUNICATIONS DEVICES		
15	DT TIMER CONSOLE	OFFICE
16	DT REMOTE DISPLAY	NEAR DT, VISIBLE TO ENTIRE SERVICE AREA
PHONE & DATA LINES		
18	DRIVE THRU CAMERA DISPLAY	NEAR DT, VISIBLE TO ENTIRE SERVICE AREA
20	FAX LINE	OFFICE
21	PHONE LINE	OFFICE
23	HIGH SPEED INTERNET (MNS)	OFFICE (COMPUTER LINE)
24	MARCH SYSTEMS SECURITY	SECURITY SYSTEM
25	DIGITAL MENUBOARD	OFFICE / MENUBOARD SOFFIT
26	BRAND APPROVED WIFI DSL/CABLE	OFFICE

GC SHALL PROVIDE POWER & DATA CONDUIT WITH PULL STRINGS TO ALL FUTURE POS / DRIVE THRU EQUIPMENT. CONDUIT SHALL TERMINATE AT JUNCTION BOX AT HEIGHT & LOCATION SHOWN ON ELECTRICAL PLANS. GC SHALL PROVIDE ALL COVER PLATES.

GENERAL POS NOTES:

- A. REFER TO [HTTP://EXTRANET.DUNKINBRANDS.COM](http://EXTRANET.DUNKINBRANDS.COM) FOR A LISTING OF APPROVED POS VENDORS BY CONCEPT.
 - B. FINAL POS DRAWINGS NEED TO BE PROVIDED TO POS VENDOR THAT IS SELECTED.
 - C. POS VENDORS REQUIRE DEDICATED ISOLATED GROUNDED (DIG) OUTLETS ON A 20 AMP CIRCUIT DEDICATED ONLY TO POS EQUIPMENT. 60HZ. 120V+-10%. ALL POS TERMINALS AND VIDEO DISPLAY DEVICES REQUIRE A DUPLEX OUTLET. THE BACK OFFICE CONTROLLER REQUIRES A QUAD OUTLET. THE NETWORK SWITCH REQUIRES A DUPLEX. IF FEDERAL, STATE, AND LOCAL WIRING CODES DO NOT MEET THIS REQUIREMENT, CONTACT THE POS VENDOR FOR INFORMATION ON ADDITIONAL EQUIPMENT THAT CAN BE PURCHASED TO MEET THIS REQUIREMENT. IF THIS REQUIREMENT IS NOT MET, THE POS SYSTEM WARRANTY IS INVALID.
 - D. ALL POWER INDICATED ON THIS PLAN MUST HAVE A THIRD WIRE, ISOLATED GROUND, AND BE TERMINATED WITHIN (4) FEET OF THE DEVICE.
 - E. I6-5362 RECEPTACLES MUST BE USED FOR ALL POS UNITS, VDU UNITS, AND SITE CONTROLLER UNIT (IN OFFICE). LABEL RECEPTACLES "POS".
 - F. LOW VOLTAGE WIRE IS REQUIRED TO BE CATEGORY 5. WIRE RUN IN 1/2" CONDUIT FOR POS EQUIPMENT ONLY, AND MUST BE TERMINATED WITH RING JACKS. ALL POS EQUIPMENT LINES TERMINATE AT THE FRONT COUNTER CHASE.
 - G. A 12" MINIMUM SEPARATION MUST BE MAINTAINED BETWEEN LOW VOLT WIRES AND POWER WIRING (TO AVOID ELECTRICAL INTERFERENCE).
 - H. BRAND REQUIREMENTS INDICATE THAT A MINIMUM OF THREE CONDUITS BE USED FOR DATA LINES BETWEEN OFFICE AND OTHER PARTS OF THE STORE- ONE CONDUIT IS TO BE DEDICATED TO POS WIRING, ONE FOR DIGITAL MENUBOARD DATA LINES, AND ANOTHER FOR NON-POS ITEMS (I.E. SECURITY CAMERAS, DT TIMER, HEAD SET WIRING).
 - I. EXACT # OF RECEPTACLES OR OFFICE EQUIPMENT LOCATED IN THE OFFICE PROJECT-BY-PROJECT BASIS IN TERMS OF EQUIPMENT LOCATED IN THE OFFICE.
 - J. ALL CEILING MOUNTED VDUS TO BE SUSPENDED FROM UNISTRUT BY THREADED ROD W/ WHITE PVC SLEEVE. CONNECT UNISTRUT TO ROOF THROUGHER. VDU BY POS VENDOR. UNISTRUT & THREADED ROD BY G.C. UNISTRUT SUPPORT MINIMUM 50 LB. WEIGHT.
- VDU MOUNTING HEIGHTS (TO BOTTOM OF MONITOR) ARE AS FOLLOWS:
 A. DRIVE THRU STATION - 68" A.F.F.
 B. DRIVE THRU - 61" A.F.F.
- DIGITAL MENUBOARD PREP WIRING:
 A. SEE MENU BOARD DATA NOTES THIS SHEET

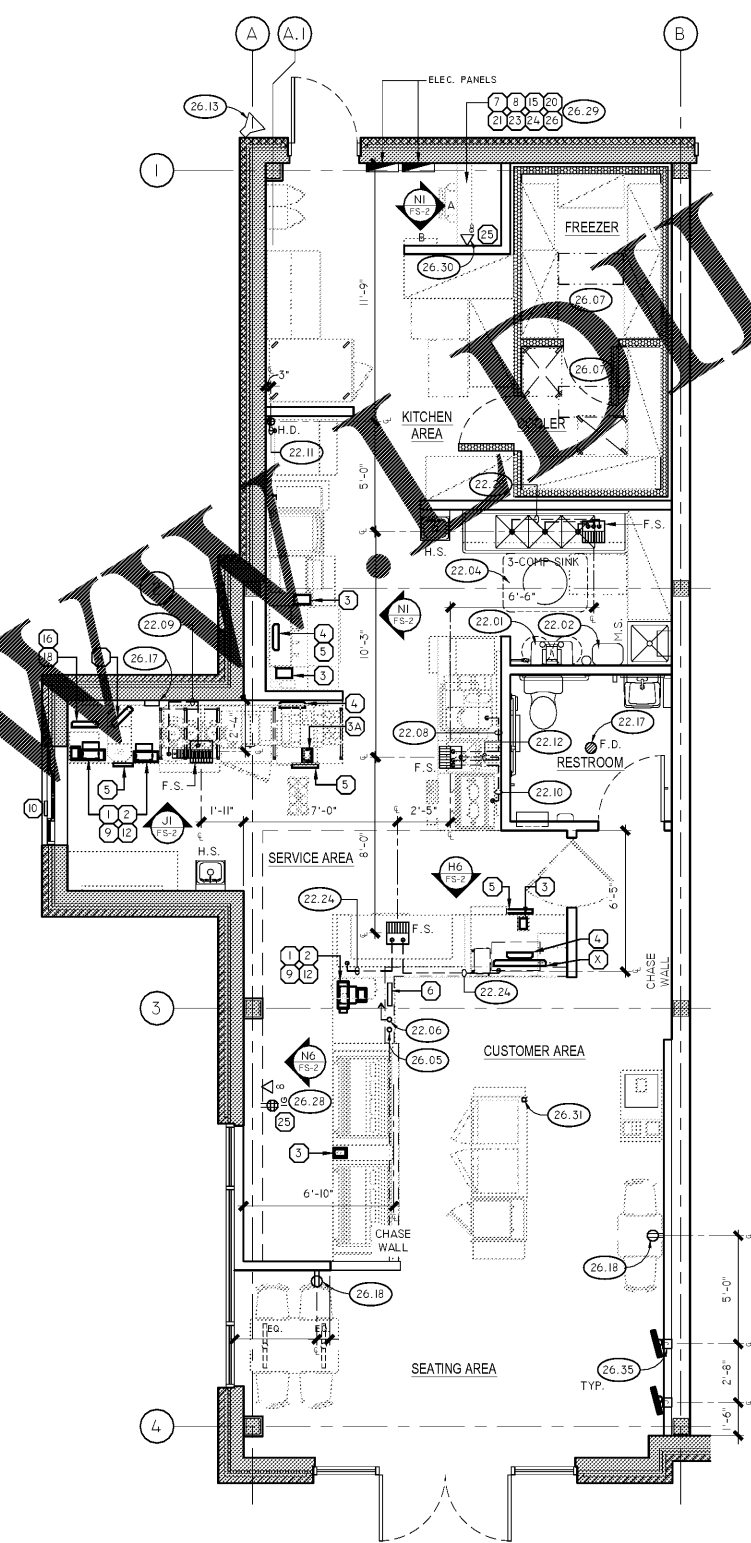

MENU BOARD DATA NOTES:

1. DATA CONNECTION FOR DIGITAL MENU BOARD. CONFIRM REQUIREMENTS AND LOCATION WITH ARCHITECTURAL DRAWINGS.
2. GC /EC TO PROVIDE (2) 1" PVC CONDUITS FOR DATA LINES- LOW VOLTAGE CAT 5 CABLE TO OFFICE
3. GC /EC TO PROVIDE (1) 1" METAL CONDUITS FOR POWER TO ELECTRICAL PANEL.
4. GC ELECTRICIAN CONTRACTOR (EC) TO COORDINATE WHICH OPTION IS TO BE SELECTED BY FRANCHISEE (FEE) PRIOR TO BIDDING OR PERFORMING WORK. AUTHORITY HAVING JURISDICTION (AHJ) MAY REQUIRE FULL WIRE PREP WORK. GC/EC. GC TO ALERT CM, FEE, AND DMB INSTALLER (VIA PHONE AND E-MAIL) IF GC/EC MUST PERFORM ALL ELECTRICAL INSTALL WORK.

OPTIONS (GC TO COORDINATE WHICH OPTION IS TO BE SELECTED BY FRANCHISEE PRIOR TO BIDDING OR PERFORMING WORK)

- OPTION # A. (SITE PREPARATION VERIFICATION) GC/EC TO PROVIDE CAT 5 CABLE AND FINAL ELECTRICAL CONNECTIONS TO DATA BOXES/PLATES.
- OPTION # B. (FULL SITE PREPARATION) GC/EC TO PROVIDE ALL STRINGS FROM MENU BOARD SOFFIT TO OFFICE AND MENU BOARD SOFFIT TO ELECTRICAL PANEL BOARD. TO BID VENDOR TO PROVIDE ALL CAT 5 CABLE AND ELECTRICAL CONNECTIONS TO DATA BOXES/PLATES.

ROUGH IN SHEET NOTES:

1. ELEVATIONS TO BE USED AS A GUIDE FOR ROUGH-IN ELEVATIONS. THE CONTRACTOR SHALL BE RESPONSIBLE FOR COORDINATING & VERIFYING OTHER ROUGH-IN REQUIREMENTS FOR EACH ITEM.
2. THE ELEVATIONS ARE GENERAL IN NATURE AND ARE NOT INTENDED TO BE ALL ENCOMPASSING OR EXHAUSTIVE IN DEPICTING EVERY DEVICE REQUIRED. THE CONTRACTOR SHALL BE RESPONSIBLE FOR COORDINATING WITH FRANCHISEE, EQUIPMENT PLAN, AND ELECTRICAL PLANS FOR ALL DEVICES REQUIRED.
3. THE CONTRACTOR SHALL SCHEDULE A ROUGH-IN INSPECTION WITH THE FRANCHISEE, DUNKIN BRANDS CM, AND/OR ARCHITECT PRIOR TO CLOSING IN WALLS.
4. THE GC SHALL NOTE ALL EQUIPMENT PLUG/OUTLET TYPE AND CONFIGURATION AND ENSURE THAT ALL EXISTING EQUIPMENT TO BE RELOCATED HAVE THE APPROPRIATE OUTLET WHETHER SPECIFICALLY NOTED IN THE DOCUMENTS OR NOT.
5. THE ROUGH IN PLAN IS NOT INTENDED TO BE UTILIZED AS AN ENGINEERED DRAWING. THE PLAN HAS BEEN PROVIDED FOR BIDDING PURPOSES AND AS A GENERAL GUIDE ONLY. THE GC SHALL BE RESPONSIBLE FOR ALL TRADE PERMITS NECESSARY TO COMPLETE THE WORK FOR A COMPLETE AND FULLY FUNCTIONAL STORE.
6. THE GC SHALL COORDINATE WITH THE EQUIPMENT SCHEDULE SHEET K-1 FOR OUTLET CONFIGURATION AND HEIGHTS. EQUIPMENT ELECTRICAL REQUIREMENTS ARE BASED ON CURRENT CUT SHEET INFORMATION. THE GC SHALL COORDINATE AND CONFIRM ACTUAL ELECTRICAL REQUIREMENTS WITH ALL EQUIPMENT PLATES PRIOR TO THE INSTALLATION.
7. ALL 120V, 15A AND 20A RECEPTACLES (NEW AND EXISTING) IN KITCHEN AREA AND SERVICE LINES SHALL BE "GFCI" PROTECTED IN ACCORDANCE WITH NEC ART. 210.8(B).

ROUGH-IN PLAN KEY NOTES:

- 22.01 NEW REVERSE OSMOSIS FILTRATION SYSTEM. SEE PLUMBING PLANS.
- 22.02 NEW BOOSTER PUMP. SEE PLUMBING PLANS.
- 22.04 NEW FULLY RECESSED GRD INSTALLED PER MANUFACTURERS WRITTEN INSTRUCTIONS; SEE PLUMBING PLANS.
- 22.06 FILTERED WATER STUB-UP INTO MILLWORK CHASE WALL; SEE DETAILS & PLUMBING PLANS.
- 22.08 DRAIN ISLAND OASIS INDIRECT TO NEW FLOOR SINK; SEE DETAILS & PLUMBING PLANS.
- 22.09 DRAIN COFFEE STATION INDIRECT TO NEW FLOOR SINK; SEE DETAILS & PLUMBING PLANS.
- 22.10 DRAIN ESPRESSO INDIRECT TO NEW FLOOR SINK; SEE PLUMBING PLANS.
- 22.11 DRAIN ICE MAKER CONDENSATE AND ICE BIN INDIRECT TO NEW OPEN SITE DRAIN; SEE PLUMBING PLANS.
- 22.12 DRAIN RINSE SINK INDIRECT TO NEW FLOOR SINK; PLUMBING PLANS.
- 22.17 CENTER FLOOR DRAIN IN RESTROOM.
- 22.24 DRAIN WATER CHILLER & TAP REFRIGERATOR INDIRECT TO NEW FLOOR SINK; SEE PLUMBING PLANS.
- 26.05 ELECTRIC & DATA STUB-UP FROM SLAB BELOW INTO MILLWORK CHASE WALL. PROVIDE CONDUIT & PULL STRING FOR NET WORK WIRING. THE CONTRACTOR SHALL BE RESPONSIBLE FOR ACTUAL ROUTING OF CONDUITS. NETWORK CONDUITS SHALL RUN BELOW SLAB TO OFFICE & TURN UP INTO OFFICE WALL. SEE OFFICE R/F ELEVATION FOR HEIGHTS.
- 26.07 SELF CONTAINED "CAPSULE" PACK REFRIGERATION SYSTEM - SEE ELECTRICAL PLANS.
- 26.17 WIRELESS HEADSET TRANSMITTER MOUNTED TO WALL AS INDICATED. SEE POS/OT STATION DETAIL SHEET FS-2 & ELECTRICAL PLANS.
- 26.18 USB IN CUSTOMER AREA WALL 18" ABOVE FINISH FLOOR, TYP.
- 26.28 RECESSED 3-GANG WALL BOX CENTERED ON MENU BOARDS.
- 26.29 HIGH SPEED INTERNET BY PROVIDER; COORDINATE WITH FRANCHISEE.
- 26.30 MENU BOARD DATA. GC TO PROVIDE BOX AND PLATES.
- 26.35 JUNCTION BOX IN WALL FOR KIOSK; COORDINATE WITH ELECTRICAL PLANS AND MANUFACTURERS SPECIFICATIONS.
- 26.31 NEW 2X2 BLACK POWER POLE FROM ABOVE CEILING TO GRAB-N-GO MERCHANDISER BELOW.

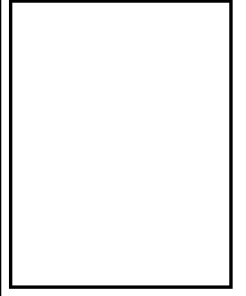
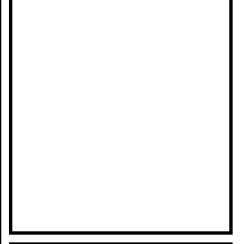

dunkin' brands.
 STORE #357281
 JEFFERSON DAVIS HWY
 DUMFRIES, VA

REVISION		
No.	DATE	DESCRIPTION

DWG DATE: 06-29-2018
 DRAWN BY: STAFF
 PROJECT No.: 17157

DWG TITLE:
 ROUGH-IN PLAN

SHEET No.
FS-1

J1 ROUGH-IN PLAN

SCALE: 1/4" = 1'-0"

Order Plans.com