

Order Plans @

WWW.DINK.COM

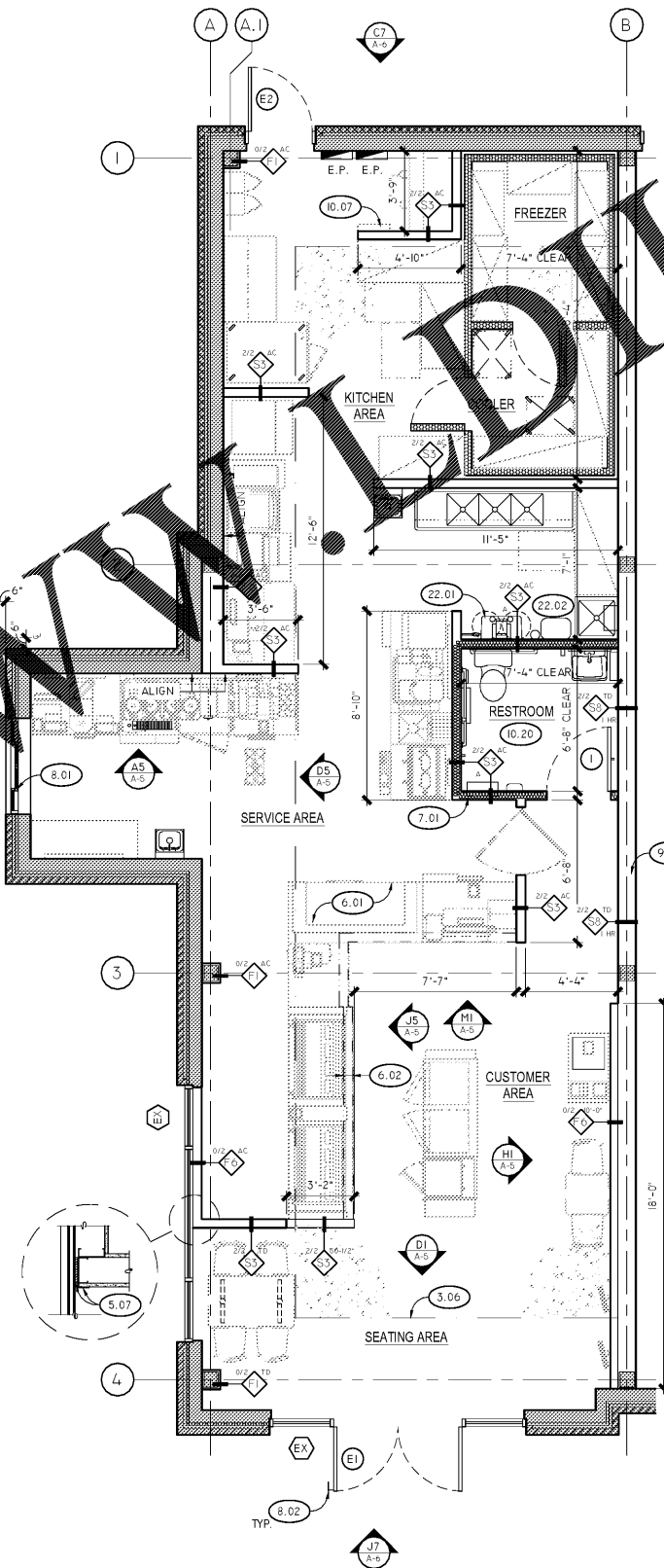

J1 FLOOR PLAN

SCALE: 1/4" = 1'-0"

GENERAL FLOOR PLAN NOTES:

- TYPICAL SUBSTRATES FOR INTERIOR WALLS SHALL BE AS FOLLOWS:  
 KITCHEN, OFFICE AND STORAGE AREAS:  
 5/8" DUROCK FROM FLOOR TO 3'-0" A.F.F. - 5/8" FIRE RETARDANT TREATED PLYWOOD FROM 3'-0" A.F.F. TO 6' ABOVE CEILING.  
 SERVICE AREAS:  
 1/2" DUROCK OVER 5/8" MIN. FIRE RETARDANT TREATED PLYWOOD ALL AREAS TO RECEIVE TILE FINISH.  
 SALES AND SEATING AREAS:  
 5/8" GYPSUM BOARD  
 RESTROOMS:  
 5/8" DUROCK BOARD FROM FLOOR TO TILE FINISH HEIGHT (COORDINATE WITH RR INTERIOR ELEVATIONS). 5/8" G.W.B. FROM TILE FINISH HEIGHT TO 6' ABOVE CEILING.  
 GENERAL CONTRACTOR SHALL PROVIDE ADEQUATE LOCKERS IN BATHROOMS FOR GRAB BARS, LAVATORIES, AND BUFFERS, HAND DRYERS, PAPER TOWEL DISPENSERS, SOAP DISPENSERS, AND OTHER ACCESSORIES AS REQUIRED UNLESS OTHERWISE NOTED.  
 ALL NEW PARTITIONS SHALL BE 3-5/8" METAL STUD @ 16" O.C. U.N.O.  
 RESTROOM IDENTIFICATION SIGN, HANDICAP ACCESSIBLE SYMBOL AND BRAILLE SUPPLIED WITH STORE GRAPHICS PACKAGE. GC TO INSTALL (1 UNISEX RESTROOM SIGN). RESTROOM SIGNAGE MUST BE MOUNTED SUCH THAT THE LOWEST BRILLE CHARACTER IS 48" MINIMUM A.F.F. AND THE HIGHEST BRILLE CHARACTER IS 60" MAXIMUM A.F.F. INSTALL 9" FROM STRIKE LINE OF DOOR.  
 ALL INTERIOR DIMENSIONS SHOWN ARE FROM FACE OF SUBSTRATE TO FACE OF SUBSTRATE.  
 GC TO PROVIDE SUBSTRATE PER GENERAL NOTE 1 ON INTERIOR SIDE OF ALL PERIMETER FINISH WALLS & DEMISING WALL. GC SHALL PATCH & REPAIR DEMISING WALL AS REQUIRED TO MAINTAIN FIRE RATING BASED ON UL 1465.  
 SHELF FOR BOOSTER PUMP BY MANUFACTURER (MCCANN'S ENGINEERING & MANUFACTURING #16-1451, 19-1/4"W X 16"D X 14"H); SUPPLIED/ INSTALLED BY G.C.  
 PROVIDE FIRE EXTINGUISHERS, TYPE ABC, WALL HUNG, TOP AT 5'-0" A.F.F. (BY G.C.)  
 -NUMBER AND LOCATION AS DETERMINED BY LOCAL CODE  
 PROVIDE WINDOW SHADES AT GLAZING AS INDICATED ON PLANS. SEE SPECIFICATIONS.  
 EQUIPMENT/CASEWORK SUPPLIER TO PLACE ALL NEW EQUIPMENT AND CASEWORK.  
 G.C. TO MAKE FINAL MECHANICAL, ELECTRICAL & PLUMBING CONNECTIONS FOR ALL EQUIPMENT AS INDICATED ON PLANS.  
 ALL EXISTING DOORS TO REMAIN SHALL BE SERVICED FOR PROPER OPERATION INCLUDING THE STOREFRONT ENTRY DOOR.  
 GC SHALL PROVIDE APPROXIMATELY 755 SF OF NEW INTERIOR CONCRETE SLAB OVER EXISTING GRAVEL FILL. SLAB SHALL BE 4" THICK WITH REINFORCING & VAPOR BARRIER IN ACCORDANCE WITH LANDLORD SHELL PLANS.  
 ALL WOOD USED FOR PARTITIONS, STRUCTURAL ELEMENTS, ROOF FRAMING, BULKHEAD FRAMING AND SIMILAR PURPOSES SHALL BE FIRE RETARDANT TREATED WOOD IN ACCORDANCE WITH AWPA-C27-74 FOR PLYWOOD, AWPA-C20-74 FOR LUMBER WHETHER SPECIFICALLY NOTED AS SUCH OR NOT.

FLOOR PLAN KEY NOTES: 0.0

- LINE OF EXISTING CONCRETE LEAVEOUT - SEE GENERAL NOTES FOR CONCRETE SLAB SCOPE OF WORK.
- PROVIDE BOLLARDS AS INDICATED IN PLAN. ALL BOLLARDS WHETHER EXISTING OR NEW SHALL RECEIVE A NEW BOLLARD COVER [BC-1]. SEE DETAIL SHEET AS-2.
- PROVIDE END WALL CLOSURE PANEL AND NEOPRENE GASKET WHERE PARTITION ABUTS EXISTING GLAZING.
- NEW MILLWORK PROVIDED BY MILLWORK VENDOR; COORDINATE WITH FIELD SEEKER FOR ALL HOLD TO DIMENSIONS.
- DASHED LINE OF FRONT SERVICE LINE MILLWORK CHASE WALL PROVIDED BY MILLWORK VENDOR.
- PROVIDE 3 1/2" SOUND ATTENUATION BATT AT ALL RESTROOM WALLS AS INDICATED ON PLAN.
- DRIVE THRU WINDOW AS SCHEDULED. SEE DETAILS AND NATIONAL ACCOUNTS.
- PROVIDE "D" DOOR PULL ON EACH LEAF OF THE EXTERIOR ENTRY STOREFRONT DOORS AS INDICATED. SEE DOOR AND HARDWARE SCHEDULE AND NATIONAL ACCOUNTS.
- NEW 1 HR RATED TENANT DEMISING WALL - UL ASSEMBLY U465. SEE SHEET T-6.
- COAT RACK PROVIDED BY THE GC.
- NEW RESTROOM ACCESSORIES EACH RESTROOM. SEE RESTROOM ACCESSORIES PLAN & SCHEDULE SHEET A-7.
- NEW REVERSE OSMOSIS FILTRATION SYSTEM. SEE PLUMBING PLANS.
- NEW BOOSTER PUMP. SEE PLUMBING PLANS.



Quick Service Restaurant and Retail Design Group, LLC  
Cedeville Road, Suite 3D Annapolis, MD 21409  
Ph. No. (410) 364-9880



dunkin' brands.  
STORE #357281  
JEFFERSON DAVIS HWY  
DUMFRIES, VA

REVISION

No.	DATE	DESCRIPTION

DWG DATE: 06-29-2018  
DRAWN BY: STAFF  
PROJECT No.: 17157  
DWG TITLE:

FLOOR PLAN

SHEET No.  
A-1