

CEILING LEGEND	
	EXHAUST FAN
	6" LED DOWN LIGHT PROVIDED BY OWNER
	2x2 LED LAY-IN TROFFER PROVIDED BY OWNER
	SUSPENDED ACOUSTIC TILE CEILING @ 10'-2" A.F.F. UNLESS OTHERWISE NOTED
	GYPSUM BOARD CEILING
	EXIT LIGHT - PROVIDED BY OWNER
	BATTERY BACK-UP EGRESS LIGHTING - PROVIDED BY OWNER
	EXIT LIGHT W/ BATTERY BACK-UP EGRESS LIGHTING - PROVIDED BY OWNER
<p>LIGHTING NOTE: GENERAL SWITCH LOCATIONS & WIRING TO BE DETERMINED BY LIGHTING CONTRACTOR PER LOCAL CODE AND TO BE APPROVED BY ASPEN DENTAL. ALL CEILING & LIGHT SUPPORT WIRES TO BE HUNG FROM TOP CHORD OF JOIST SYSTEM.</p> <p>RECESSED FIXTURE NOTE: G.C. TO PROVIDE "TENTING" AT ALL RECESSED CAN FIXTURES AS REQUIRED BY THE MANUFACTURERS WRITTEN INSTRUCTIONS INSURING THAT NO INSULATION TOUCHES THE FIXTURES.</p> <p>NOTE: SEE ROOM FINISH SCHEDULE FOR CEILING FINISH & HEIGHT</p>	

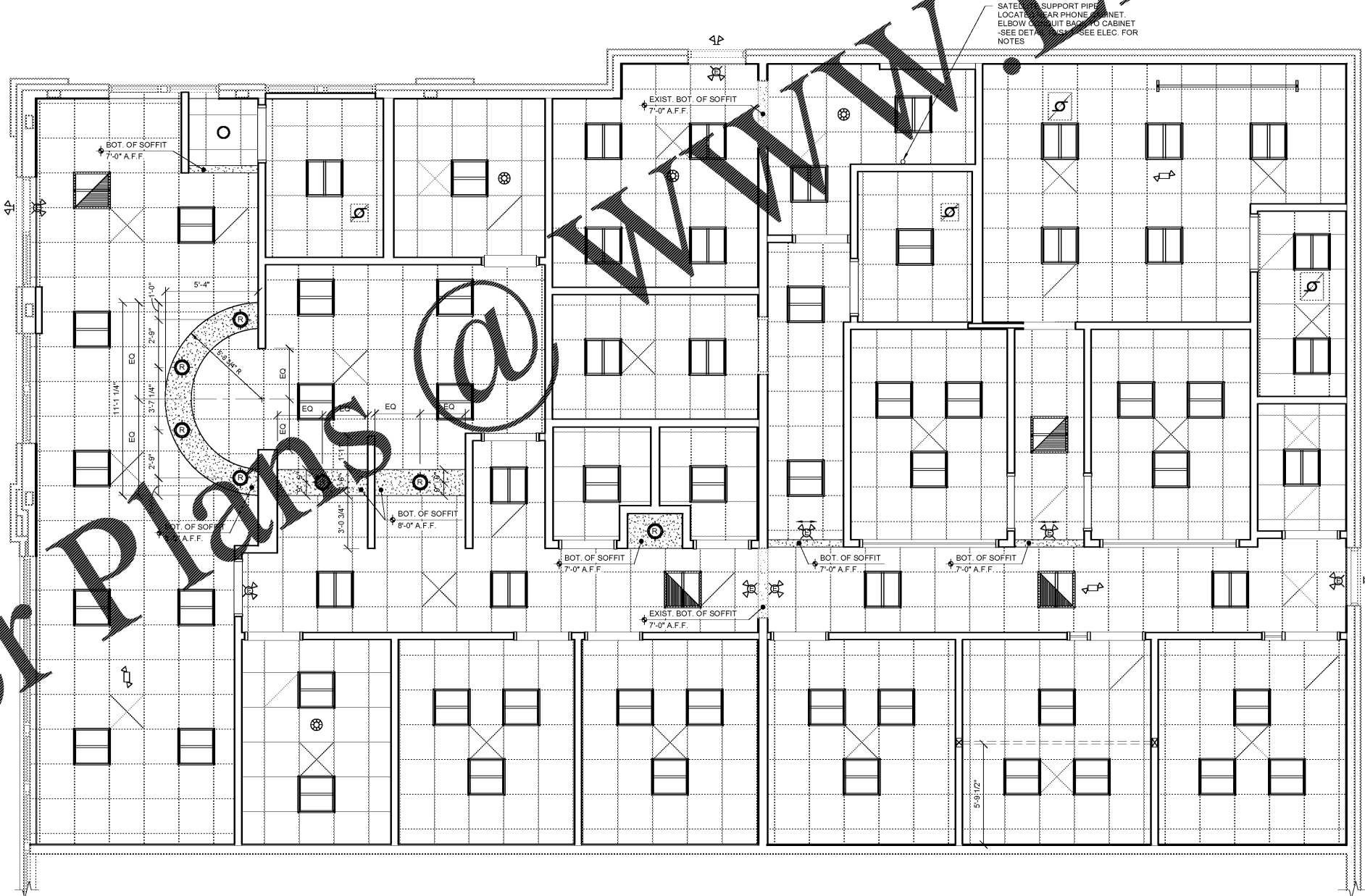
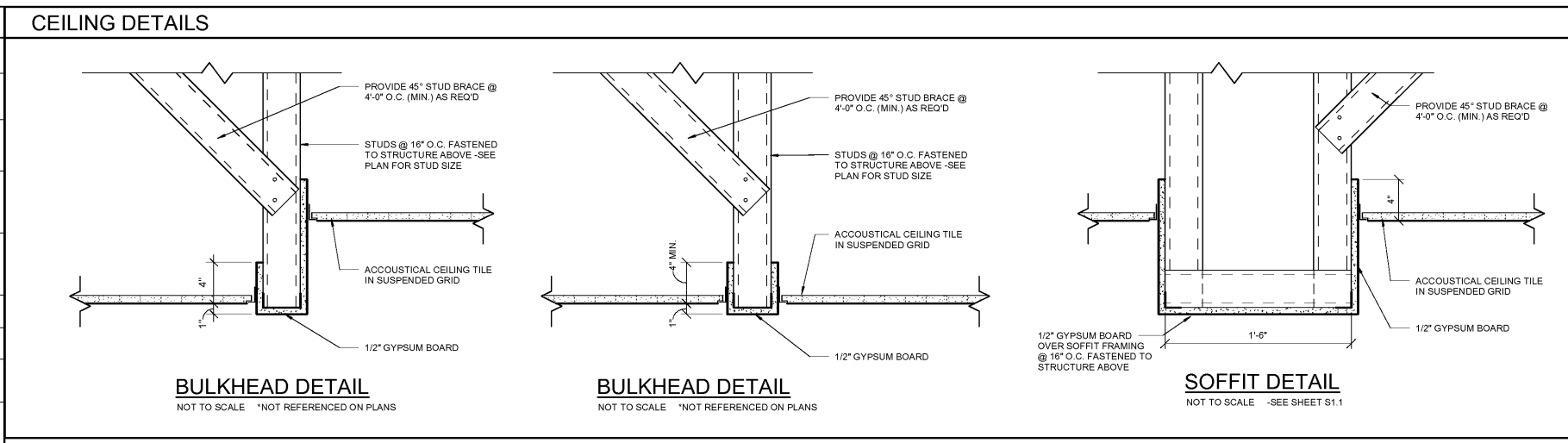

EXCEL
ARCHITECTS • ENGINEERS • SURVEYORS

100 PINELOT DRIVE
FOUNTAIN LAKE, WI 54935
PHONE: (920) 926-9800
WWW.EXCELENGINEER.COM

COLLABORATION

AspenDental

PROJECT INFORMATION

PROJECT NUMBER 1823380

TENANT BUILD-OUT FOR:
ASPEN DENTAL
4011 WARDS ROAD • LYNCHBURG, VA 24502

PROFESSIONAL SEAL

SHEET DATES

SHEET ISSUE MAY 31, 2018

REVISIONS

SHEET INFORMATION

REFLECTED CEILING PLAN & DETAILS

SHEET NUMBER

A7.1

2017 © EXCEL ENGINEERING, INC.

Order Plans @ www.wldilines.com