

LEGEND:

----- 545 -----	EXISTING MAJOR CONTOUR
----- 544 -----	EXISTING MINOR CONTOUR
- x - x - x - x - x - x -	EXISTING FENCE
⊕	TEMPORARY BENCHMARK
⊙	EXISTING STORM MANHOLE
⊗	EXISTING TREE

NOTES:

1. SITE ADDRESS - 800 GOLDEN FLAKE DR. BIRMINGHAM, AL 35205
2. OWNER - CITY OF BIRMINGHAM, AL ADDRESS - 710 NORTH 20TH STREET BIRMINGHAM, AL 35203
3. THE PROPERTY IS LOCATED IN THE NE 1/4 OF SECTION 2, T18S, R3W.
4. BY GRAPHIC PLOTTING ONLY, THIS PROPERTY IS OF THE FLOOD INSURANCE RATE MAP, COMMUNITY PANEL NO. 01073C0389G, WHICH BEARS AN EFFECTIVE DATE OF SEPTEMBER 29, 2006 AND IS IN FLOOD ZONE X (SHADED).
FLOOD ZONE DETAILS SHOWN BELOW:
o. FLOOD ZONE X (SHADED) - AREAS OF 0.2% ANNUAL CHANCE FLOOD; AREAS OF 1% ANNUAL CHANCE FLOOD WITH AVERAGE DEPTHS OF LESS THAN 1FOOT ETC. (INSIDE THE 500 YEAR FLOOD PLAIN)

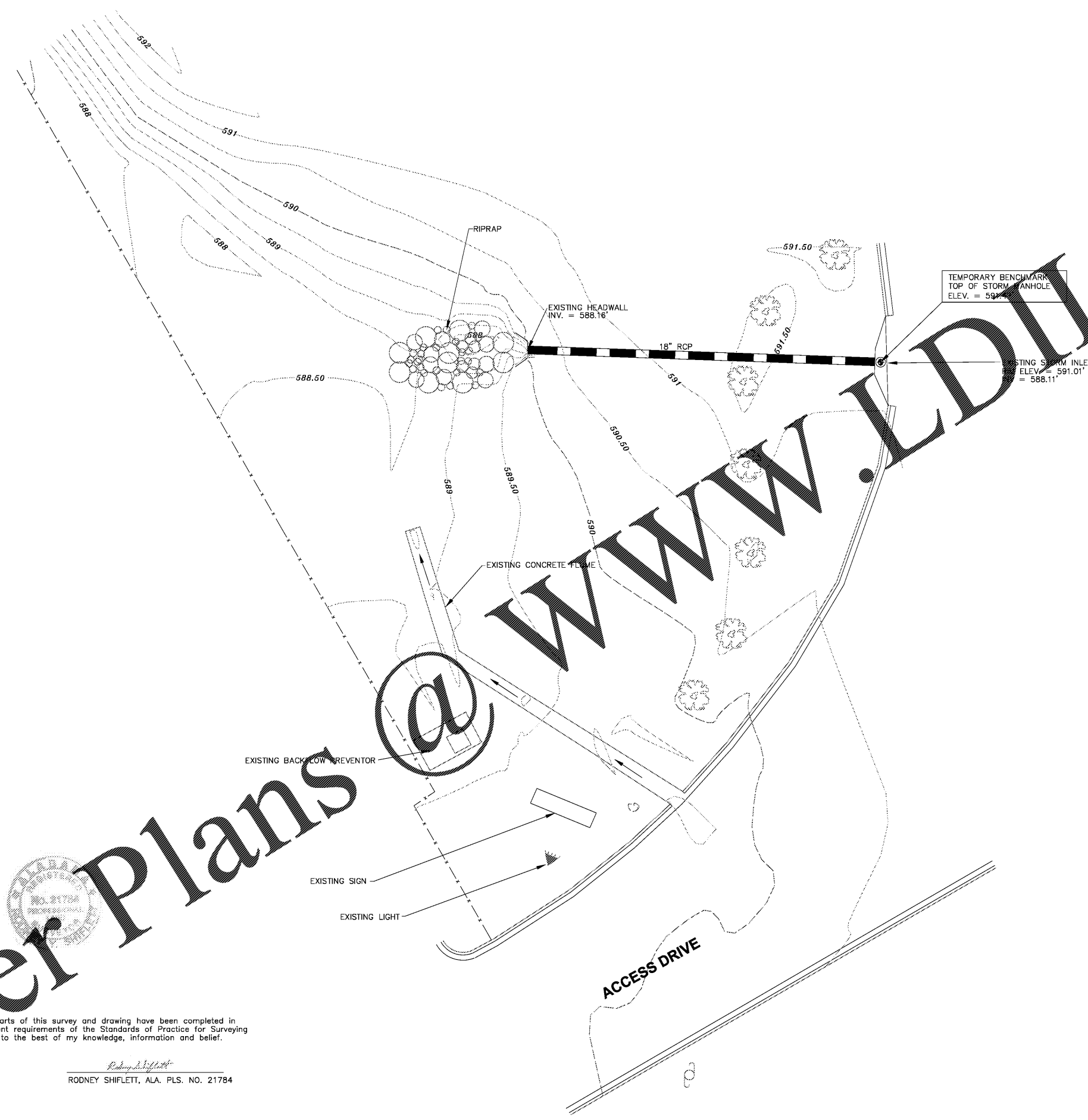

Order Plans @ www.LDLine.com

I hereby certify that all parts of this survey and drawing have been completed in accordance with the current requirements of the Standards of Practice for Surveying in the State of Alabama, to the best of my knowledge, information and belief.

Date: 5-31-17
 Rodney Shiflett
 RODNEY SHIFLETT, ALA. PLS. NO. 21784

CITY OF BIRMINGHAM				
800 GOLDEN FLAKE DRIVE				
TOPOGRAPHIC SURVEY				
CE ASSOCIATES		5229 MESSER AIRPORT HWY. BIRMINGHAM, AL 35212, T: 205-995-0401 F: 205-995-0441 WEB: WWW.CEASSOCIATES.COM		
DATE	DRAWN	CHECKED	SCALE	SHEET NO.
MAY 2017	JAS	RS	1" = 10'	1 OF 1