

MURPHY USA

STORE #1382 FUEL FACILITY CANOPY 508 SC -72, GREENWOOD, SC 29646 46'-0" x 122'-4" FUEL CANOPY

GreenbergFarrow

21 South Evergreen Avenue
Suite 200
Arlington Heights, Illinois 60005
t. 847.788.9200

COPYRIGHT NOTICE
This drawing is the property of the above referenced firm and is not to be used for any purpose other than the specific project and site named herein, without the express written permission from the above referenced firm.

| ISSUE RECORD | | |
|--------------|------|-----------------------|
| DATE | REV. | DESCRIPTION |
| 03/07/2018 | | PERMIT SUBMISSION SET |
| 01/11/2018 | 1 | FMS COMMENTS RESPONSE |



PROFESSIONAL SEAL

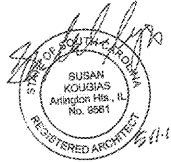

PROFESSIONAL IN CHARGE
SUSAN NELSON KOUGIAS

PROJECT MANAGER
JOHN NASHED

QUALITY CONTROL
CHRIS CERBO

DRAWN BY
SAMUEL VANORA

PROJECT NAME

**MURPHY
USA**

**MURPHY OIL
FUEL FACILITY
CANOPY
508 SC - 72**

GREENWOOD, SC 29646

**FREY MOSS
STRUCTURE**

1801 Rockdale Industrial Blvd.
Coryers, Georgia 30012
Voice: (800) 368-6385
Fax: (770) 483-6037

PROJECT NUMBER
20170844.0

SHEET TITLE

**COVER SHEET,
SHEET INDEX &
CODE DATA**

SHEET NUMBER

CS1

PROTO V3.0 01/03/2017

| ABBREVIATIONS | | |
|-----------------------------|-------------------------------|-----------------------------|
| A = AND | F.F. = FLOOR FINISH | PB = LEVEL PAVEMENT |
| L = ANGLE | FDN. = FOUNDATION | AT DISPENSER |
| @ = AT | FG. = FINISH GRADE | PIT BOX |
| C = CENTERLINE | FN. = FINISH | PL. = PLATE |
| Ø = DIA. OF ROUND | FL. = FLOOR | P.LAM. = PLASTIC LAMINATE |
| # = POUND OR NUMBER | FLASHG. = FLASHING | PLYWD. = PLYWOOD |
| (E) = EXISTING | FLUOR. = FLUORESCENT | P.O.C. = POINT OF CURVATURE |
| (R) = RELOCATED | F.O.C. = FACE OF CONCRETE | P.O.S. = POINT OF SALE |
| (N) = NEW | F.O.F. = FACE OF FINISH | |
| | F.O.S. = FACE OF STUDS | |
| A.B. = ANCHOR BOLT | FR.P. = FIBERGLASS REINFORCED | R or RAD. = RADIUS |
| A.F.F. = ABOVE FINISH FLOOR | PANEL | R.D. = ROOF DRAIN |
| AGGR. = AGGREGATE | REF. = REFERENCE | REF. = REINFORCED |
| AL. = ALUMINUM | FT. = FOOT OR FEET | RECD. = REQUIRED |
| APPROX. = APPROXIMATE | FTG. = FOOTING | RM. = ROOM |
| ARCH. = ARCHITECTURAL | FURR. = FURRING | R.O. = ROUGH OPENING |
| ASPH. = ASPHALT | FUT. = FUTURE | R.O.W. = RIGHT OF WAY |
| BD. = BOARD | | SCHED. = SCHEDULE |
| BITUM. = BITUMINOUS | G.A. = GAUGE | SECT. = SECTION |
| BLDG. = BUILDING | GLAV. = GALVANIZED | SHT. = SHEET |
| BLKG. = BLOCKING | GL. = GLASS | SPEC. = SPECIFICATION |
| BM. = BEAM | GR. = GRADE | SO. = SQUARE |
| BW. = BACK OF WALK | GB. = GRADE BEAM | S.S.T. = STAINLESS STEEL |
| | GSM. = GALVANIZED SHEET METAL | STD. = STANDARD |
| | GYP. BD. = GYPSUM BOARD | STL. = STEEL |
| | | STOR. = STORAGE |
| CAB. = CABINET | HB. = HOSE BB | STR. = STRUCTURAL |
| CEM. = CEMENT | HW. = HARDWARE | SYM. = SYMMETRICAL |
| CER. = CERAMIC | H.M. = HOLLOW METAL | T.C. = TOP OF CURB |
| C.I. = CAST IRON | HORIZ. = HORIZONTAL | TG. = TOP OF GRATE |
| C.J. = CONTROL JOINT | HR. = HOUR | T & G. = TONGUE & GROOVE |
| CLG. = CEILING | HGT. = HEIGHT | THK. = THICK |
| CL. CL. = CLEAR | | TI. = TOP OF ISLAND |
| COL. = COLUMN | IE = INVERT ELEVATION | T.O. = TOP OF |
| CONC. = CONCRETE | I.D. = INSIDE DIAMETER | TOW. = TOP OF WALL |
| CONSTR. = CONSTRUCTION | INSUL. = INSULATION | TP. = TOP OF PAVEMENT |
| CONT. = CONTINUOUS | INT. = INTERIOR | TS. = TOP OF SLAB |
| CTSK. = COUNTERSUNK | | TW. = TOP OF WALK |
| CNTR. = COUNTER | JT. = JOINT | TY. = TYPICAL |
| CTR. = CENTER | | |
| DEPT. = DEPARTMENT | LAM. = LAMINATE | UNF. = UNFINISHED |
| DET. = DETAIL | LAV. = LAVATORY | U.O.N. = UNLESS OTHERWISE |
| DN. = DIAMETER | LP. = EDGE OF SWALE OR GUTTER | NOTED |
| DM. = DIMENSION | | VERT. = VERTICAL |
| DSP. = DISPENSER | MAX. = MAXIMUM | V.I.F. = VERIFY IN FIELD |
| DN. = DOWN | MECH. = MECHANICAL | |
| DR. = DOOR | MEMB. = MEMBRANE | W. = WEST |
| D.S. = DOWNSPOUT | MFR. = MANUFACTURER | W/ = WITH |
| DWG. = DRAWING | MIN. = MINIMUM | W.C. = WATER CLOSET |
| | MIS. = MISCELLANEOUS | W/O. = WITHOUT |
| | M.O. = MASONRY OPENING | WP. = WATERPROOF |
| E = EAST | MTD. = MOUNTED | WGT. = WEIGHT |
| EA. = EACH | MUL. = MULLION | WT. = WEIGHT |
| ELC. = ELECTRICAL | | |
| EQ. = EQUAL | N. = NORTH | |
| EXP. = EXPANSION | N.I.C. = NOT IN CONTRACT | |
| EXT. = EXTERIOR | NO. OF. = NUMBER | |
| | NOM. = NOMINAL | |
| | N.T.S. = NOT TO SCALE | |
| | | |
| | O.C. = ON CENTER | |
| | O.D. = OUTSIDE DIAMETER | |
| | OPNG. = OPENING | |
| | OPP. = OPPOSITE | |

| APPLICABLE CODES | |
|---|--|
| 2015 INTERNATIONAL BUILDING CODE | |
| 2015 INTERNATIONAL FIRE CODE | |
| 2015 INTERNATIONAL PLUMBING CODE | |
| 2015 INTERNATIONAL MECHANICAL CODE | |
| 2009 INTERNATIONAL ENERGY CONSERVATION CODE | |
| 2015 INTERNATIONAL FUEL GAS CODE | |
| 2014 NATIONAL ELECTRICAL CODE | |

| PROJECT TEAM | |
|---------------------------------------|--|
| ARCHITECT CONTACT: | |
| GREENBERG FARROW | |
| 3 EXECUTIVE DRIVE, SUITE 150 | |
| SOMERSET, NJ 08873 | |
| CONTACT: CHRIS CERBO | |
| T: (732) 537-8632 | |
| F: (732) 537-8631 | |
| E: ccerbo@greenbergfarrow.com | |
| STRUCTURAL ENGINEER CONTACT: | |
| GREENBERG FARROW | |
| 1430 WEST PEACHTREE STREET, SUITE 200 | |
| ATLANTA, GA 30309 | |
| CONTACT: BILL BORNHORST | |
| T: (770) 457-0378 | |
| F: (770) 457-0514 | |
| E: bbornhorst@greenbergfarrow.com | |

| GENERAL NOTES | |
|--|--|
| 1. COORDINATE ALL EQUIPMENT PLACEMENTS, SUPPORTS, AND CONNECTIONS WITH EQUIPMENT SUPPLIERS. | |
| 2. COMPLY WITH ALL LOCAL BUILDING CODES, ORDINANCES, AND CONSTRUCTION STANDARDS. | |
| 3. MANUALLY OPERATED EDGED SURFACE MOUNTED FLUSH BOLTS AND SURFACE BOLTS ARE PROHIBITED. | |
| 4. ALL WORK SHALL BE FURNISHED AND INSTALLED IN COMPLIANCE WITH APPLICABLE BUILDING CODES AND THE HIGHEST PROFESSIONAL WORKMANSHIP OF THE BUILDING TRADES PERFORMING UNDER THIS CONTRACT. | |
| 5. ALL REQUIRED CONTROLLED INSPECTIONS SHALL COMPLY WITH THE LOCAL BUILDING CODES. | |
| 6. THE CONSTRUCTION SUPERVISOR SHALL COORDINATE THE WORK OF ALL TRADES AND SHALL BE RESPONSIBLE FOR THE SCHEDULING OF THE WORK. | |
| 7. ELECTRICAL SYSTEMS SHALL BE INSTALLED PER APPLICABLE ELECTRICAL CODE AND IN ACCORDANCE WITH ALL APPLICABLE UTILITY COMPANY SPECIFICATIONS AND MUNICIPAL JURISDICTIONAL CODES. | |
| 8. ALL PLUMBING AND ELECTRICAL PIPING CONDUIT SHALL BE CONCEALED EXCEPT AS OTHERWISE SPECIFIED. | |
| 9. COORDINATION OF PLANS AND SPECIFICATIONS: THE CONTRACTOR SHALL TAKE NO ADVANTAGE OF ANY APPARENT ERROR OR OMISSION. HE SHALL IMMEDIATELY NOTIFY THE ARCHITECT IN WRITING. THE ARCHITECT WILL THEN MAKE SUCH CORRECTIONS AND INTERPRETATIONS AS MAY BE DEEMED NECESSARY FOR FULFILLING THE INTENT OF THE PLANS AND SPECIFICATIONS. | |
| 10. PROVIDE METAL ACCESS DOORS TO DUCTS AND OTHER MECHANICAL/ELECTRICAL EQUIPMENT THROUGH SPACES, OR CEILINGS AS REQUIRED BY MECHANICAL/ELECTRICAL DRAWINGS AND THE APPLICABLE REQUIREMENTS OF THE BUILDING CODES (BUILDING, MECHANICAL, ELECTRICAL). | |
| 11. PROPER STDS. OF CONSTRUCTION SHALL BE USED AS RECOMMENDED AS ACCEPTABLE STDS. IN THE INDUSTRY FOR ALL CONSTRUCTION EVEN IF NOT SPECIFIED IN DETAIL. | |
| 12. ESTABLISH AND VERIFY ALL OPENINGS AND INSERTS FOR ARCHITECTURAL, MECHANICAL, ELECTRICAL, AND PLUMBING WITH APPROPRIATE TRADES, DRAWINGS AND SUBCONTRACTORS PRIOR TO CONSTRUCTION. | |
| 13. PRIOR TO CONSTRUCTION, THE CONTRACTOR SHALL VERIFY AND BE RESPONSIBLE FOR THE CORRECTNESS OF ALL DIMENSIONS. | |
| 14. IT IS THE G.C.'S RESPONSIBILITY TO COORDINATE LOCATE AND CONFIRM ALL UNDERGROUND/OVERHEAD PLUMBING AND ELECTRICAL STUB UPS. | |
| 15. G.C. TO CAULK AND SEAL ALL EXPANSION JOINTS AT ALL INTERIOR CONCRETE PRIOR TO FLOORING. | |
| 16. ALL EXPOSED UNFINISHED METAL AND WOOD SHALL BE PAINTED AS PER DRAWINGS AND SPECIFICATION. | |
| 17. GENERAL CONTRACTOR SHALL ENCLOSE, SEAL, AND COVER ALL PIPE, CONDUIT, DUCT, AND STRUCTURAL PENETRATIONS IN ALL WALLS. | |
| 18. IN THE EVENT OF DISCREPANCIES BETWEEN ANY DRAWINGS AND/OR SPECIFICATIONS, THE MORE RESTRICTIVE CONDITION SHALL BE DEEMED AS THE CONTRACT REQUIREMENT, UNLESS OTHERWISE STATED. | |
| 19. CONTRACTOR TO MAINTAIN ROAD CLEANLINESS DURING CONSTRUCTION. | |

| SHEET INDEX | |
|--------------|--------------------------------------|
| SHEET NUMBER | SHEET NAME |
| GENERAL | |
| CS1 | COVER SHEET, SHEET INDEX & CODE DATA |
| S1 | STRUCTURAL GENERAL NOTES |
| ARCH/STRUCT | |
| E1 | FRAMING PLAN |
| E2 | ELEVATIONS |
| E3 | LIGHTING & SOFFIT PLAN |
| E4 | SECTION |
| E5 | SECTION |
| E6 | SECTION |
| F1 | FOUNDATION PLAN |

| SYMBOL LEGEND | |
|------------------|-----------------|
| ROOM TAGS | |
| ROOM NAME | |
| 150 SF | SQUARE FOOTAGE |
| Name | ROOM NAME |
| Elevation | ELEVATION |
| NO. → | NUMBER |
| → | ARROW |
| ⊕ | CENTERLINE |
| ⊖ | DOWN |
| ⊙ | GRID HEAD |
| ⊕ | SPOT ELEVATION |
| ⊖ | PARTITION TYPE |
| ⊙ | DOOR NUMBER |
| ⊕ | WINDOW TAG |
| ⊖ | DETAIL CALL-OUT |
| ⊙ | DETAIL NUMBER |
| ⊕ | SHEET NUMBER |

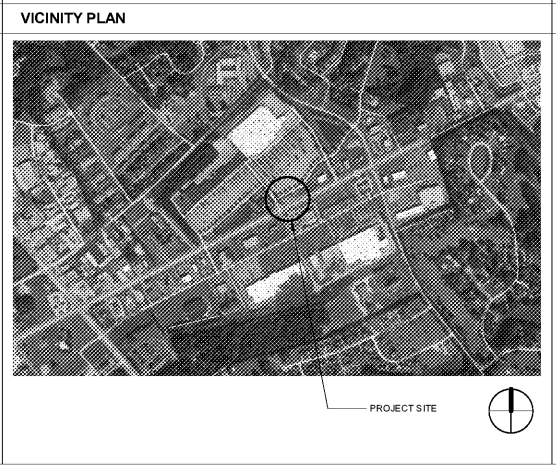
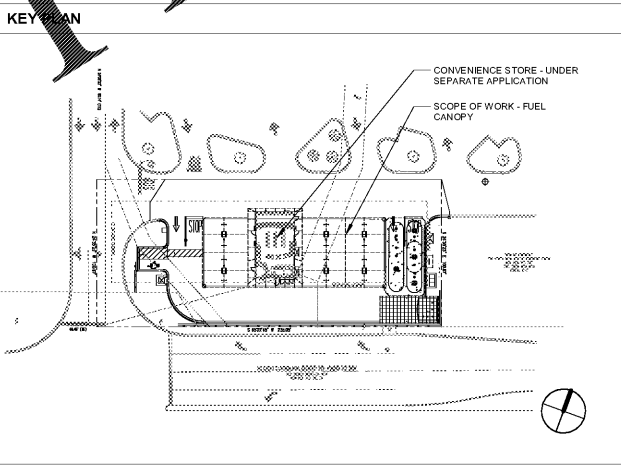

| GENERAL BIDDING NOTES | |
|--|--|
| 1. CONTRACTOR SHALL BE RESPONSIBLE FOR ALL COORDINATION AND SUBMITTALS TO UTILITY COMPANIES FOR THIS PROJECT. | |
| 2. CONTRACTOR SHALL PROVIDE UNIT PRICING TO OWNER ON ALL PHONE, GAS, TELECOMMUNICATION, AND POWER COST FOR THIS PROJECT INCLUDING BUT NOT LIMITED TO TRENCHING, CONDUIT, LINE PULLS, CONNECTION, ETC. | |
| 3. CONTRACTOR SHALL BID THIS PROJECT COMPLETELY WITH NO EXCEPTIONS UNLESS INSTRUCTED BY OWNER. CONTRACTOR SHALL PROVIDE ALLOWANCES ON ANY ITEM THAT CAN NOT BE RESOLVED DURING THE BID PROCESS. | |
| 4. GENERAL CONTRACTOR SHALL FIELD VERIFY ALL UTILITY CONNECTIONS, EXISTING PLUMBING TAPS, ELECTRICAL PANEL LOCATIONS, GAS METERS AND MECHANICAL EQUIPMENT AGAINST THE PLANS AND REPORT ANY DISCREPANCIES DURING THE BID PROCESS. | |
| 5. CONTRACTOR SHALL BE RESPONSIBLE FOR CLARIFICATION OF DOCUMENTS. SHOULD A BIDDER FIND DISCREPANCIES OR OMISSIONS FROM THE DRAWINGS OR DOCUMENTS, OR SHOULD HE BE IN DOUBT AS TO THEIR MEANING, HE SHALL NOTIFY THE ARCHITECT IN WRITING FIVE DAYS OR MORE BEFORE DATE SET TO RECEIVE BIDS, WHO WILL SEND, AFTER CONSIDERATION, IDENTICAL INSTRUCTIONS TO ALL BIDDERS. IN THE EVENT CLARIFICATION IS DEEMED NECESSARY, NEITHER OWNER NOR ARCHITECT WILL BE RESPONSIBLE FOR ORAL INSTRUCTIONS. | |
| 6. GENERAL CONTRACTOR SHALL VERIFY GOVERNING REQUIREMENTS PRIOR TO BID. | |
| 7. THE ARCHITECT ASSUMES THE GENERAL CONTRACTOR HAS INCLUDED IN HIS BID PRICING THE HIGHEST QUALITY AND GREATEST QUANTITY FOR THE PURPOSE OF RESOLVING ANY CONFLICTS IN THE CONSTRUCTION DOCUMENTS WHICH ARE IMPLIED OR UNDERSTOOD. | |
| 8. ALL BID NUMBERS SHOULD INCLUDE BREAKDOWN OF UNIT PRICE. | |

P:\2017\20170844\0301 - Plans - 508 SC - 72 - Fuel Canopy - 01/03/2017