

625 Holcomb Bridge Road
Norcross, Georgia 30071
770-209-0029 Fax 582-2800
www.unitedconsulting.com



MURPHY USA
508 SC 72
GREENWOOD, SOUTH CAROLINA
GREENBERG FARROW

PROJECT DESCRIPTION

SHEET TITLE
SITE RETAINING WALL

SCALE: AS NOTED
DRAWN BY: PJC
CHECKED BY: MM
DATE: MARCH 26, 2008
PROJECT ID: 18-SC-0997-02
DRAWING NUMBER

RW1

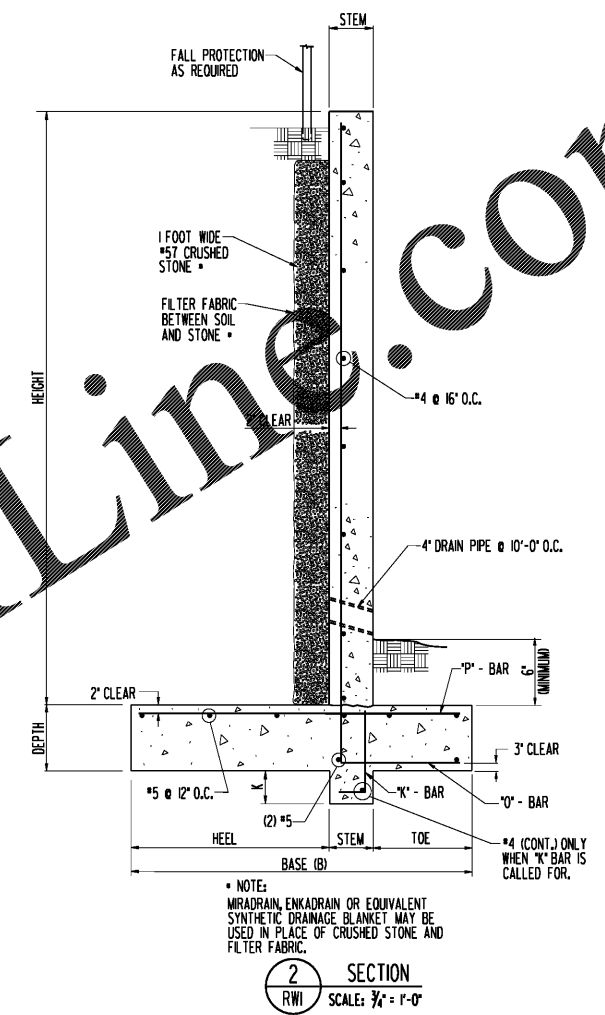

SECTION 2 RWI SCALE: 3/4" = 1'-0"

WALL SCHEDULE FOR SITE RETAINING WALL

HEIGHT	STEM	BASE	TOE	HEEL	DEPTH	10" BAR	12" BAR	14" BAR
2'-0"	8"	1'-10"	4"	10"	12"	#4 @ 12" O.C.	#4 @ 12" O.C.	N/A
3'-0"	8"	2'-5"	7"	1'-2"	12"	#4 @ 12" O.C.	#4 @ 12" O.C.	N/A
4'-0"	8"	3'-0"	1'-2"	1'-2"	12"	#4 @ 12" O.C.	#4 @ 12" O.C.	N/A
5'-0"	8"	3'-8"	1'-9"	1'-3"	12"	#4 @ 12" O.C.	#4 @ 12" O.C.	#4 @ 24" O.C.

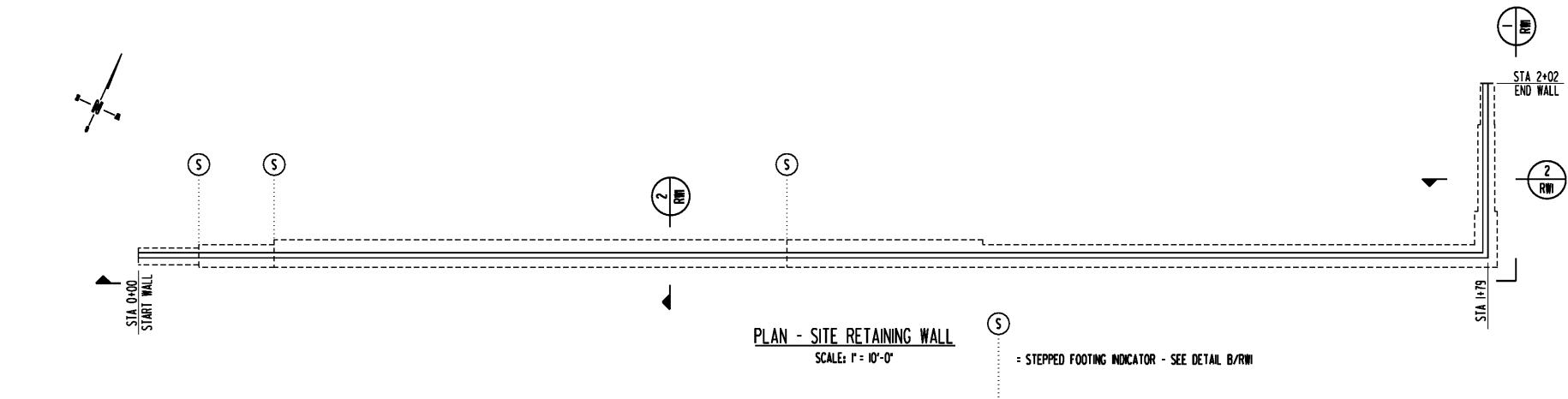

PLAN - SITE RETAINING WALL SCALE: 1" = 10'-0" - STEPPED FOOTING INDICATOR - SEE DETAIL B/RWI

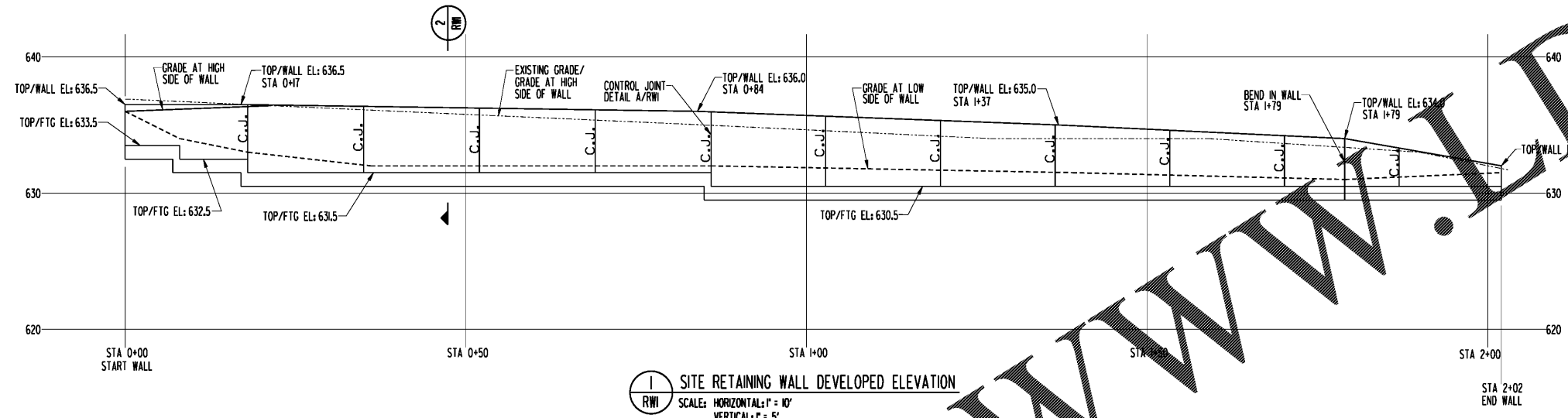

1 SITE RETAINING WALL DEVELOPED ELEVATION SCALE: HORIZONTAL: 1" = 10' VERTICAL: 1" = 5'

GENERAL NOTES FOR RETAINING WALLS

- ALL DESIGN, DETAILING, FABRICATION AND CONSTRUCTION SHALL CONFORM TO THE FOLLOWING CODES AND SPECIFICATIONS:
 - THE SOUTH CAROLINA BUILDING CODE (2005 EDITION).
 - AMERICAN SOCIETY FOR TESTING MATERIALS (ASTM) SPECIFICATIONS.
 - BUILDING CODE REQUIREMENTS FOR REINFORCED CONCRETE (ACI 308-14).
 - SPECIFICATION FOR STRUCTURAL CONCRETE FOR BUILDINGS (ACI-309).

RETAINING WALL DESIGN PARAMETERS

- ALLOWABLE SOIL BEARING PRESSURE = 3000 PSF
- ACTIVE EQUIVALENT FLUID PRESSURE = 4.5 PSF/FT
- PASSIVE EQUIVALENT FLUID PRESSURE = 388 PSF/FT
- COEFFICIENT OF FRICTION BETWEEN SOIL AND CONCRETE = 0.30.
- BACKFILL COMPACTED TO 95% STANDARD PROCTOR MAXIMUM DRY DENSITY.
- ANGLE OF INTERNAL FRICTION = 28 DEGREES
- SOIL UNIT WEIGHT = 115 PCF
- 300 PSF SURCHARGE STARTING 5 FEET BEHIND THE WALL, EXTENDING FOR 10 FEET.

STRUCTURAL CONCRETE GENERAL NOTES:

- CONCRETE SHALL BE NORMAL WEIGHT WITH A MINIMUM COMPRESSIVE STRENGTH OF 3000 PSI AT 28 DAYS.
- REINFORCING STEEL IN CONCRETE SHALL BE ASTM A-615, GRADE 60.
 - REINFORCING STEEL IN CONCRETE SHALL BE FREE FROM MUD, OIL, RUST OR COATINGS THAT WOULD REDUCE OR DESTROY BOND.
 - REINFORCING TENSION LAP SPLICES SHALL BE A MINIMUM OF 24" FOR #4 BARS, AND 28" FOR #5 BARS.
 - MINIMUM CONCRETE COVER ON BARS SHALL BE 2" FOR FORMED SURFACES EXPOSED TO WEATHER OR IN CONTACT WITH THE GROUND; 3" FOR UNFORMED SURFACES DEPOSITED AGAINST THE GROUND; EXCEPT AS NOTED.

SPECIAL INSPECTIONS

- FOOTINGS SHALL BE CHECKED WITH A HAND AUGER AND DYNAMIC CONE PENETROMETER BY THE SPECIAL INSPECTION AGENCY TO VERIFY ADEQUATE SOIL BEARING CAPACITY. FOOTINGS SHALL BE CHECKED AT LEAST EVERY 2 FEET, TO A DEPTH EQUAL TO THE FOOTING WIDTH. SOIL THAT DOES NOT MEET BEARING CAPACITY REQUIREMENTS SHALL BE REMEDIATED AS RECOMMENDED BY THE SPECIAL INSPECTION ENGINEER.
- FOOTING AND WALL DIMENSIONS, AND REINFORCING STEEL SHALL BE CHECKED FOR COMPLIANCE WITH THE DRAWINGS.
- CONCRETE SHALL BE SAMPLED IN ACCORDANCE WITH ASTM C39 AND TESTED IN ACCORDANCE WITH ASTM C318.
- SPECIAL INSPECTION AGENCY SHALL SUBMIT CHECKED REPORTS TO ENGINEER FOR REVIEW, AND SHALL PREPARE A FINAL REPORT OF SPECIAL INSPECTIONS UPON COMPLETION OF INSPECTIONS.

RETAINING WALL BACKFILL

- BACKFILL BEHIND RETAINING WALL SHALL BE COMPACTED IN ACCORDANCE WITH PROJECT SPECIFICATIONS. COMPACTED SHALL BE A MINIMUM OF 95% STANDARD PROCTOR FOR MAXIMUM DRY DENSITY.
- TEST BACKFILL BEHIND RETAINING WALL IN ACCORDANCE WITH PROJECT SPECIFICATIONS.
- DO NOT USE HEAVY EQUIPMENT WITHIN 5 FEET OF BACK OF WALL.

GRADING AND WALL LOCATION

GRADING AND RETAINING WALL LOCATION FROM GREENBERG FARROW DRAWING C-3, DATED 3-16-08.

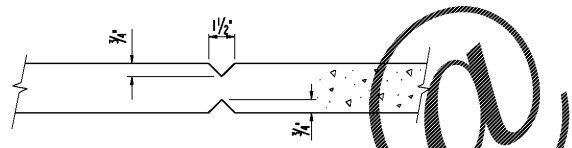

A WALL CONTROL JOINT DETAIL SCALE: NONE

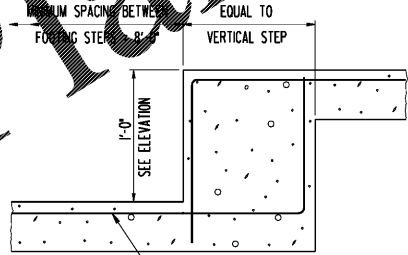

B DETAIL SCALE: NONE

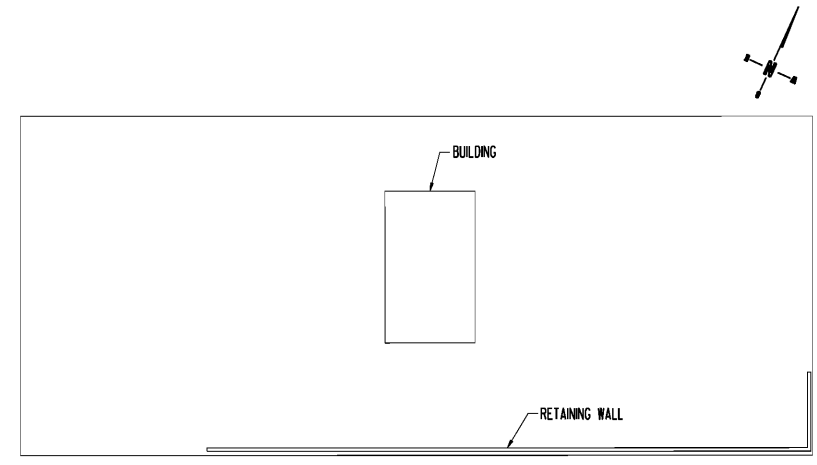

KEY PLAN