

1 2 3 4 5 6 7 8 9 10 11 12 13 14 15 16 17 18 19

U
T
S
R
Q
P
N
M
L
K
J
H
G
F
E
D
C
B
A

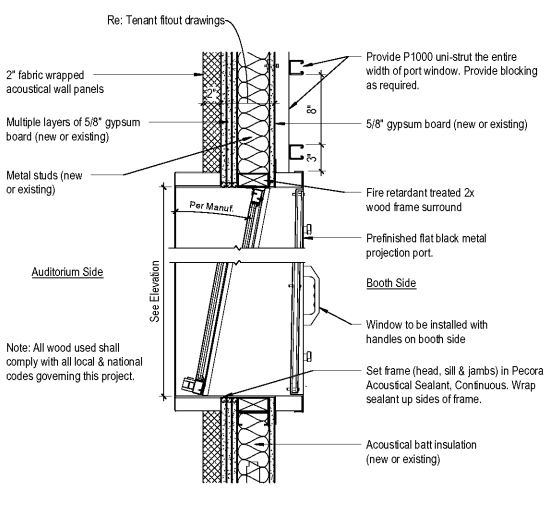

N1 Prefabricated Metal Port Assembly
PLFA3 1/2" = 1'-0"

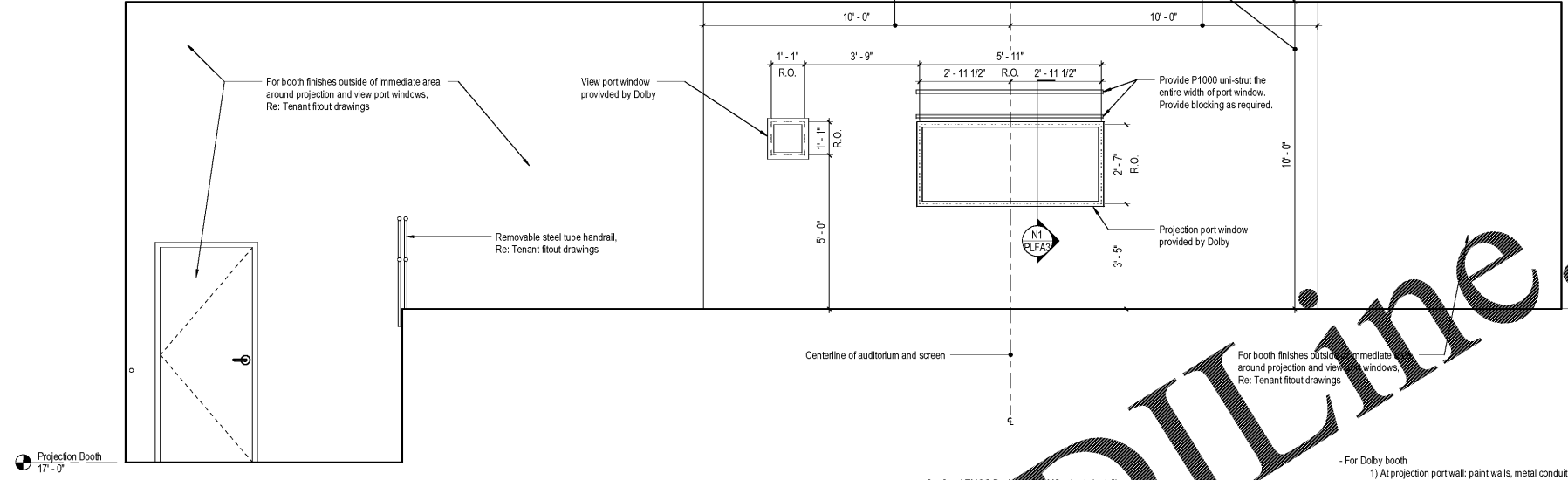

N6 Auditorium #1 Projection Booth - Port Window Elevation
PA1 1/2" = 1'-0"

Confirm Projection/Port Windows with AMC prior to framing rough openings. Window layout shown received from Dolby dated: "2018-0403 0-DC AMC MADISON YARD 8 - PLAN SECTION-PRELIM" received 3 April 2018.

Confirm ATMOS Design with AMC prior to installing ceiling speakers. ATMOS layout shown received from Dolby dated: "2018-0403 0-DC AMC MADISON YARD 8 - ATMOS LAYOUT-PRELIM" received 3 April 2018.

- For Dolby booth

- 1) At projection port wall: paint walls, metal conduit, ductwork, pipes etc. from floor to ceiling (PP-3) starting at projection port(s) centerline out to 10'-0" on each side or to corner of booth, whichever is less. Paint up to 10'-0" above booth floor if no ceiling is present.
- 2) At ceiling over wall area defined above: paint any existing ceiling (PP-5) if not black already. Paint exposed structure, HVAC components, piping, conduit, etc. (PP-5) if within 10'-0" of booth floor.

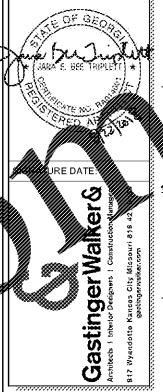
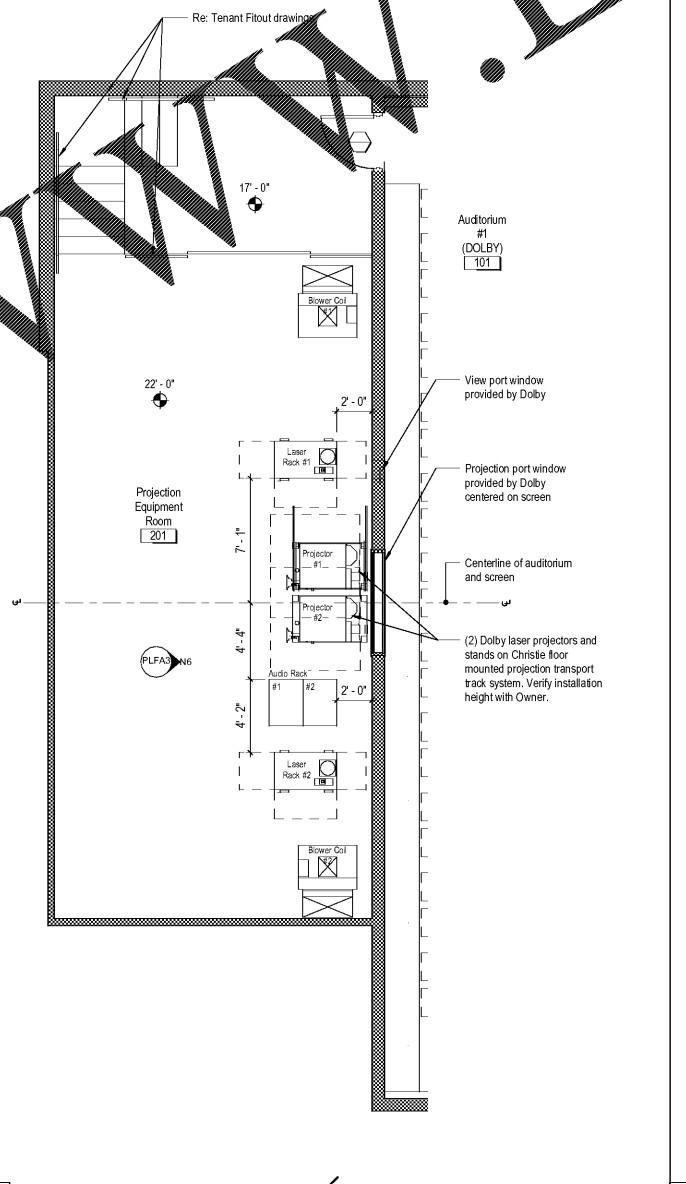
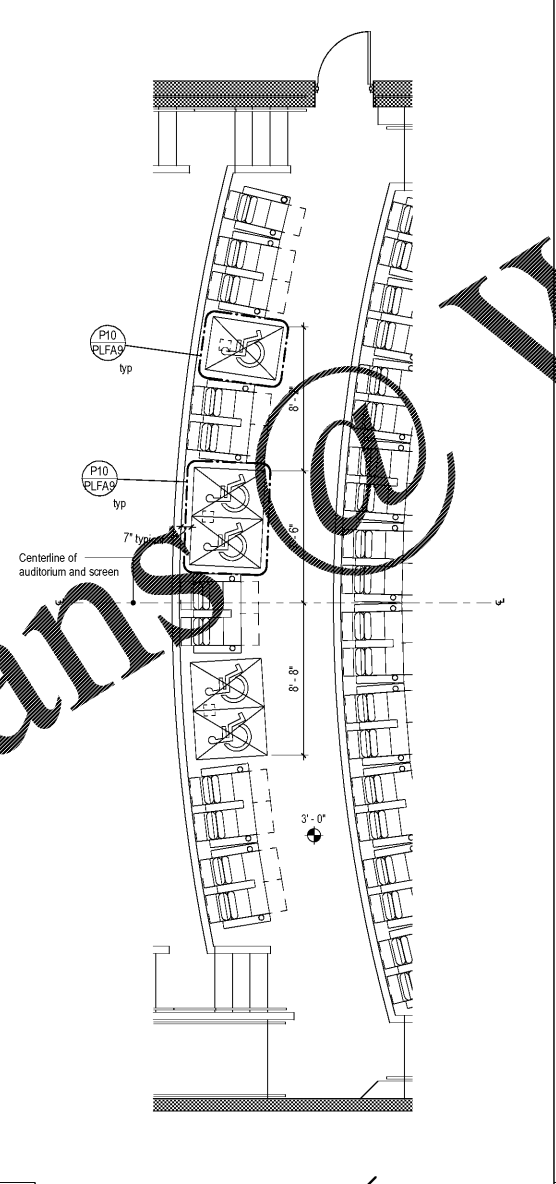

SHEET LEGEND

GENERAL INFORMATION & SCOPE OF WORK

NOES: EXTERIOR ADA PLANS & DETAILS

AD01: FLOOR PLANS & CEILING PLANS

AD02: EXTERIOR & INTERIOR ELEVATIONS

AD03: BUILDING SECTIONS

AD04: ENLARGED PLANS

AD05: EXTERIOR & INTERIOR DETAILS

AD06: FLOOR SCHEDULES, ROOF DETAILS

AD07: FLOOR SCHEDULES, ROOF DETAILS

AD08: AUDITORIUM SEAT LINE SECTIONS

ST: STRUCTURAL

ME: MECHANICAL

EL: ELECTRICAL

PL: PLUMBING

WT: WAITING ROOMS

CE: CEILING & EQUIPMENT

PLA: PLANT AUDITORIUM

AMC MADISON YARDS 8
AMC NEW BUILD
905 MEMORIAL DR SE
ATLANTA, GA 30316



No.	Date	Description

Project Issue Date: 05/22/2018

KEY PLAN:

1	2	3	4	5
6	7	8	9	10
11	12	13	14	15
16	17	18	19	20

SHEET TITLE:
Auditorium #1
Projection
Booth Plans &
WHC Locations

SHEET NUMBER:
PLFA3

Order Plans @ WWW.LDOnline.com

1 2 3 4 5 6 7 8 9 10 11 12 13 14 15 16 17 18 19