

CASEWORK / MILLWORK NOTES

- SUBSTRATE FRAMING TO BE 3/4" MDF
- INTERIOR SURFACES OF CABINETS (INCL. SHELVES) SHALL BE WHITE MELAMINE - NO EXPOSED WOOD
- ALL EDGES OF SOLID SURFACE SHALL BE EASED
- CONCEALED HINGES AT ALL DOORS. DOORS OVER 36" HIGH AND 24" WIDE SHALL HAVE 3 HINGES
- AREAS OF INTEGRAL CASEWORK LIGHTING SHALL ACCOMMODATE ACCESS PANELS

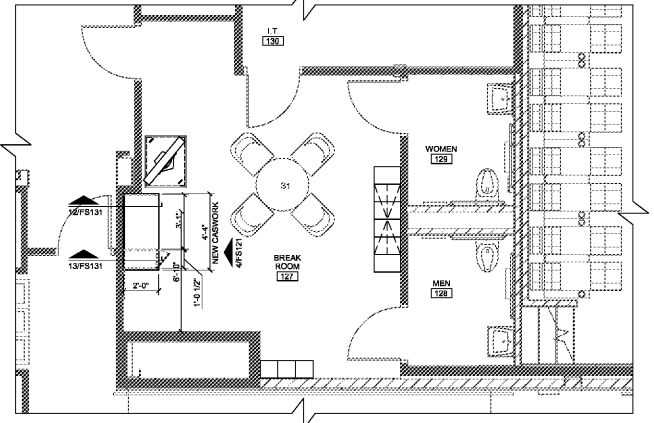

3 BREAK ROOM CASEWORK FRAMING PLAN
SCALE: 1/4" = 1'-0"

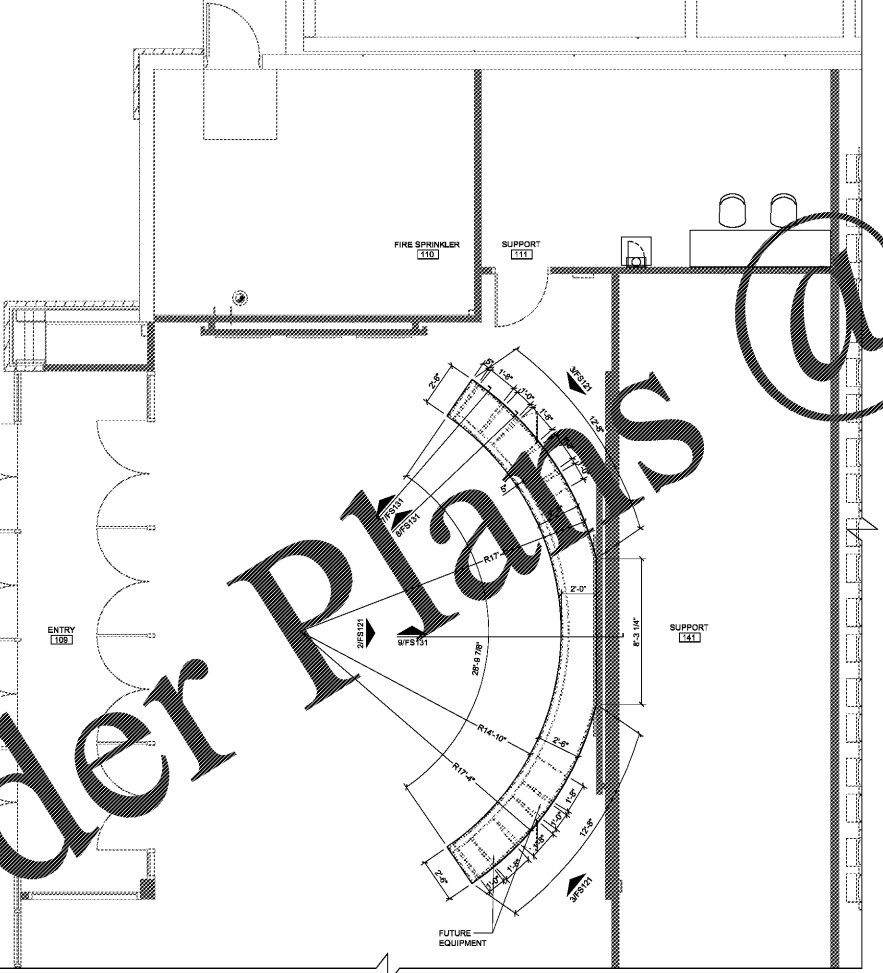

2 BOX OFFICE CASEWORK FRAMING PLAN
SCALE: 1/4" = 1'-0"

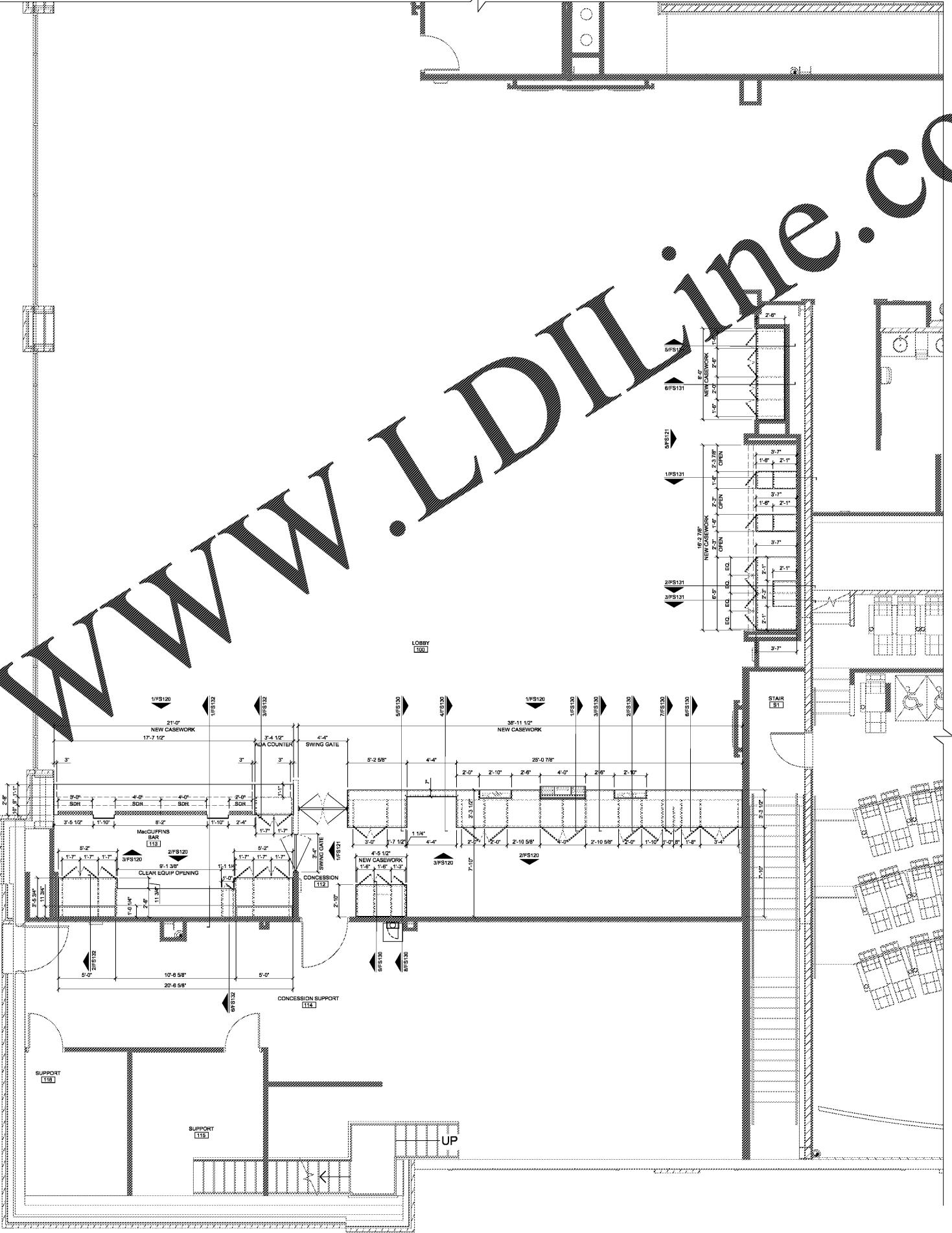

1 LOBBY CASEWORK FRAMING PLAN
SCALE: 1/4" = 1'-0"

WWW.LDILine.com

DATE: _____
 enviro-netics inc
 1375 S. 19th St.
 North Kansas City, Missouri 64116
 PH: (816) 441-8222 FAX: (816) 441-8855

SHEET LEGEND

1/FS	GENERAL INFORMATION & NOTES
2/FS	GENERAL INFORMATION & NOTES
3/FS	GENERAL INFORMATION & NOTES
4/FS	GENERAL INFORMATION & NOTES
5/FS	GENERAL INFORMATION & NOTES
6/FS	GENERAL INFORMATION & NOTES
7/FS	GENERAL INFORMATION & NOTES
8/FS	GENERAL INFORMATION & NOTES
9/FS	GENERAL INFORMATION & NOTES
10/FS	GENERAL INFORMATION & NOTES
11/FS	GENERAL INFORMATION & NOTES
12/FS	GENERAL INFORMATION & NOTES
13/FS	GENERAL INFORMATION & NOTES
14/FS	GENERAL INFORMATION & NOTES
15/FS	GENERAL INFORMATION & NOTES
16/FS	GENERAL INFORMATION & NOTES
17/FS	GENERAL INFORMATION & NOTES
18/FS	GENERAL INFORMATION & NOTES
19/FS	GENERAL INFORMATION & NOTES
20/FS	GENERAL INFORMATION & NOTES

AMC MADISON YARDS 8
 AMC NEW BUILD
 905 MEMORIAL DRIVE SE
 ATLANTA, GA 30316

amc
 American Multi-Cinema, Inc.
 One AMC Way
 11500 Ash Street
 Lenexa, KS 66211

REV	DATE	DESCRIPTION

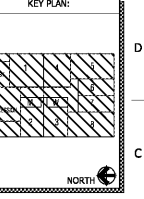

SHEET TITLE:
LOBBY CASEWORK FRAMING PLANS

SHEET NUMBER:
FS113

Order Plans @