

ELECTRICAL GENERAL NOTES

- ALL 120 VOLT CIRCUITS LONGER THAN 100 FEET IN LENGTH SHALL USE #10 AWG CONDUCTORS.
- ALL CIRCUITS SHALL HAVE A SEPARATE GROUNDING CONDUCTOR PER N.E.C. SECTION 250.122.
- ALL CONDUIT INSTALLED INDOORS SHALL BE ELECTRICAL METALLIC TUBING (EMT), MINIMUM 1/2" OR AS NOTED OTHERWISE. CONDUCTORS TO BE A MINIMUM OF #12 THIN WALL COPPER UNLESS NOTED OTHERWISE. BRANCH CIRCUIT TRAYS WITH NO MARKS OR IDENTIFICATION ARE TO BE PROVIDED WITH ONE HOT, ONE NEUTRAL AND ONE EQUIPMENT GROUND CONDUCTOR.
- ELECTRICAL CONTRACTOR SHALL PROVIDE CIRCUIT DIRECTORY WITH TYPED CIRCUIT DESIGNATION AND UNDER PLASTIC COVER ON THE INSIDE OF EACH PANEL DOOR. ELECTRICAL CONTRACTOR SHALL ALSO FURNISH AND INSTALL NAMEPLATES ON ALL DISCONNECT SWITCHES, PANELBOARDS AND SWITCHBOARDS.
- ELECTRICAL CONTRACTOR SHALL FURNISH ALL LABOR, MATERIALS, TOOLS, EQUIPMENT AND PERMITS ALL WORK AND SERVICES NECESSARY FOR OR INCIDENTAL TO THE FURNISHING AND INSTALLATION, COMPLETE OF ALL WORKING MATERIALS AND METHODS AS SHOWN ON THE DRAWINGS AND AS SPECIFIED IN ACCORDANCE WITH PROVISIONS OF THE CONTRACT DOCUMENTS. ALL WORK SHALL BE COORDINATED WITH WORK OF ALL OTHER TRADES.
- FIELD COORDINATE ALL FURNITURE POWER FEED LOCATION PRIOR TO ROUGH-IN PLASTIC GRIDDLE.
- ALL EMPTY CONDUITS SHALL BE PROVIDED WITH PULL STRIPS INSTALLED AND PLASTIC GRIDDLE.
- CONTRACTOR SHALL COORDINATE LOCATION OF ELECTRICAL PANELS WITH THE CEILING TO PROVIDE THE GREATEST CLEARANCE FOR THE PANELS.
- ELECTRICAL CONTRACTOR TO VERIFY EXACT PLACEMENT OF ALL DEVICES SHOWN ON THIS ELECTRICAL CONSTRUCTION DOCUMENTS WITH MECHANICAL DRAWINGS PRIOR TO FINAL ELEMENT.
- DISCONNECT SWITCHES SHALL BE INSTALLED ON THE PANEL. DESIGNATION SHALL BE LISTED TO IDENTIFY SPARK RISK FOR EACH HOMERUN SHOWN IN THIS DOCUMENT.
- ALL ELECTRICAL RECEPTACLES WITHIN 6" OF A SINK OR LAVATORY SHALL BE OF A GFCI TYPE.
- ALL FIRE ALARMS AND OTHER DEVICES LOCATED IN THE SAME ROOM OR OPEN OFFICE AREA SHALL BE SEQUENCED TO FLASH AT THE SAME RATE PER LATEST FIRE ALARM CODE.

ELECTRICAL PLAN NOTES

- MAKE POWER CONNECTION TO THE ROOFTOP UNIT. REFERENCE THE ONE-LINE DIAGRAM FOR CIRCUIT SIZE.
- MAKE POWER CONNECTION TO THE EXHAUST FAN AND ROUTE CIRCUIT THROUGH THE ASSOCIATED MOTOR STARTER LOCATED ON THE PROJECTION LEVEL. REFERENCE THE PROJECTION LEVEL POWER PLANS FOR THE LOCATION OF THE STARTER. PROVIDE A WET LOCATION LISTED MOTOR RATED SWITCH FOR LOCAL DISCONNECTING MEANS.
- MAKE POWER CONNECTION TO THE CONDENSING UNIT. INSTALL A 30AMP SAFETY SWITCH FOR DISCONNECTING MEANS. REFERENCE THE WALK-IN COOLER WIRING DIAGRAM DETAIL AND COORDINATE WORK WITH THE WALK-IN EQUIPMENT INSTALLER.
- MAKE POWER CONNECTION TO THE CONDENSING UNIT AND HOMERUN WITH 2#8, 180V GROUND WIRE IN 1/2" CONDUIT. INSTALL A 30AMP SAFETY SWITCH FOR DISCONNECTING MEANS. REFERENCE THE WALK-IN FREEZER WIRING DIAGRAM DETAIL AND COORDINATE WORK WITH THE WALK-IN EQUIPMENT INSTALLER.
- MAKE POWER CONNECTION TO THE CONDENSING UNIT AND HOMERUN WITH 2#10, 180V GROUND WIRE IN 1/2" CONDUIT. PROVIDE A 30AMP SAFETY SWITCH FOR DISCONNECTING MEANS.
- INSTALL A NEMA SIZE 0 COMBINATION MAGNETIC STARTER/CONNECT TO CONTROL THE EXHAUST FAN. STARTER TO BE IN A NEMA 3R ENCLOSURE WITH AN MCA SELECTOR SWITCH AND A GREEN EMERGENCY LIGHT ON THE FRONT OF THE ENCLOSURE. WIRE STARTER TO THE DESIGNATED RELAY IN LIGHTING CONTROL PANEL LCP2 TO ALLOW THE FAN TO OPERATE ON A TIME BASED SCHEDULE.

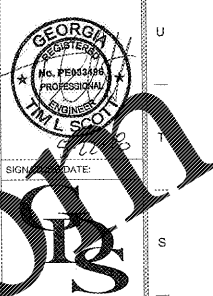

ENGINEERING
 Gibbons, Drake, Scott, Inc.
 5081 E. 64th Street, Suite 100
 Raytown, Missouri 64118
 Phone: (314) 358-1795
 Fax: (314) 358-2427
 www.gdseng.com
 GIBBONS.DRAKE.SCOTT@GDS.COM

SHEET LEGEND

0000	GENERAL INFORMATION & SCHEDULES
1000	FLOOR PLANS & CEILING PLANS
2000	ELECTRICAL & MECHANICAL
3000	MECHANICAL
4000	MECHANICAL
5000	MECHANICAL
6000	MECHANICAL
7000	MECHANICAL
8000	MECHANICAL
9000	MECHANICAL
10000	MECHANICAL

MADISON YARDS 8
 AMC NEW BUILD
 905 MEMORIAL DRIVE SE
 ATLANTA, GA 30316

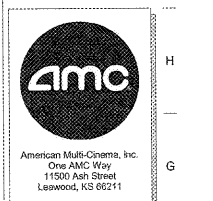

No.	Date	Description

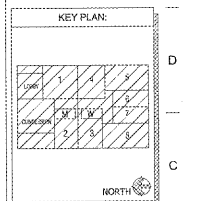

SHEET TITLE:
ROOF LEVEL AREA-A POWER PLAN

SHEET NUMBER:
E105

ROOF LEVEL AREA A POWER PLAN
 1/8" = 1'-0"

THIS DRAWING IS A PART OF AN INSTRUMENT OF SERVICE FOR CONSTRUCTION OF THE PROJECT. IT IS THE PROPERTY OF GIBBONS, DRAKE, SCOTT, INC. AND IS NOT TO BE REPRODUCED, COPIED, OR TRANSMITTED IN ANY FORM OR BY ANY MEANS, ELECTRONIC OR MECHANICAL, WITHOUT THE WRITTEN PERMISSION OF GIBBONS, DRAKE, SCOTT, INC. ANY UNAUTHORIZED REPRODUCTION OR TRANSMISSION OF THIS DRAWING IS STRICTLY PROHIBITED. THE USER OF THIS DRAWING SHALL BE RESPONSIBLE FOR OBTAINING ALL NECESSARY PERMITS AND APPROVALS FROM THE APPROPRIATE AGENCIES. THE USER SHALL BE RESPONSIBLE FOR OBTAINING ALL NECESSARY PERMITS AND APPROVALS FROM THE APPROPRIATE AGENCIES. THE USER SHALL BE RESPONSIBLE FOR OBTAINING ALL NECESSARY PERMITS AND APPROVALS FROM THE APPROPRIATE AGENCIES. THE USER SHALL BE RESPONSIBLE FOR OBTAINING ALL NECESSARY PERMITS AND APPROVALS FROM THE APPROPRIATE AGENCIES.

Order Plans @ www.dilling.com