

ELECTRICAL GENERAL NOTES

- A. ALL 120 VOLT CIRCUITS LONGER THAN 100 FEET IN LENGTH SHALL USE #10 AWG CONDUCTORS.
- B. ALL CIRCUITS SHALL HAVE A SEPARATE GROUNDED CONDUCTOR SIZED PER N.E.C. SECTION 250.122.
- C. ALL CONDUIT INSTALLED INDOORS SHALL BE ELECTRICAL METALLIC TUBING (EMT), MINIMUM 1/2" OR AS NOTED OTHERWISE. CONDUCTORS TO BE A MINIMUM OF #12 THIRTYTHREE (33) UNLESS NOTED OTHERWISE. BRANCHED CIRCUITS WITH NO MARKS OR IDENTIFICATION ARE TO BE PROVIDED WITH ONE HOT, ONE NEUTRAL AND ONE EQUIPMENT GROUND CONDUCTOR.
- D. ELECTRICAL CONTRACTOR SHALL PROVIDE CIRCUIT DIRECTORY WITH TYPED CIRCUIT DESIGNATION CARD UNDER PLASTIC COVER ON THE FRONT OF EACH PANEL DOOR. ELECTRICAL CONTRACTOR SHALL ALSO FURNISH AND INSTALL NAMEPLATES ON ALL DISCONNECT SWITCHES, PANELBOARDS AND SWITCHBOARDS.
- E. ELECTRICAL CONTRACTOR SHALL FURNISH ALL LABOR, MATERIALS, TOOLS, EQUIPMENT AND SERVICES AS NECESSARY FOR THE PROVISION OF ALL WORK INCIDENTAL TO THE FURNISHING AND INSTALLATION, COMPLETE OF ALL WIRING MATERIALS AND METHODS AS SHOWN ON THE DRAWINGS AND AS SPECIFIED IN ACCORDANCE WITH PROVISIONS OF THE CONTRACT DOCUMENTS. ALL WORK SHALL BE COORDINATED WITH WORK OF ALL OTHER TRADES.
- F. FIELD COORDINATE ALL FURNITURE POWER FEED LOCATION PRIOR TO ROUGH-IN AND PLASTIC PROGRAM.
- G. ALL EMPTY CONDUITS SHALL BE PROVIDED WITH PULL STRIPS INSTALLED AND PLASTIC PROGRAMMED.
- H. CONTRACTOR SHALL COORDINATE LOCATION OF ELECTRICAL PANELS WITH THE CEILING TO PROVIDE THE CLEARANCE REQUIRED.
- I. ELECTRICAL CONTRACTOR SHALL VERIFY EXACT PLACEMENT OF ALL DEVICES SHOWN ON THE ELECTRICAL CONTRACT DOCUMENTS WITH ALL DRAWINGS PRIOR TO FINAL INSTALLATION.
- J. DISCONNECT SWITCHES SHALL BE INSTALLED IN PANEL DOORS AND SHALL BE IDENTIFIED TO ALL PANELS BY SPARK TESTER FOR EACH HOMERUN SHOWN IN THESE DRAWINGS.
- K. ALL RECEIPTS SHALL BE IN #2 OF A BIN OR LABORATORY SHALL BE OF A GFCI TYPE.
- L. ALL FIRE ALARMS AND SMOKE DETECTORS LOCATED IN THE SAME ROOM OR OPEN OFFICE AREA SHALL BE SEQUENCED TO FLASH AT THE SAME RATE PER LATEST FIRE ALARM CODE.

ELECTRICAL PLAN NOTES

- 1. INSTALL RECEPTACLE HORIZONTALLY IN RISERWALL AT 3" AFF TO CENTER OF RECEPTACLE. DEVICE AND COVER SHALL BE BLACK. COORDINATE THE EXACT LOCATION WITH THE ARCHITECT (AND/OR PARTIAL HEIGHT WALL PRIOR TO ROUGH-IN). REFER TO THE MISCELLANEOUS ARCHITECTURAL DETAILS, ASDS SERIES DRAWINGS.
- 2. SURFACE MOUNT THE RECEPTACLE HORIZONTALLY ON THE BACK WALL AT 3" AFF TO THE CENTER OF THE RECEPTACLE. THE RECEPTACLE AND COVERPLATE SHALL BE BLACK. PAINT ALL EXPOSED BOXES AND CONDUIT BLACK. COORDINATE THE EXACT LOCATION WITH THE ARCHITECTURAL DETAILS ON THE ASDS SERIES OF DRAWINGS.
- 3. PROJECTOR CONSOLE POWER. MAKE FINAL CONNECTION TO PROJECTOR PER MANUFACTURER'S INSTRUCTIONS. COORDINATE EXACT LOCATION WITH PROJECTOR INSTALLER PRIOR TO ROUGH-IN. REFER TO PROJECTION AREA EQUIPMENT DETAILS AND ELEVATIONS SHEET E701 FOR ADDITIONAL INFORMATION.
- 4. SIGHTSOUND SYSTEM POWER. MAKE FINAL CONNECTION TO SYSTEM RACK PER MANUFACTURER'S INSTRUCTIONS. COORDINATE EXACT LOCATION WITH SYSTEMS RACK INSTALLER PRIOR TO ROUGH-IN. REFER TO PROJECTION AREA EQUIPMENT DETAILS AND ELEVATIONS SHEET E701 FOR ADDITIONAL INFORMATION.
- 5. 4-8, 1-#10 GROUND WIRE IN A 3/4" CONDUIT.
- 6. LUTRON GRAPHIK EYE. COORDINATE INSTALLATION WITH THE PROJECTION EQUIPMENT INSTALLERS. REFER TO PROJECTION AREA EQUIPMENT DETAILS AND ELEVATIONS SHEET E701 FOR ADDITIONAL INFORMATION.
- 7. 3-#6, 2-#10 GROUND WIRES IN A 1" CONDUIT.
- 8. LOW VOLTAGE AISLE LIGHTING POWER SUPPLY FURNISHED BY THE OWNER'S FFE AISLE LIGHTING INSTALLER AND INSTALLED BY THE ELECTRICAL CONTRACTOR. PROVIDE CONDUITS FROM THE POWER SUPPLY TO JUNCTION BOXES SERVING AISLE LIGHTING IN THE ASSOCIATED AUDITORIUM. THE ELECTRICAL CONTRACTOR SHALL INSTALL THE JUNCTION BOXES BASED ON THE AISLE LIGHTING SHOP DRAWINGS. INSTALL LOW VOLTAGE WIRING BETWEEN THE POWER SUPPLY AND THE AUDITORIUM JUNCTION BOXES.
- 9. INSTALL A NEMA SIZE 0 COMBINATION MAGNETIC STARTER/DISCONNECT TO CONTROL THE INDICATED PROJECTOR EXHAUST FAN. DEVICES TO BE IN A NEMA 1 ENCLASURE WITH AN HSDA SELECTOR SWITCH AND A GREEN ON PILOT LIGHT ON THE FRONT OF THE ENCLASURE.
- 10. MAKE POWER CONNECTION TO THE CANOPY MOUNTED AISC SIGN. COORDINATE ROUGH-IN WITH THE SIGN INSTALLER PROVIDING ALL REQUIRED CONNECTIONS. PROVIDE DISCONNECT SWITCH AS REQUIRED.
- 11. ROUTE HOMERUN THROUGH A RELAY IN LIGHTING CONTROL PANEL, LCP2. REFERENCE THE LIGHTING CONTROL PANEL SCHEDULE.



ENGINEERING
 CHIBROK, DRAKE, SCOTT, INC.
 9201 E. 63rd Street, Suite 100
 Raytown, Missouri 64133
 Phone: (816) 336-1290
 Fax: (816) 336-3317
 www.chibrok.com
 CDR/REGISTERED PROFESSIONAL ENGINEER

SHEET LEGEND

| | |
|-------|-------------------------------------|
| 0000 | GENERAL INFORMATION & SCOPE OF WORK |
| 1000 | FOUNDATION & FOUNDATION DETAILS |
| 2000 | EXTERIOR & INTERIOR ELEVATIONS |
| 3000 | BUILDING STRUCTURE |
| 4000 | MECHANICAL & PLUMBING DETAILS |
| 5000 | MECHANICAL & PLUMBING EQUIPMENT |
| 6000 | ELECTRICAL |
| 7000 | MECHANICAL |
| 8000 | MECHANICAL |
| 9000 | MECHANICAL |
| 10000 | MECHANICAL |

MADISON YARDS 8
 AMC NEW BUILD
 905 MEMORIAL DRIVE SE
 ATLANTA, GA 30316

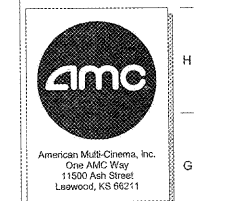

| No. | Date | Description |
|-----|------|-------------|
| | | |
| | | |
| | | |
| | | |
| | | |

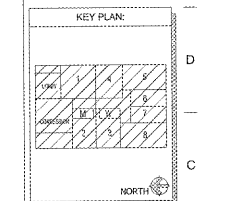

SHEET TITLE:
PROJECTION LEVEL AREA-A POWER PLAN

SHEET NUMBER:
E103

PROJECTION LEVEL AREA A POWER PLAN
 1/8" = 1'-0"

THIS DRAWING IS A PART OF AN INTEGRATED SET OF CONTRACT DOCUMENTS. IT IS TO BE READ IN CONJUNCTION WITH THE GENERAL NOTES AND SPECIFICATIONS. THE CONTRACTOR SHALL BE RESPONSIBLE FOR VERIFYING THE ACCURACY OF ALL INFORMATION SHOWN ON THIS DRAWING. THE CONTRACTOR SHALL BE RESPONSIBLE FOR OBTAINING ALL NECESSARY PERMITS AND APPROVALS. THE CONTRACTOR SHALL BE RESPONSIBLE FOR COORDINATING ALL WORK WITH THE OTHER TRADES. THE CONTRACTOR SHALL BE RESPONSIBLE FOR PROTECTING ALL EXISTING UTILITIES AND STRUCTURES. THE CONTRACTOR SHALL BE RESPONSIBLE FOR MAINTAINING ACCESS TO ALL ADJACENT PROPERTIES. THE CONTRACTOR SHALL BE RESPONSIBLE FOR RESTORING ALL WORK TO ORIGINAL OR BETTER CONDITION. THE CONTRACTOR SHALL BE RESPONSIBLE FOR OBTAINING ALL NECESSARY PERMITS AND APPROVALS. THE CONTRACTOR SHALL BE RESPONSIBLE FOR COORDINATING ALL WORK WITH THE OTHER TRADES. THE CONTRACTOR SHALL BE RESPONSIBLE FOR PROTECTING ALL EXISTING UTILITIES AND STRUCTURES. THE CONTRACTOR SHALL BE RESPONSIBLE FOR MAINTAINING ACCESS TO ALL ADJACENT PROPERTIES. THE CONTRACTOR SHALL BE RESPONSIBLE FOR RESTORING ALL WORK TO ORIGINAL OR BETTER CONDITION.

Order Plans @