

Order Plans @

A1 DIMENSIONED FLOOR PLAN - PROJECTION LEVEL (AREA B)

Q17 NOT USED

No.	WALL TYPE DESCRIPTION
1	(1) LAYER 5/8" GYP. BOARD EACH SIDE OF 3 5/8" METAL STUDS @ 1'-4" OC TO STRUCTURE ABOVE. GYP. BOARD EXTENDS TO 6" ABOVE HIGHEST ADJACENT CEILING.
1A	(1) LAYER 5/8" GYP. BOARD EACH SIDE OF 3 5/8" METAL STUDS @ 1'-4" OC TO HEIGHT INDICATED.
1B	(1) LAYER 5/8" GYP. BOARD EACH SIDE OF 3 5/8" METAL STUDS @ 1'-4" OC TO HEIGHT INDICATED. WITH PAINTED WOOD CAP.
1C	(1) LAYER 5/8" GYP. BOARD EACH SIDE OF 3 5/8" METAL STUDS @ 1'-4" OC TO 6" ABOVE HIGHER PLATFORM SIDE. PAINTED WOOD CAP AND CABLE KAILING.
1D	(1) LAYER 5/8" GYP. BOARD EACH SIDE OF 3 5/8" METAL STUDS @ 1'-4" OC TO STRUCTURE ABOVE WITH BATT INSULATION. GYP. BOARD EXTENDS TO 6" ABOVE HIGHEST ADJACENT CEILING.
1E	(1) LAYER 5/8" GYP. BOARD EACH SIDE OF 3 5/8" METAL STUDS @ 1'-4" OC TO 1'-10" ABOVE HIGHER PLATFORM SIDE WITH BATT INSULATION, PAINTED WOOD CAP.
1FR	(1) LAYER 5/8" TYPE X GYP. BOARD EACH SIDE OF 3 5/8" METAL STUDS @ 1'-4" OC TO STRUCTURE ABOVE. WITH BATT INSULATION. (1 HOUR RATED, UL U419)
1FR2	(2) LAYER 5/8" TYPE X GYP. BOARD EACH SIDE OF 3 5/8" METAL STUDS @ 1'-4" OC TO STRUCTURE ABOVE, WITH BATT INSULATION. (2 HOUR RATED, UL U419)
2	(1) LAYER 5/8" GYP. BOARD ON ONE SIDE OF 3 5/8" METAL STUDS @ 1'-4" OC TO STRUCTURE ABOVE. GYP. BOARD EXTENDS TO 6" ABOVE HIGHEST ADJACENT CEILING. SIDE OF WALL TAG PLACEMENT IN PLAN INDICATES SIDE TO RECEIVE GYP. BOARD.
2A	(1) LAYER 5/8" GYP. BOARD ON ONE SIDE OF 3 5/8" METAL STUDS @ 1'-4" OC TO HEIGHT INDICATED. SIDE OF WALL TAG PLACEMENT IN PLAN INDICATES SIDE TO RECEIVE GYP. BOARD.
2B	(1) LAYER 5/8" GYP. BOARD ON ONE SIDE OF 3 5/8" METAL STUDS @ 1'-4" OC TO STRUCTURE ABOVE WITH BATT INSULATION. GYP. BOARD EXTENDS TO 6" ABOVE HIGHEST ADJACENT CEILING. SIDE OF WALL TAG PLACEMENT IN PLAN INDICATES SIDE TO RECEIVE GYP. BOARD.
3	(1) LAYER 5/8" GYP. BOARD EACH SIDE OF 6" METAL STUDS @ 1'-4" OC TO STRUCTURE ABOVE. GYP. BOARD EXTENDS TO 6" ABOVE HIGHEST ADJACENT CEILING.
3A	(1) LAYER 5/8" GYP. BOARD EACH SIDE OF 6" METAL STUDS @ 1'-4" OC TO STRUCTURE ABOVE, WITH BATT INSULATION. GYP. BOARD EXTENDS TO 6" ABOVE HIGHEST ADJACENT CEILING.
3FR	(2) LAYERS TYPE X 5/8" GYP. BOARD EACH SIDE OF 6" METAL STUDS @ 1'-4" OC TO STRUCTURE ABOVE, WITH BATT INSULATION. (2 HOUR RATED, UL U419)
4	(1) LAYER 5/8" GYP. BOARD ON ONE SIDE OF 3 5/8" METAL STUDS @ 1'-4" OC TO STRUCTURE ABOVE. GYP. BOARD EXTENDS TO 6" ABOVE HIGHEST ADJACENT CEILING. SIDE OF WALL TAG PLACEMENT IN PLAN INDICATES SIDE TO RECEIVE GYP. BOARD.
5	(1) LAYER 5/8" GYP. BOARD EACH SIDE OF 1 3/8" METAL STUDS @ 1'-4" OC TO HEIGHT INDICATED.
6	(1) LAYER 5/8" GYP. BOARD ONE SIDE OF 1 3/8" METAL STUDS @ 1'-4" OC TO HEIGHT INDICATED. WALL TAG PLACEMENT IN PLAN INDICATES SIDE TO RECEIVE GYP. BOARD.
7	(3) LAYERS 5/8" GYP. BOARD ON ONE SIDE OF 6" METAL STUDS @ 1'-4" OC TO STRUCTURE ABOVE, WITH ACOUSTICAL BATT INSULATION. (1) LAYER GYP. BOARD OPPOSITE SIDE. SIDE OF WALL TAG PLACEMENT IN PLAN INDICATES SIDE TO RECEIVE (3) LAYERS GYP. BOARD.
7FR	(3) LAYERS 5/8" GYP. BOARD ON ONE SIDE OF 6" METAL STUDS @ 1'-4" OC TO STRUCTURE ABOVE, WITH ACOUSTICAL BATT INSULATION. (1) LAYER GYP. BOARD OPPOSITE SIDE. SIDE OF WALL TAG PLACEMENT IN PLAN INDICATES SIDE TO RECEIVE (3) LAYERS GYP. BOARD. (2 HOUR RATED, UL U408)
7FR2	(3) LAYERS 5/8" TYPE X GYP. BOARD ON ONE SIDE OF 6" METAL STUDS @ 1'-4" OC TO STRUCTURE ABOVE, WITH ACOUSTICAL BATT INSULATION. (1) LAYER GYP. BOARD OPPOSITE SIDE. SIDE OF WALL TAG PLACEMENT IN PLAN INDICATES SIDE TO RECEIVE (3) LAYERS GYP. BOARD. (2 HOUR RATED, UL U408)
8	(1) LAYER 3/16" WOOD PANEL ON (1) LAYER 1/2" PLYWOOD ON ONE SIDE OF 3 5/8" METAL STUDS @ 1'-4" OC TO HEIGHT INDICATED. SIDE OF WALL TAG PLACEMENT IN PLAN INDICATES SIDE TO RECEIVE GYP. BOARD.
9	(3) LAYERS 5/8" GYP. BOARD ON ONE SIDE OF 3 5/8" METAL STUDS @ 1'-4" OC TO STRUCTURE ABOVE, WITH ACOUSTICAL BATT INSULATION. (1) LAYER GYP. BOARD OPPOSITE SIDE. SIDE OF WALL TAG PLACEMENT IN PLAN INDICATES SIDE TO RECEIVE (3) LAYERS GYP. BOARD.
11A	(2) LAYERS 5/8" GYP. BOARD W/ METAL LATH SANDWICHED BETWEEN ON VAULT SIDE OF 3 5/8" METAL STUDS @ 1'-4" OC TO STRUCTURE ABOVE AND (1) LAYER 5/8" GYP. BD. ON OTHER SIDE, WITH BATT INSULATION. SIDE OF WALL TAG PLACEMENT IN PLAN INDICATES SIDE TO RECEIVE (2) LAYERS GYP. BD.
13	(3) LAYERS 5/8" GYP. BOARD EACH SIDE OF (2) ROWS OF 6" METAL STUDS @ 1'-4" OC TO STRUCTURE ABOVE, 6" ACOUSTICAL BATT INSULATION IN (1) STUD CAVITY.
13A	(1) LAYER 5/8" GYP. BOARD EACH SIDE OF (2) ROWS OF 6" METAL STUDS @ 1'-4" OC TO STRUCTURE ABOVE.
14	(3) LAYERS 5/8" GYP. BOARD AUDITORIUM SIDE AND (1) LAYER 5/8" GYPSUM BOARD OTHER SIDE OF (2) ROWS OF 6" METAL STUDS @ 1'-4" OC TO STRUCTURE ABOVE, 6" ACOUSTICAL BATT INSULATION IN (1) STUD CAVITY.
14FR1	(3) LAYERS 5/8" TYPE X GYP. BOARD AUDITORIUM SIDE AND (1) LAYER 5/8" GYPSUM BOARD OTHER SIDE OF (2) ROWS OF 6" METAL STUDS @ 1'-4" OC TO STRUCTURE ABOVE, 6" ACOUSTICAL BATT INSULATION IN (1) STUD CAVITY.
15	2" ACOUSTICAL INSULATION - FOLL GLASS-FIBER BOARD INSULATION
16	(1) LAYER 5/8" GYP. BOARD EACH SIDE OF 3 5/8" METAL STUDS @ 1'-4" OC WITH 5/8" PLYWOOD ONE SIDE TO STRUCTURE ABOVE. GYP. BOARD AND PLYWOOD EXTENDS TO 6" ABOVE HIGHEST ADJACENT CEILING. WALL TAG PLACEMENT IN PLAN INDICATES SIDE OF PLYWOOD.
19	(1) LAYER 5/8" GYP. BOARD ON ONE SIDE OF 2 3/8" METAL STUDS @ 1'-4" OC TO STUD ABOVE. SIDE OF WALL TAG PLACEMENT IN PLAN INDICATES SIDE TO RECEIVE GYP. BOARD.

D17 WALL TYPE LEGEND

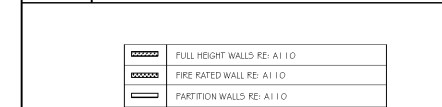

- 1. RE: FS-SHEETS FOR DETAILED INFORMATION ON FOOD SERVICE EQUIPMENT.
- 2. RE: MECHANICAL AND ELECTRICAL SHEETS FOR EQUIPMENT AND FUTURE SCHEDULES.



SHEET LEGEND

GENERAL INFORMATION & SCOPES OF WORK
 GENERAL ARCHITECTURAL DETAILS
 FLOOR PLANS & CEILING PLANS
 SECTION & INTERIOR ELEVATIONS
 BUILDING SECTIONS
 FINISHED PLANS
 EXTERIOR & INTERIOR DETAILS
 FLOOR SCHEDULES, DOOR SCHEDULES
 FLOOR SCHEDULES, WINDOW SCHEDULES
 AUDITORIUM LIGHT LINE SCHEDULES

STRUCTURAL
 MECHANICAL
 ELECTRICAL
 PLUMBING
 FIRE PROTECTION
 WARDING DETAILS
 CASEWORK & EQUIPMENT
 FINISH

AMC MADISON YARDS 8

AMC NEW BUILD
 906 MEMORIAL DR SE
 ATLANTA, GA 30316



No.	Date	Description

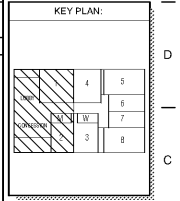

SHEET TITLE:
 DIMENSIONED FLOOR PLAN - PROJECTION

SHEET NUMBER:
 A133

A17 GENERAL NOTES

1/8" = 1'-0"