

1 ENLARGED TELECOMMUNICATIONS ROOM 103 ROUGH-IN PLAN

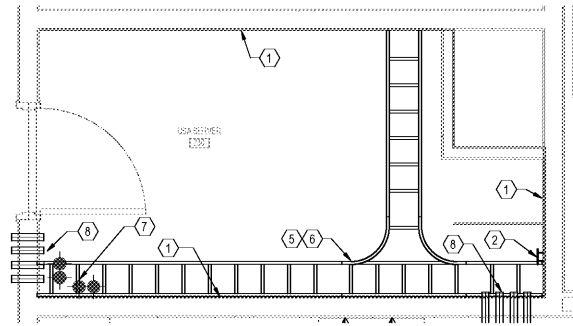

3 ENLARGED SERVER ROOM 230 ROUGH-IN PLAN

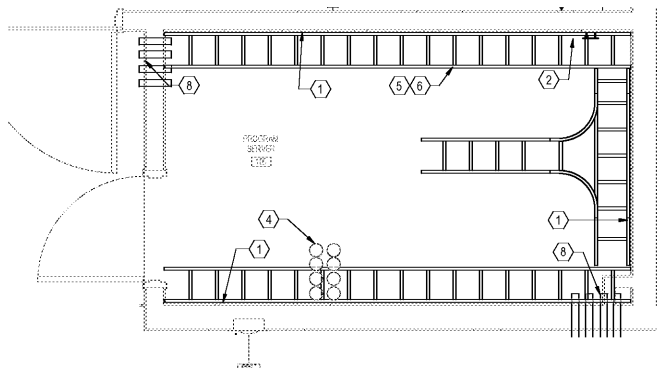

2 ENLARGED SERVER ROOM 105 ROUGH-IN PLAN

ENLARGED FLOOR PLAN KEY NOTES

- (1)** TELECOMMUNICATIONS MAIN GRPLYWOOD BACKBOARD, 8'-0" HIGH X FULL LENGTH OF WALL, MOUNT WITH BOTTOM AT 6" ABOVE FINISH FLOOR. ROUGH ALL ELECTRICAL OUTLETS IN BACKBOARD FOR FLUSH MOUNT INSTALLATION OF FACEPLATES. BACKBOARDS SHALL BE 3/4" THICK AC EXTERIOR GRADE PLYWOOD. COUNTERSINK ALL SCREWS. PRIME WITH TWO COATS PRIMER, SANDING SMOOTH AFTER EACH COAT FINISH WITH TWO COATS SEMI-GLOSS ENAMEL FIRE-RETARDANT PAINT, COLOR BATTLESHIP GREY. FINAL SURFACE SHALL BE UNIFORMLY SMOOTH AND EVEN. TOUCH UP AT END OF PROJECT. COORDINATE WORK WITH ELECTRICAL CONTRACTOR TO ENSURE THAT POWER RECEPTACLES ARE PROPERLY LOCATED AND WITH FACEPLATES FLUSH ON FACE OF BACKBOARD.
- (2)** GROUNDING BUSBAR, WITH TWO ROWS OF 7/16" HOLES AT 1' SPACING EACH WAY. MAKE ALL CONNECTIONS WITH TWO HOLE LONG BARREL COMPRESSION LUGS AND BOND TO BUSBAR WITH TWO 3/8" SS HEX HEAD CAP SCREWS WITH SS LOCKING NUTS. SEE "GROUNDING NOTE" AND "VOICE SYSTEM SINGLE LINE DIAGRAM". ROUTE 3/4" EMT CONDUIT TO BUILDING MAIN ELECTRICAL PANEL FOR GROUNDING CONDUCTOR WITH INSULATED GROUNDING BUSHING.
- (3)** COMMUNICATIONS BACKBONE CONDUIT. SEE ELECTRICAL SITE PLAN.
- (4)** COMMUNICATIONS HORIZONTAL CABLING SLEEVE TO FLOOR BELOW. PROVIDE (4) 4" CONDUITS TO FLOOR BELOW. PROVIDE END BELL BUSHING.
- (5)** 12" WIDE CABLE RUNWAY, CHATSWORTH 10250-712 OR EQUAL, COLOR BLACK. PROVIDE BUTT-SPLICE KIT TO BUTT-SPLICE SECTIONS OF CABLE RUNWAY (PAINT BEFORE INSTALLING AND TOUCH UP AFTER INSTALLATION). INSTALL ALL CABLE RUNWAY, FITTINGS, AND ACCESSORIES IN ACCORDANCE WITH MANUFACTURER'S PRINTED INSTRUCTIONS, TYPICAL. PROVIDED AND INSTALLED BY USA IT DEPARTMENT.
- (6)** 12" CABLE RUNWAY WALL ANGLE SUPPORT KIT, CHATSWORTH 11421-712 OR EQUAL, COLOR BLACK. CABLE RUNWAY JOINT SPLICE KIT, CHATSWORTH 16298-001 OR EQUAL. CEILING SUPPORT BRACKET, CHATSWORTH 11310-003 OR EQUAL. COLOR BLACK, TYPICAL. PROVIDED AND INSTALLED BY USA IT DEPARTMENT.
- (7)** 12" WIDE CABLE RUNWAY, CHATSWORTH 10250-712 OR EQUAL. MOUNTED VERTICALLY FROM CONDUIT ENTRANCE IN FLOOR TO 7'-0". SEE "TYPICAL VERTICAL CABLE RUNWAY DETAIL". CABLE TRAY ENTERING ROOM AND TURNING DOWN WALL TO CABLE RUNWAY. CEILING TELEPHONE CABLE TRAY ENTRANCE. PROVIDED AND INSTALLED BY USA IT DEPARTMENT.
- (8)** PROVIDE (4) 4" MECHANICAL SLEEVES PER RESTOP.

GENERAL NOTES

1. COMMUNICATIONS OUTLETS, ROUGH-IN, AND NOTES ARE SHOWN FOR ROUGH-IN CONDITIONS. JACKBOXES, AND PULL STRINGS ONLY. ALL ASSOCIATED REFERENCE TO CABLES, INSTALLATION, AND TERMINATION ARE FOR REFERENCE ONLY.

SCHMIDT
CONSULTING GROUP, INC.
MECHANICAL, ELECTRICAL, STRUCTURAL,
COMMUNICATIONS, INDUSTRIAL
ALABAMA LICENSE NUMBER 2717
WITH CORRECTION NUMBER 217, 2320
FLORIDA LICENSE # F2544226437
TODD MC HOLSON P.E.
ALABAMA LICENSE NUMBER 29943-E
SC19 PROJECT: 2018-131

2701 1st Avenue S
Birmingham, AL 35233
T 205.879.4462
ONCNETWORK.COM

ISSUE DATE
ISSUE FOR BID: 2018.05.25
DRAWN BY: CEC
CHECKED BY: TAN

SIMULATION LABORATORY
BUILDING - USA JOB #16-07
MOBILE, ALABAMA
ABC #2017372
GMC # AMOB160019



ENLARGED
TELECOMMUNICATIONS
ROUGH-IN PLANS

E507
Sheet 1 of 1

Order Plans @ WWW.ONCNETWORK.COM