

**SHEET NOTES**

① AREA OF REFUGE CALL BOX EQUAL TO RATH #200-965NSIP VOIP CALL BOX, CONTRACTOR TO PROVIDE ALL ACCESSORIES AND WIRING AS REQUIRED FOR FULLY OPERATION SYSTEM.

**SCHMIDT**  
CONSULTING GROUP, INC.  
MECHANICAL, ELECTRICAL, STRUCTURAL, COMMUNICATIONS, INDUSTRIAL  
ALABAMA LICENSE NUMBER 2018-005-25  
WITH CORRECTION NUMBER 17-2520  
P.O. BOX 480000 • FPO 354-234671  
TODD NICHOLSON, P.E.  
ALABAMA LICENSE NUMBER 29943-E  
SIC PROJECT: 2018-151

2701 1st Avenue S  
Birmingham, AL 35233  
T 205.879.4462  
GMCNETWORK.COM

ISSUE	DATE
ISSUE FOR BID	2018.05.25

DRAWN BY: JTH  
CHECKED BY: TAN

SIMULATION LABORATORY  
BUILDING - USA JOB #16-07  
MOBILE, ALABAMA  
ABC #2017372  
GMC # AMOB160019



**2ND FLOOR SYSTEMS PLAN**  
**E502**  
Sheet    of   

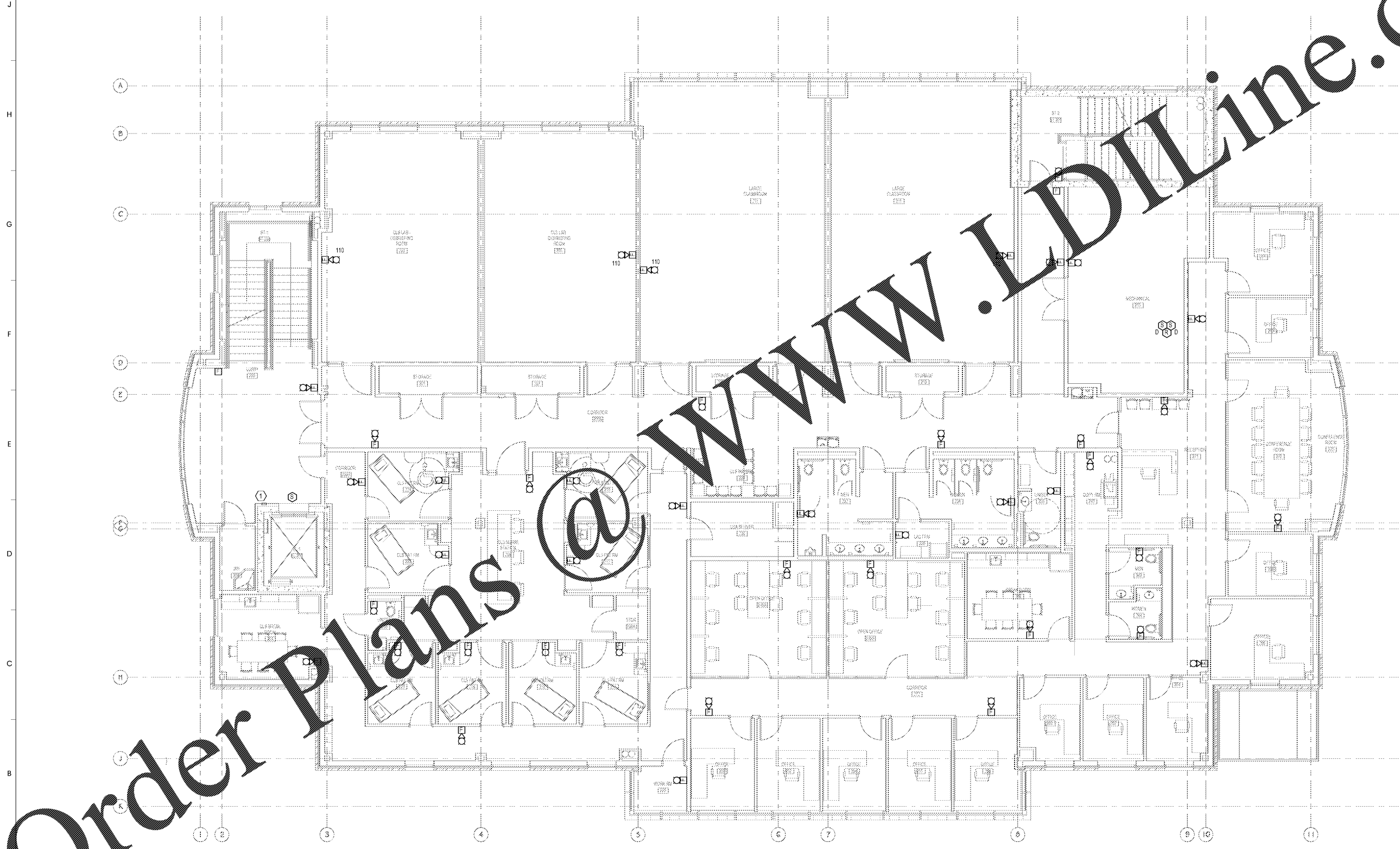

PLAN NORTH  
1  
**2ND FLOOR SYSTEMS PLAN**  
SCALE: 3/16"=1'-0"

Order Plans @ [WWW.LDLINE.COM](http://WWW.LDLINE.COM)