

5/23/2018 8:01:47 AM

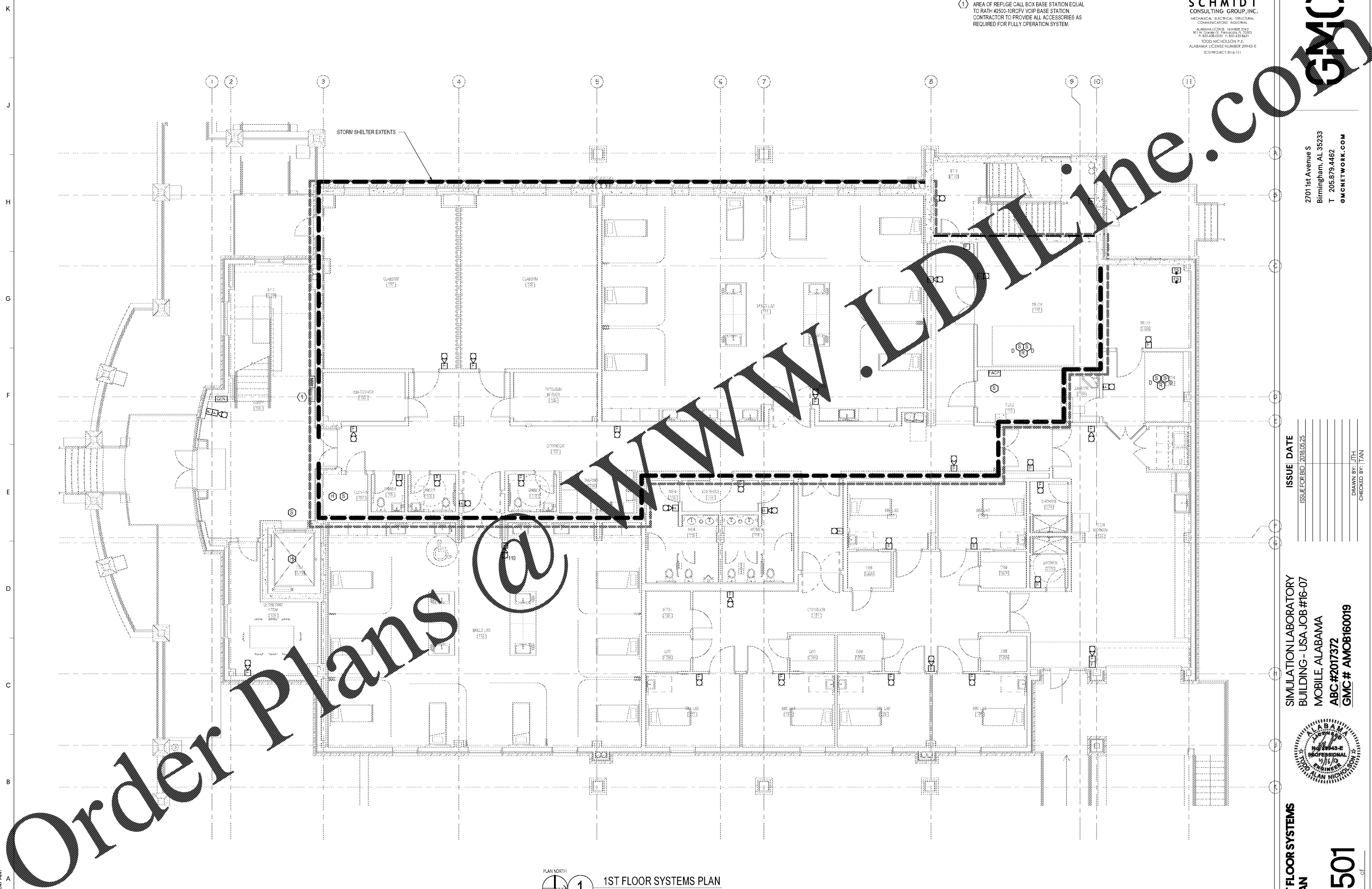

SHEET NOTES

- (1) AREA OF REFUGE CALL BOX BASE STATION EQUAL TO RATH #2500-1URCEV VOIP BASE STATION. CONTRACTOR TO PROVIDE ALL ACCESSORIES AS REQUIRED FOR FULLY OPERATION SYSTEM.

SCHMIDT
CONSULTING GROUP, INC.
MECHANICAL ELECTRICAL STRUCTURAL
COMMUNICATIONS INDUSTRIAL
ALABAMA LICENSE NUMBER 2212
WITH CORRECTION PERMITTED 7/2009
P. 830.486.000 F. 854.428.637
TODD NICHOLSON P.E.
ALABAMA LICENSE NUMBER 29943-E
SCG PROJECT 2016-131

2701 1st Avenue S
Birmingham, AL 35233
T 205.879.4462
GMCNETWORK.COM

ISSUE	DATE
ISSUE FOR BID	2018.05.25

DRAWN BY: JTH
CHECKED BY: TAN

SIMULATION LABORATORY
BUILDING - USA JOB #16-07
MOBILE, ALABAMA
ABC #2017372
GMC # AMOB160019



1ST FLOOR SYSTEMS PLAN

E501

Sheet of

Order Plans @

WWW.LDLINE.COM

PLAN NORTH
1 1ST FLOOR SYSTEMS PLAN
SCALE 3/16"=1'-0"