

SHEET NOTES

- ① PROVIDE LIGHT SCENE CONTROLLER SWITCH FOR CONTROL OF SIMULATION LAB LIGHTING. REFER TO SWITCH DETAILS FOR ADDITIONAL REQUIREMENTS. SCENE ONE SHALL BE LIGHTS ALL ON, SCENE TWO SHALL TURN ALL LIGHTS OFF EXCEPT FOR EMERGENCY FIXTURE. SCENE THREE SHALL TURN ALL LIGHTS TO 50%, SCENE 4 SHALL TURN ALL LIGHTS OFF.
- ② RELAY SHALL BE PROGRAMMED TO ZONE 1
- ③ RELAY SHALL BE PROGRAMMED TO ZONE 2
- ④ RELAY SHALL BE PROGRAMMED TO ZONE 3 IF FOLDING PARTITION ADD ALTERNATE IS SELECTED. RELAY SHALL BE PROGRAMMED TO ZONE 1 UNDER BASE BID.
- ⑤ IF FOLDING PARTITION ADD ALTERNATE IS SELECTED THEN WHEN PARTITION IS OPEN, ZONE 1 IN BOTH ROOMS SHALL BE COMBINED INTO A SINGLE ZONE, ZONE 2 IN BOTH ROOMS SHALL BE COMBINED INTO A SINGLE ZONE, AND ZONE 3 IN BOTH ROOMS SHALL BE COMBINED INTO A SINGLE ZONE.
- ⑥ LIGHT OUTPUT: 100% ON NORMAL SCENE, 30% ON EMERGENCY SCENE, AND 50% ON 50% SCENE. REFER TO DETAIL 3/E603 FOR SWITCH LV3 DETAILS AND SHEET NOTE 1, THIS SHEET.
- ⑦ LIGHT OUTPUT: 100% ON NORMAL SCENE, OFF ON EMERGENCY SCENE, AND 50% ON 50% SCENE. REFER TO DETAIL 3/E603 FOR SWITCH LV3 DETAILS AND SHEET NOTE 1, THIS SHEET.
- ⑧ RELAY PROVIDED UNDER FOLDING PARTITION ADD ALTERNATE AND SHALL BE PROGRAMMED TO ZONE 1

SCHMIDT
CONSULTING GROUP, INC.
MECHANICAL ELECTRICAL STRUCTURAL
COMMUNICATIONS INDUSTRIAL
ALABAMA LICENSE NUMBER 2742
NINA COOPER, P.E. FERRISBURG, AL 35233
P: 205.879.4462 F: 205.879.4461
TODD NICHOLSON, P.E.
ALABAMA LICENSE NUMBER 29943-E
SCHMIDT PROJECT 2016-151

2701 1st Avenue S
Birmingham, AL 35233
T 205.879.4462
GMCNETWORK.COM

ISSUE DATE	ISSUE FOR BID
2018.05.25	

SIMULATION LABORATORY
BUILDING - USA JOB #16-07
MOBILE, ALABAMA
ABC #2017372
GMC # AMOB160019



1ST FLOOR LIGHTING
CONTROL PLAN
E204
Sheet of

5/24/2018 9:50:50 AM

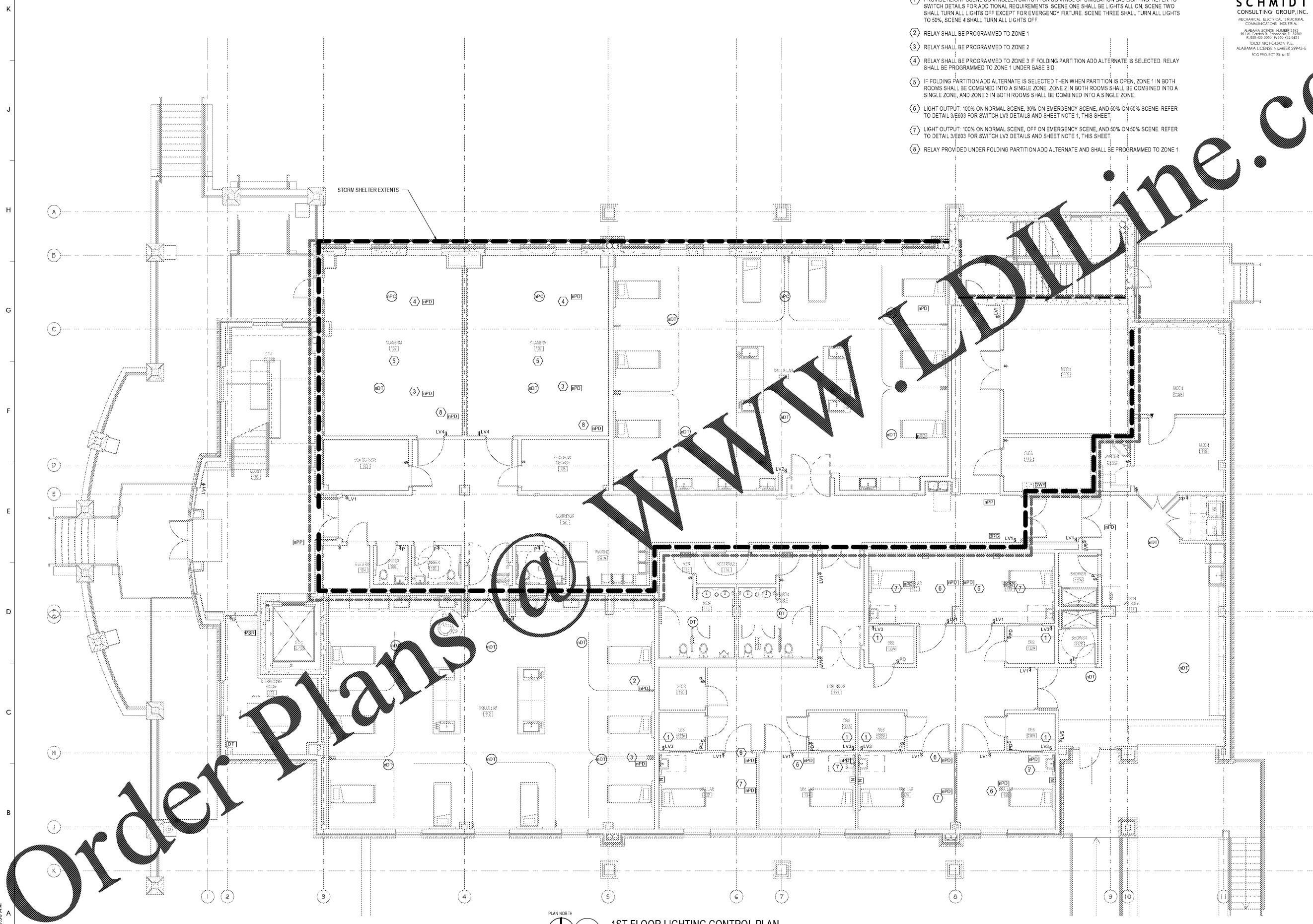

PLAN NORTH
1 1ST FLOOR LIGHTING CONTROL PLAN
SCALE: 3/16"=1'-0"