

GENERAL NOTES

1. ALL VENT PIPING PENETRATING THE STORM SHELTER WALLS ARE 2"Ø OR SMALLER AND THUS ARE NOT REQUIRED TO BE PROTECTED PER ICC 500-2014 SECTION 306.3.

SHEET NOTES

- 1) SUMP PUMP (SP): PROVIDE 24"X24" PIT FOR SUMP PUMP. COORDINATE WITH STRUCTURAL. ROUTE 1.5" DISCHARGE PIPE FROM THE SUMP PUMP TO FLOOR DRAIN IN JANITOR CLOSET. SEE DETAIL 4 ON P5.01
- 2) ROUTE SECONDARY ROOF DRAINAGE SYSTEM TO DOWNSPOUT. NOZZLE SIMILAR TO JR SMITH MODEL 1770. PROVIDE NOZZLE WITH NICKEL BRONZE FINISH.
- 3) LOCATE WALL CLEANOUT BELOW LAVATORY.
- 4) EXTENTS OF TORNADO SHELTER.

- 5) PROVIDE AAV.
- 6) APPROXIMATE LOCATION OF DROP IN ELEVATION IN ORDER FOR SANITARY TO COME OUT BELOW GRADE. SEE A4.01 FOR BUILDING SECTIONS. AND SEE CIVIL FOR ELEVATION CHANGES.
- 7) COORDINATE INVERT ELEVATION WITH GRADE ELEVATION AND STRUCTURAL FOOTER DEPTH. GRADE ELEVATION HAS FREQUENT CHANGES.
- 8) PROVIDE OIL WATER SEPARATOR. OIL WATER SEPARATOR SHALL BE SIZED FOR 50 GPM FLOW RATE, 30 GAL. CAPACITY, AND HAVE 3" INLET AND OUTLET SIZE. SEPARATOR SHALL BE EPOXY COATED FABRICATED STEEL WITH AN INTERNAL TRAP, SEDIMENT BUCKET, TWO VENT CONNECTIONS ON EACH SIDE. GASKETED NON-SKID COVER AND FLOW CONTROL FITTING.
- 9) LOCATE FLOOR DRAIN UNDERNEATH THE ICE MAKER.



2701 1st Avenue S
Birmingham, AL 35233
T 205.879.4462
OMCNETWORK.COM

| ISSUE DATE | ISSUE FOR BID |
|------------|---------------|
| | 2018.05.25 |

SIMULATION LABORATORY
BUILDING - USA JOB #16-07
MOBILE, ALABAMA
ABC #2017372
GMC # AMOB160019



LEVEL 1 - WASTE AND VENT PLAN
P1.01
Sheet of

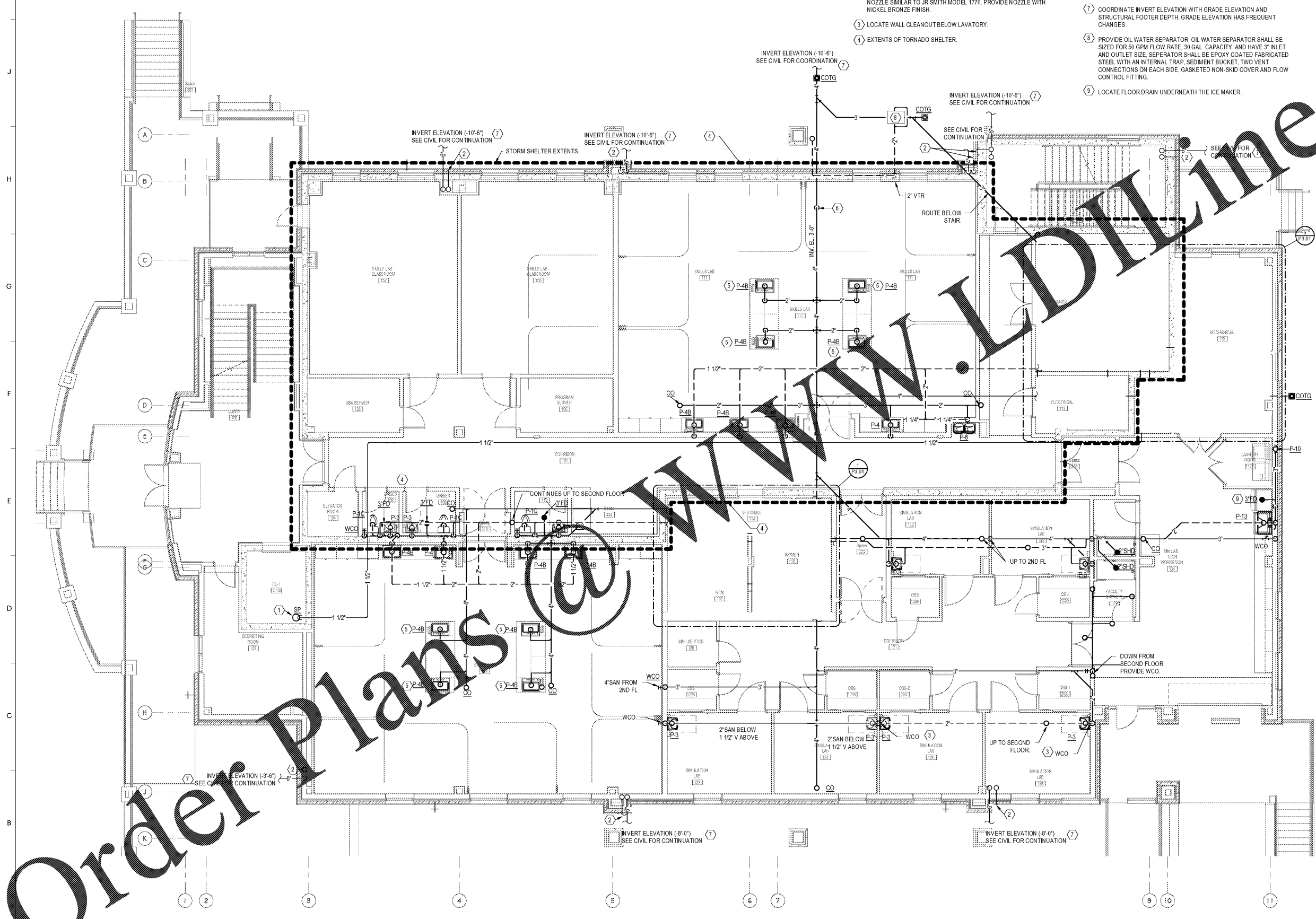

Order Plans @ WWW.LDLINE.COM