

University of South Alabama Spoils Area

Area Unit in Acres

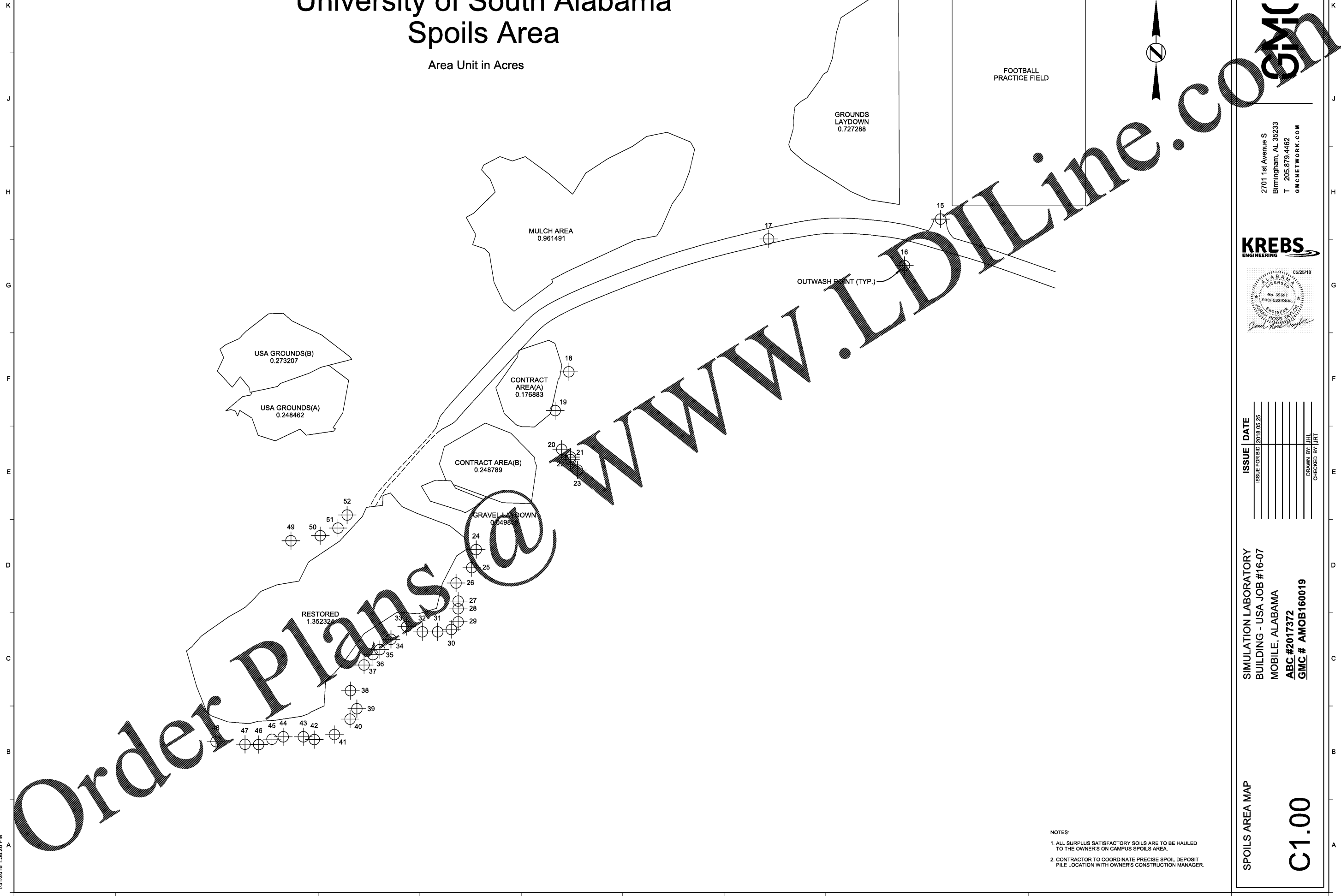

Order Plans @

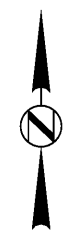

GMC

2701 1st Avenue S
Birmingham, AL 35233
T 205.879.4462
GMCNETWORK.COM

KREBS
ENGINEERING



ISSUE	DATE
ISSUE FOR BID	2018.05.25

DRAWN BY: JHL
CHECKED BY: JRT

SIMULATION LABORATORY
BUILDING - USA JOB #16-07
MOBILE, ALABAMA
ABC #2017372
GMC # AMOB160019

SPOILS AREA MAP
C1.00

- NOTES:
1. ALL SURPLUS SATISFACTORY SOILS ARE TO BE HAULED TO THE OWNER'S ON CAMPUS SPOILS AREA.
 2. CONTRACTOR TO COORDINATE PRECISE SPOIL DEPOSIT PILE LOCATION WITH OWNER'S CONSTRUCTION MANAGER.