

Order Plans @

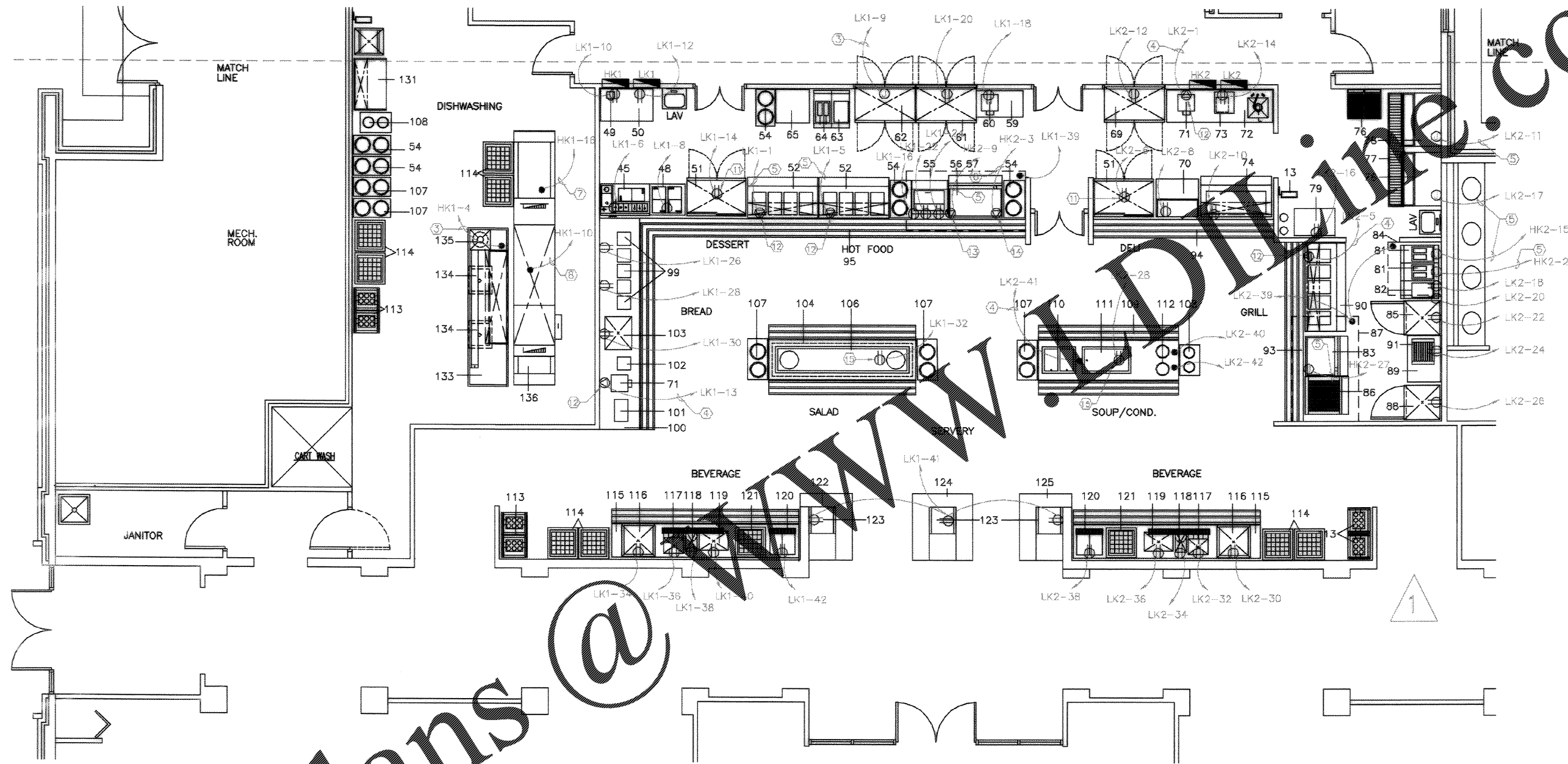

KITCHEN AND SERVERY ELECTRICAL PLAN

1/4"=1'-0"

KEY NOTES (APPLIES TO E402 AND E403 ONLY)

- | | |
|-----------------------------------|---|
| ① DISCONNECT SWITCH, 30/3R/20AF | ⑨ 3-#4/0, 1-#4GND, 2 1/2" C |
| ② DISCONNECT SWITCH, 60/3/3R/40AF | ⑩ MOUNT RECEPTACLE 8" A.F.F. ON 2 RIGID STEEL CONDUITS |
| ③ 2-#12, 1-#12GND, 1/2" C | ⑪ RECEPTACLE ON S.O. CORD FROM CEILING @ 80" A.F.F. |
| ④ 2-#10, 1-#10GND, 3/4" C | ⑫ RECEPTACLE, 30A, 208V, 1ϕ |
| ⑤ 3-#10, 1-#10GND, 3/4" C | ⑬ RECEPTACLE, 30A, 480V, 3ϕ |
| ⑥ 3-#8, 1-#10GND, 3/4" C | ⑭ RECEPTACLE, 40A, 480V, 3ϕ |
| ⑦ 3-#6, 1-#8GND, 1" C | ⑮ MOUNT RECEPTACLE 10" A.F.F. ON 2 RIGID STEEL CONDUITS |
| ⑧ 3-#2, 1-#8GND, 1 1/4" C | |

Click/Boehm & Assoc.
160
247 Meeting St.
Charleston, S.C. 29403
6377

Rev.	Description	Prep. By	Date	Appr.
1	AS-BUILT DRAWING NO CORRECTIONS	BOEHM	10/14/04	BOEHM

CHARLESTON AIR FORCE BASE
CHARLESTON, SOUTH CAROLINA
DINING FACILITY
KITCHEN AND SERVERY ELECTRICAL PLAN
APPROVED: BDM/RE DATE: 10/14/04
ED FOR COMMANDER, WAFAC

Naval Facilities Engineering Command
Southern Division
Charleston, South Carolina

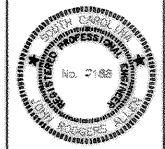

RECORD DRAWING DATE	9/27/04
CODE LD. NO.	80831
DRAWING SIZE:	D
SPEC. NO.	06-96-0939
CONSTN. CONTR. NO.	N62467-98-C-0939
NAVFAC DRAWING NO.	5358005
SHEET 180 OF 194	

E-403