

ELECTRICAL FIRST FLOOR PLAN - BUILDING 475
(CHILLER PLANT REPLACEMENT OPTION)
SCALE: 1/8" = 1'-0"

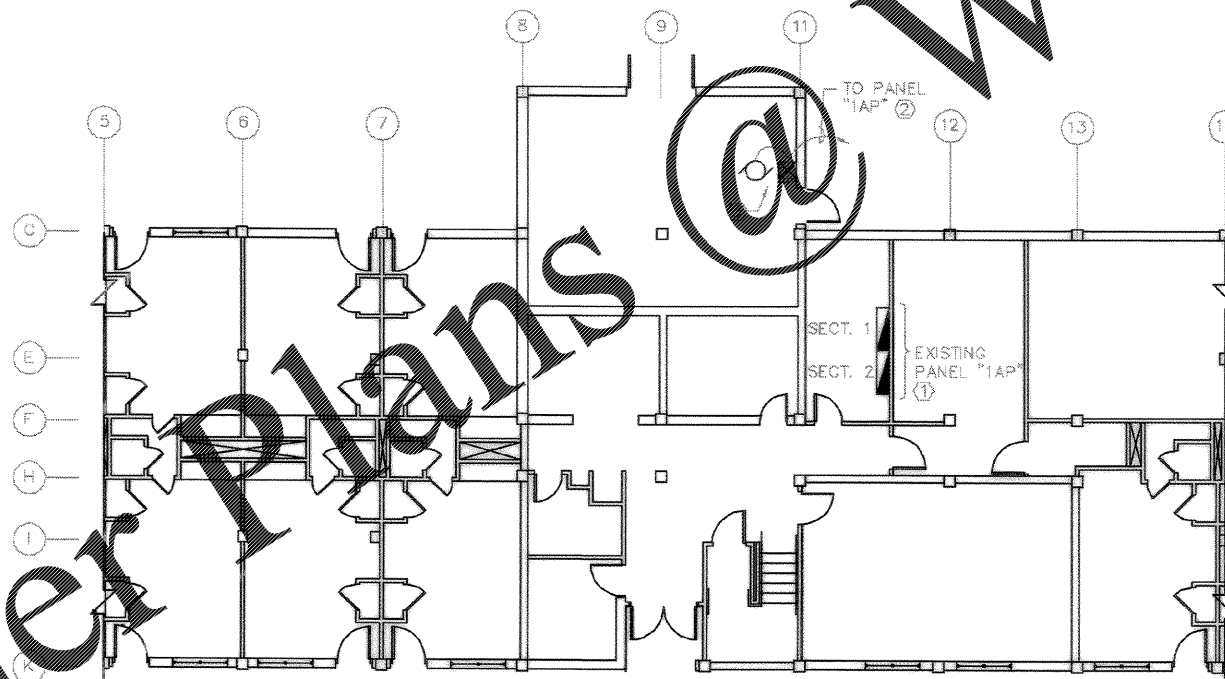

ELECTRICAL FIRST FLOOR PLAN - BUILDINGS 464, 466 & 473
(CHILLER PLANT REPLACEMENT OPTION)
SCALE: 1/8" = 1'-0"

KEYED NOTES: (THIS SHEET ONLY)

- ① IN SECTION 2 OF EXISTING PANEL "1AP", REPLACE THE EXISTING 15A/3P BREAKER IN SPACES 73, 75, 77 WITH A 50A/3P BREAKER. PANEL "1AP" IS A 250A MLO, 208Y/120V, 3Ø, 4W PANEL (SIEMENS TYPE S1C42ML250CTS).
- ② REMOVE EXISTING WIRING (3#12, 1ØG) FROM EXISTING PANEL. PROVIDE NEW WIRING (3#10, 1ØG) EXISTING 1/2" EMT. AND CONNECT TO NEW 50A/3P BREAKER.
- ③ REMOVE EXISTING NEMA 0 COMBINATION STARTER. CONNECT NEW WIRING TO NEW VARIABLE SPEED DRIVE AND PUMP. VARIABLE SPEED DRIVE AND PUMP ARE PROVIDED UNDER DIVISION 15000, AND WILL BE IN APPROXIMATELY THE SAME LOCATION AS THE OLD STARTER AND THE OLD PUMP.
- ④ EXISTING 20A/3P BREAKER IN PANEL "HP" AND EXISTING CIRCUIT WILL BE LEFT IN PLACE TO SERVE NEW VARIABLE SPEED DRIVE AND PUMP.
- ⑤ REMOVE EXISTING 30A DISCONNECT SWITCH AND NEMA 0 COMBINATION STARTER. CONNECT/EXTEND EXISTING 120A 3-PHASE CIRCUIT TO NEW VARIABLE SPEED DRIVE AND PUMP. THE VARIABLE SPEED DRIVE AND PUMP ARE PROVIDED UNDER DIVISION 15000, AND WILL BE IN APPROXIMATELY THE SAME LOCATIONS AS THE OLD STARTER AND THE OLD PUMP.

Click/Boehm & Associates
247 Meeting Street
Charleston, S.C. 29401
Tel: 843.723.0377
Fax: 843.723.0378
www.clickboehm.com

Rev.	Description	Prep. By	Date	Appr. By
1	As-Noted	AKH	1/14/14	AKH

CHARLESTON AIR FORCE BASE
DINING FACILITY
ELECTRICAL PLANS - BLDGS. 464, 466, 473 & 475
APPROVED: *[Signature]* PE
ED: EDI COMANER, IN/614

Novel Facilities Engineering Command
Southern Division
Charleston, South Carolina



GRAPHIC SCALE

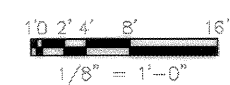

RECORD DRAWING DATE	9/27/14
CODE LIB. NO.	80081
DRAWING SIZE	D
SPEC. NO.	D6-98-0938
CONSTN. CNTR. NO.	N62-87-86-C-0938
NAVAFAC DRAWING NO.	5358002
SHEET 177 OF 194	

F-109

Order Plans

WWW.LDOnline.com