

Order Plans

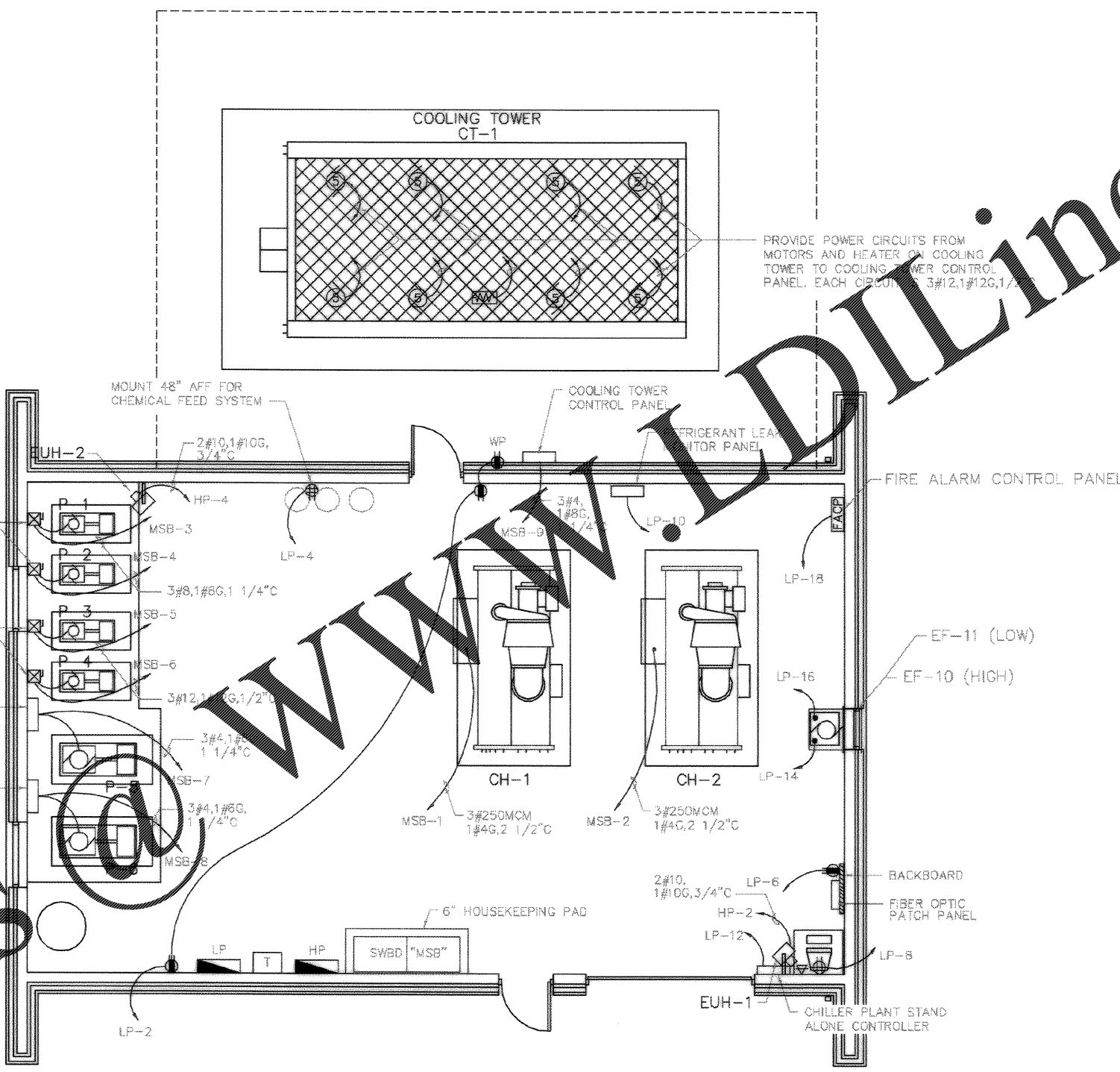

CHILLER PLANT POWER PLAN (CHILLER PLANT REPLACEMENT OPTION)
SCALE: 1/4" = 1'-0"

PROVIDE POWER CIRCUITS FROM MOTORS AND HEATER ON COOLING TOWER TO COOLING TOWER CONTROL PANEL. EACH CIRCUIT 3#12,1#12G,1#12

<p>APPROVED: <i>[Signature]</i> DATE: 5/11/14</p> <p>EDD FOR COMMANDER, NAVFAC</p>											
<p>CHARLESTON AIR FORCE BASE CHARLESTON, SOUTH CAROLINA</p> <p>DINING FACILITY</p> <p>CHILLER PLANT POWER PLAN</p>											
<p>Naval Facilities Engineering Command Southern Division Charleston, South Carolina</p>											
<p>EPIC ENGINEERING INC. No. C00259</p>											
<p>RECORD DRAWING DATE: 9/27/14</p> <p>CODE I.D. NO.: B08S1</p> <p>DRAWING SIZE: D</p> <p>SPEC. NO.: 06-98-0939</p> <p>CONSTR. CONTR. NO.: N02467-98-C-0939</p> <p>NAVFAC DRAWING NO.: 5388000</p> <p>SHEET 175 OF 194</p>											
<p>E-107</p>											
<p>DRAWING REVISIONS</p> <table border="1"> <thead> <tr> <th>Rev.</th> <th>Description</th> <th>Prep. By</th> <th>Date</th> <th>Appr. By</th> </tr> </thead> <tbody> <tr> <td>1</td> <td>AS-BUILT WITH NO CORRECTIONS</td> <td>ALLEN</td> <td>5/11/14</td> <td>ALLEN</td> </tr> </tbody> </table>		Rev.	Description	Prep. By	Date	Appr. By	1	AS-BUILT WITH NO CORRECTIONS	ALLEN	5/11/14	ALLEN
Rev.	Description	Prep. By	Date	Appr. By							
1	AS-BUILT WITH NO CORRECTIONS	ALLEN	5/11/14	ALLEN							
<p>Glick/Boehm & Associates, Inc. 247 Meeting Street, Suite 401 Charleston, S.C. 29403 (803) 577-6377</p> <p>DESIGNED BY: ALLEN CHECKED BY: ALLEN SUBMITTED BY: ALLEN TECHNICAL MANAGER: ALLEN DATE: 5/11/14</p>											