

Order Plans @

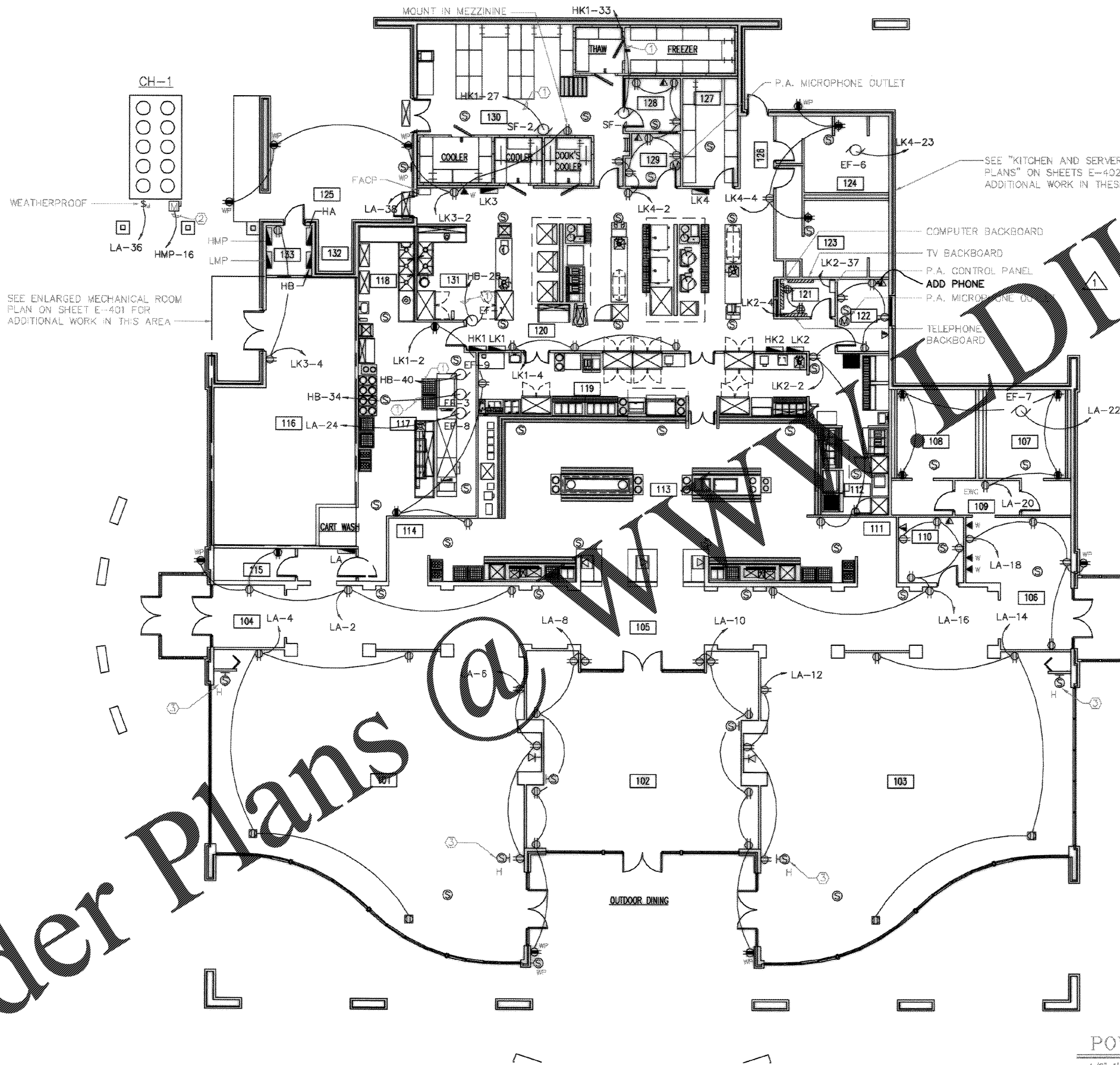

- KEYED NOTES (THIS SHEET ONLY)
- ① 3#12, 1#12G, 1/2" C
 - ② 3#4/0, 1#4G, 2" C
 - ③ MOUNT AS HIGH AS PRACTICAL ON WALL.

POWER PLAN
1/8"=1'-0"

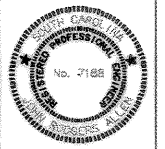

RECORD DRAWING DATE	9/27/14
CODE ID NO.	8081
DRAWING SIZE	D
SPEC. NO. D6-88-0338	
CONSTN. CONTR. NO. N62467-88-C-0339	
NAVFAC DRAWING NO. 535799B	
SHEET 173 OF 184	
E-105	

Naval Facilities Engineering Command
Southern Division
Charleston, South Carolina

CHARLESTON AIR FORCE BASE CHARLESTON, SOUTH CAROLINA
DINING FACILITY
POWER PLAN
APPROVED: *RD/Minors PE* DATE: *5/14/14* EEP FOR COMMANDER, NAVFAC

NO.	DESCRIPTION	DATE	BY	CHK'D BY
1	DWG. CORRECTED TO AS-BUILT	11/11/14	WJW	WJW

DRAWING REVISIONS

Prep By: *WJW*
Date: *11/11/14*

Checked By: *WJW*
Date: *11/11/14*

Scale: *1/8"=1'-0"*

Project: *CHARLESTON AIR FORCE BASE*

Sheet: *E-105*

Drawn By: *WJW*

Checked By: *WJW*

Scale: *1/8"=1'-0"*

Project: *CHARLESTON AIR FORCE BASE*

Sheet: *E-105*

WWW.DILine.com