

Order Plans @ [www.dline.com](http://www.dline.com)

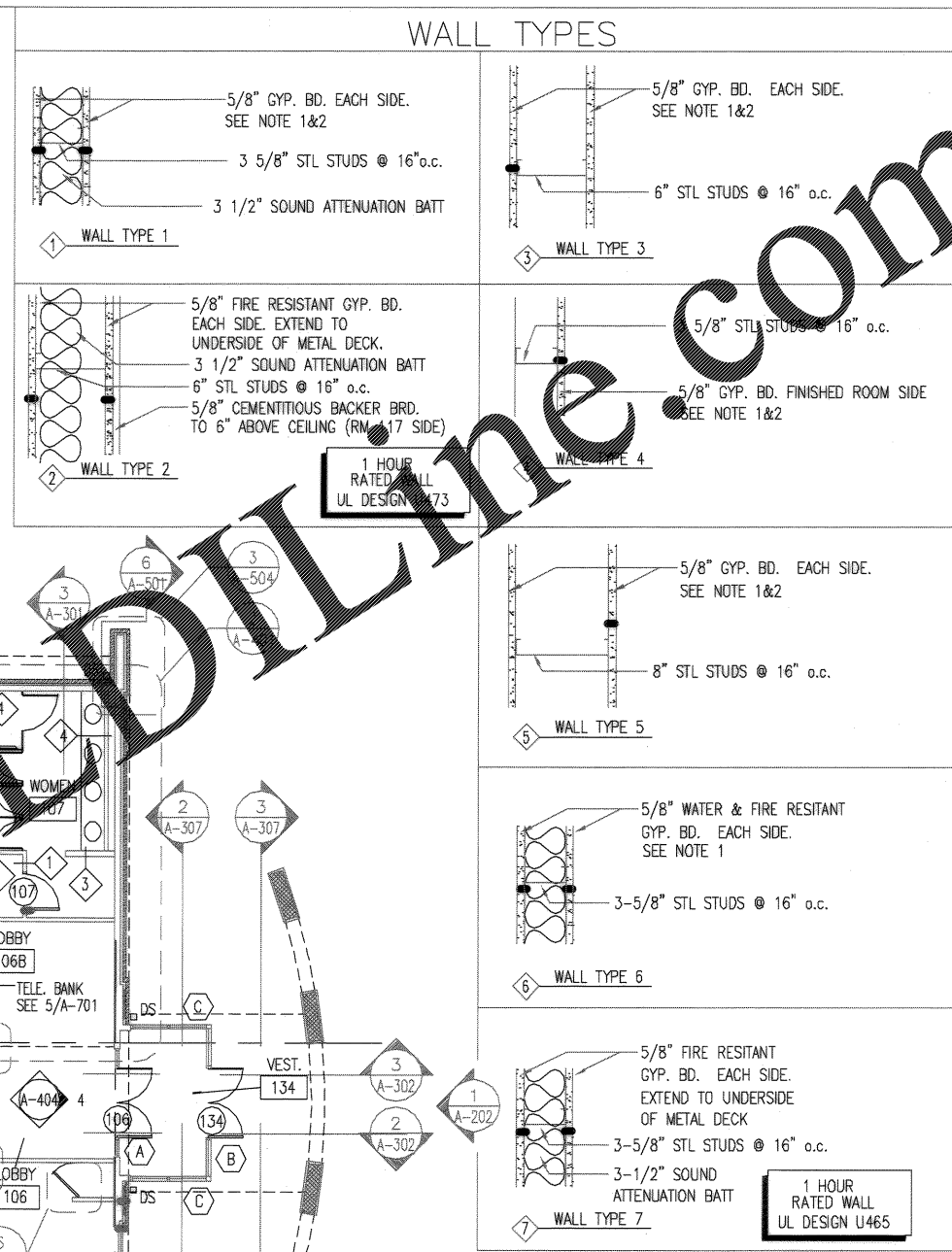
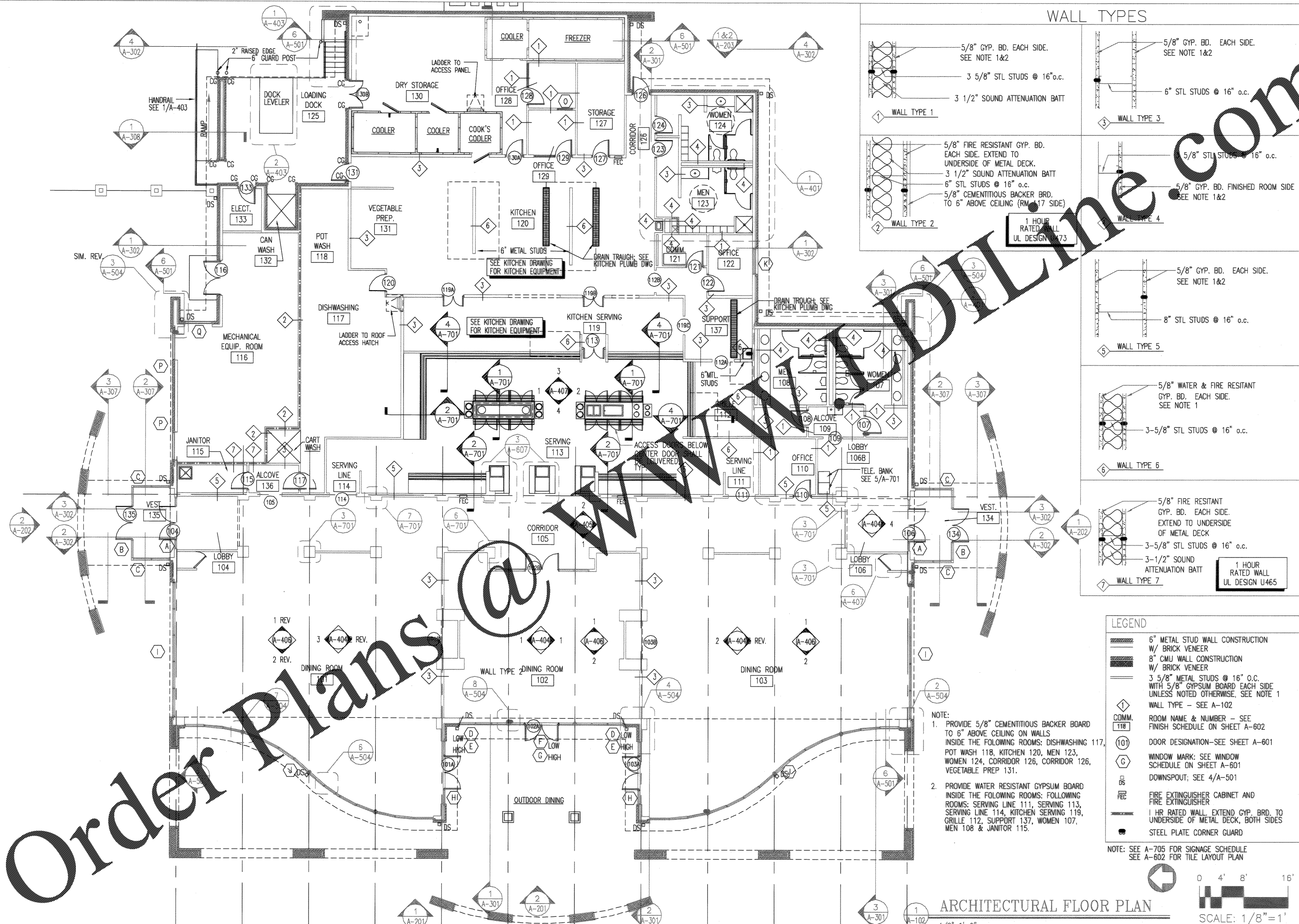

- NOTE:**
- PROVIDE 5/8" CEMENTITIOUS BACKER BOARD TO 6" ABOVE CEILING ON WALLS INSIDE THE FOLLOWING ROOMS: DISHWASHING 117, POT WASH 118, KITCHEN 120, MEN 123, WOMEN 124, CORRIDOR 126, CORRIDOR 126, VEGETABLE PREP 131.
  - PROVIDE WATER RESISTANT GYPSUM BOARD INSIDE THE FOLLOWING ROOMS: FOLLOWING ROOMS: SERVING LINE 111, SERVING 113, SERVING LINE 114, KITCHEN SERVING 119, GRILLE 112, SUPPORT 137, WOMEN 107, MEN 108 & JANITOR 115.

**LEGEND**

- 6" METAL STUD WALL CONSTRUCTION W/ BRICK VENEER
- 8" CMU WALL CONSTRUCTION W/ BRICK VENEER
- 3 5/8" METAL STUDS @ 16" O.C. WITH 5/8" GYPSUM BOARD EACH SIDE UNLESS NOTED OTHERWISE, SEE NOTE 1
- WALL TYPE - SEE A-102
- ROOM NAME & NUMBER - SEE FINISH SCHEDULE ON SHEET A-602
- DOOR DESIGNATION-SEE SHEET A-601
- WINDOW MARK: SEE WINDOW SCHEDULE ON SHEET A-601
- DOWNSPOUT; SEE 4/A-501
- FIRE EXTINGUISHER CABINET AND FIRE EXTINGUISHER
- 1 HR RATED WALL. EXTEND GYP. BRD. TO UNDERSIDE OF METAL DECK, BOTH SIDES
- STEEL PLATE CORNER GUARD

NOTE: SEE A-705 FOR SIGNAGE SCHEDULE  
 SEE A-602 FOR TILE LAYOUT PLAN

ARCHITECTURAL FLOOR PLAN  
 1/8"=1'-0"

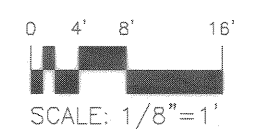

**Click/Boehm & Associates, Inc.**  
 247 Meeting House Square, Suite 100  
 Charleston, S.C. 29401  
 (803) 577-6377

**Click/Boehm.com**

**REVISIONS**

NO.	DATE	DESCRIPTION	BY	CHK.
1	9/27/04	DRWG. CORRECTED TO AS-BUILT	AKH	BOEHLM
2				
3				
4				
5				
6				
7				

**APPROVED:** *RT* **DATE:** 9/27/04

**CHARLESTON AIR FORCE BASE**  
**CHARLESTON, SOUTH CAROLINA**

**Naval Facilities Engineering Command**  
 Southern Division  
 Charleston, South Carolina

**STATE OF SOUTH CAROLINA**  
**REGISTERED ARCHITECT**  
 CLICK/BOEHM & ASSOCIATES, INC.  
 CHARLESTON NO. B-8006

**RECORD DRAWING DATE:** 9/27/04  
**CODE I.D. NO.:** 80091  
**DRAWING SIZE:** D  
**SPEC. NO. 06-98-0939**  
**CONSTR. CONTR. NO. N82467-98-C-0939**  
**NAVFAAC DRAWING NO. SHEET 55 OF 194**

**A-102**

468-140