

ALL DESIGNS, DRAWINGS AND SPECIFICATIONS DEPICTED ON THIS SHEET ARE PROPERTY OF COAST ARCHITECTS, INC. COPYRIGHT © 5/30/2018 ANY UNAUTHORIZED USE OR REPRODUCTION IS SUBJECT TO LEGAL PROSECUTION. POSSESSION IN ANY FORM CONSTITUTES ACCEPTANCE OF THESE CONDITIONS.
2:55:53 PM

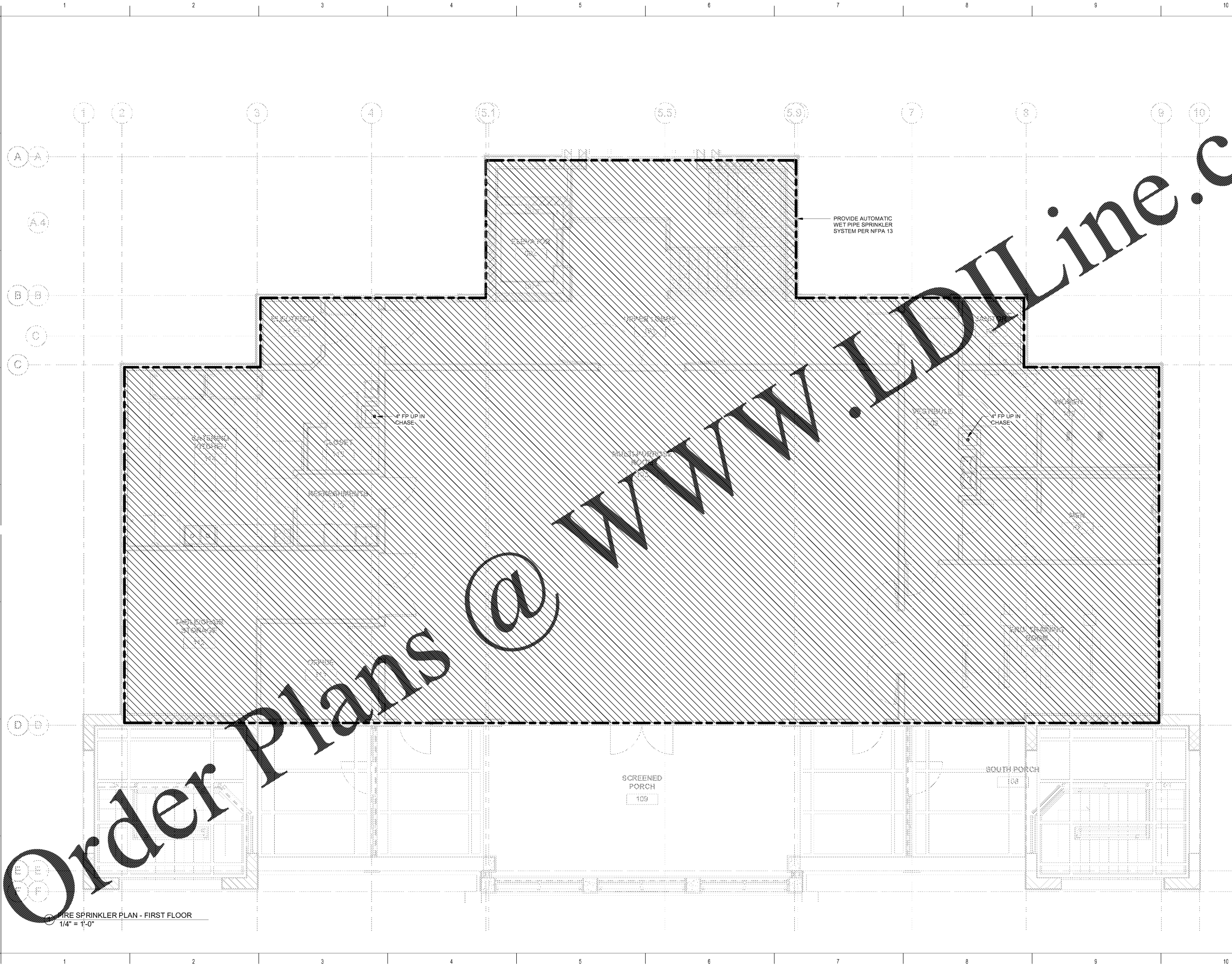

Order Plans @ WWW.IDILine.com

FIRE SPRINKLER PLAN - FIRST FLOOR
1/4" = 1'-0"

coast
architects
671 St. Andrews Blvd., Charleston, SC 29407
Phone: 843.763.7064 Fax: 843.763.7061
www.coastarchitects.net

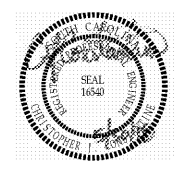
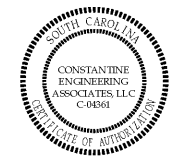

CONSTANTINE
ENGINEERING
ASSOCIATES, LLC
1433 Savannah Hwy #111, Charleston, SC 29407
Phone: 843.629.7079, Fax: 843.629.7911

BOATING CENTER REDEVELOPMENT -
SWAIN BOATING CENTER
H09-9617-PG-C
THE CITADEL 11 HAMMOND AVENUE
CHARLESTON, SC
THE MILITARY COLLEGE OF SOUTH CAROLINA

Revisions	
Rev. No.	Rev. Date

DRAWN BY: TJR
CHECKED BY: CJC
DATE: 06.01.2018
COAST PROJECT NO: 17-069

FIRE SPRINKLER
PLAN

1.F102

BID DOCUMENTS