

ALL DESIGNS, DRAWINGS AND SPECIFICATIONS DEPICTED ON THIS SHEET ARE PROPERTY OF COAST ARCHITECTS, INC. COPYRIGHT © 2018 ANY UNAUTHORIZED USE OR REPRODUCTION IS SUBJECT TO LEGAL PROSECUTION. POSSESSION IN ANY FORM CONSTITUTES ACCEPTANCE OF THESE CONDITIONS.

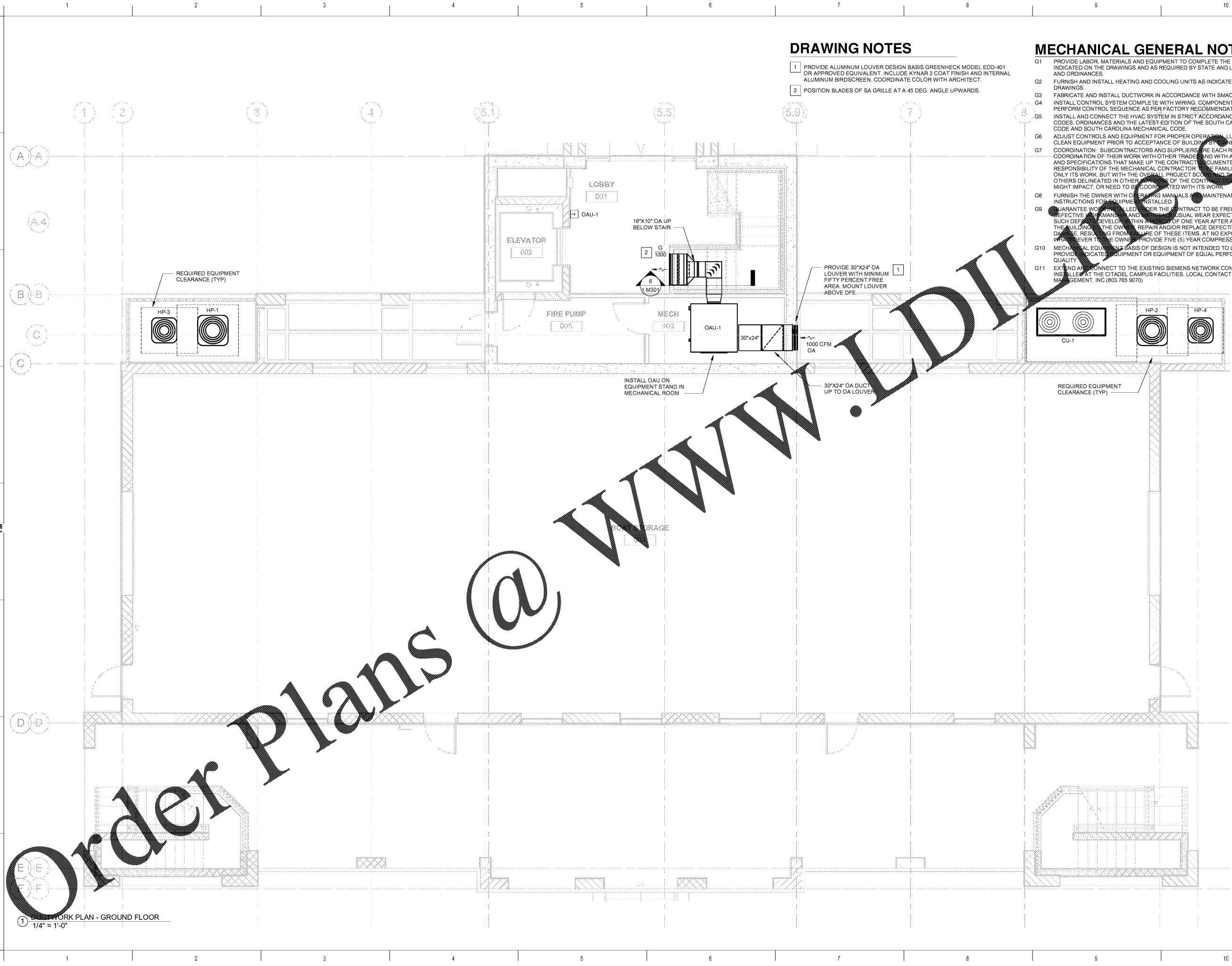

**DRAWING NOTES**

- 1 PROVIDE ALUMINUM LOUVER DESIGN BASIS GREENHECK MODEL EDD-401 OR APPROVED EQUIVALENT. INCLUDE KYNAR 2 COAT FINISH AND INTERNAL ALUMINUM BIRDSCREEN. COORDINATE COLOR WITH ARCHITECT.
- 2 POSITION BLADES OF SA GRILLE AT A 45 DEG. ANGLE UPWARDS.

**MECHANICAL GENERAL NOTES**

- G1 PROVIDE LABOR, MATERIALS AND EQUIPMENT TO COMPLETE THE HVAC WORK INDICATED ON THE DRAWINGS AND AS REQUIRED BY STATE AND LOCAL CODES AND ORDINANCES.
- G2 FURNISH AND INSTALL HEATING AND COOLING UNITS AS INDICATED ON THE DRAWINGS.
- G3 FABRICATE AND INSTALL DUCTWORK IN ACCORDANCE WITH SMACNA STANDARDS.
- G4 INSTALL CONTROL SYSTEM COMPLETE WITH WIRING, COMPONENTS, ETC. TO PERFORM CONTROL SEQUENCE AS PER FACTORY RECOMMENDATIONS.
- G5 INSTALL AND CONNECT THE HVAC SYSTEM IN STRICT ACCORDANCE WITH ALL LOCAL CODES, ORDINANCES AND THE LATEST EDITION OF THE SOUTH CAROLINA BUILDING CODE AND SOUTH CAROLINA MECHANICAL CODE.
- G6 ADJUST CONTROLS AND EQUIPMENT FOR PROPER OPERATION. LUBRICATE AND CLEAN EQUIPMENT PRIOR TO ACCEPTANCE OF BUILDING BY OWNER.
- G7 COORDINATION: SUBCONTRACTORS AND SUPPLIERS ARE EACH RESPONSIBLE FOR COORDINATION OF THEIR WORK WITH OTHER TRADES AND WITH ALL DRAWINGS AND SPECIFICATIONS THAT MAKE UP THE CONTRACT DOCUMENTS. IT IS THE RESPONSIBILITY OF THE MECHANICAL CONTRACTOR TO BE FAMILIAR WITH NOT ONLY ITS WORK, BUT WITH THE OVERALL PROJECT SCOPE AND THE WORK BY OTHERS DELINEATED IN OTHER CONTRACT DOCUMENTS THAT MIGHT IMPACT, OR NEED TO BE COORDINATED WITH ITS WORK.
- G8 FURNISH THE OWNER WITH OPERATING MANUALS AND MAINTENANCE INSTRUCTIONS FOR EQUIPMENT INSTALLED.
- G9 GUARANTEE WORKMANSHIP UNDER THE CONTRACT TO BE FREE FROM DEFECTIVE WORKMANSHIP AND UNUSUAL WEAR EXPECTED. SHOULD SUCH DEFECTS DEVELOP WITHIN A PERIOD OF ONE YEAR AFTER ACCEPTANCE OF THE BUILDING, THE OWNER SHALL REPAIR AND/OR REPLACE DEFECTIVE ITEMS AND DAMAGE RESULTING FROM FAILURE OF THESE ITEMS, AT NO EXPENSE WHATSOEVER TO THE OWNER. PROVIDE FIVE (5) YEAR COMPRESSOR WARRANTY.
- G10 MECHANICAL EQUIPMENT BASIS OF DESIGN IS NOT INTENDED TO LIMIT SELECTION. PROVIDE INDICATED EQUIPMENT OR EQUIPMENT OF EQUAL PERFORMANCE AND QUALITY.
- G11 EXTEND AND CONNECT TO THE EXISTING SIEMENS NETWORK CONTROL SYSTEM INSTALLED AT THE CITADEL CAMPUS FACILITIES. LOCAL CONTACT IS CONTROL MANAGEMENT, INC (803.765.9070)

1 MECHANICAL WORK PLAN - GROUND FLOOR  
1/4" = 1'-0"

WWW.LDILLINGHAM.CO

Order Plans @

**coast architects**  
671 St. Andrews Blvd, Charleston, SC 29407  
Phone: 843.763.7064 Fax: 843.763.7061  
www.coastarchitects.net

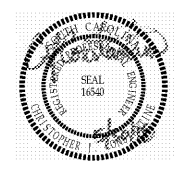

**CONSTANTINE ENGINEERING ASSOCIATES, LLC**  
1438 Savannah Hwy #110, Charleston, SC 29407  
Phone: 843.629.7070, Fax: 843.629.9814

**BOATING CENTER REDEVELOPMENT - SWAIN BOATING CENTER**  
H09-9617-PG-C

**CITADEL**  
11 HAMMOND AVENUE  
CHARLESTON, SC

THE MILITARY COLLEGE OF SOUTH CAROLINA

Revisions		
Rev. No.	Rev. Description	Rev. Date

DRAWN BY: TJR  
CHECKED BY: CJC  
DATE: 06.01.2018

COAST PROJECT NO: 17-069

**MECHANICAL DUCTWORK PLAN**

**1.M101**

BID DOCUMENTS