

ALL DESIGNS, DRAWINGS AND SPECIFICATIONS DEPICTED ON THIS SHEET ARE PROPERTY OF COAST ARCHITECTS, INC. COPYRIGHT © 5/30/2018 ANY UNAUTHORIZED USE OR REPRODUCTION IS SUBJECT TO LEGAL PROSECUTION. POSSESSION IN ANY FORM CONSTITUTES ACCEPTANCE OF THESE CONDITIONS.
 2:57:22 PM

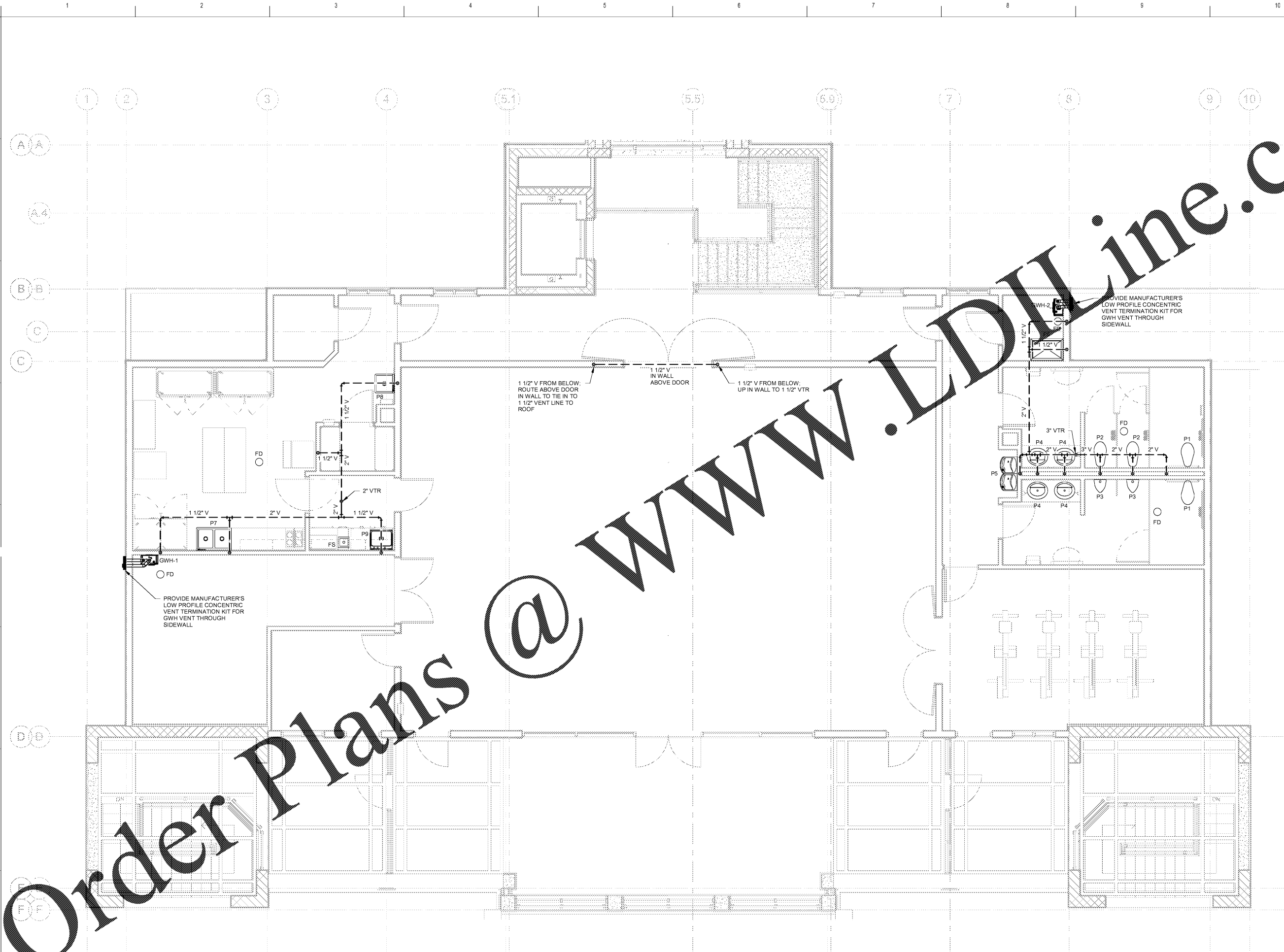

1 VENT PLAN - FIRST FLOOR
 1/4" = 1'-0"

Order Plans @ WWW.LDOnline.com

BID DOCUMENTS

1.P203

PLUMBING VENT PLAN

COAST PROJECT NO: 17-069

DATE: 06.01.2018

CHECKED BY: CJC

DRAWN BY: DDF

Revisions	
Rev. No.	Rev. Date

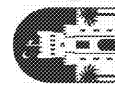

**BOATING CENTER REDEVELOPMENT -
 SWAIN BOATING CENTER**
 H09-9617-PG-C
 11 HAMMOND AVENUE
 CHARLESTON, SC

**CONSTANTINE
 ENGINEERING
 ASSOCIATES, LLC**
1438 Savannah Hwy #111, Charleston, SC 29407
 Phone: 843.529.7979, Fax: 843.529.7981

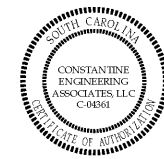
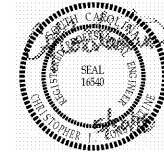

**coast
 architects**
671 St. Andrews Blvd, Charleston, SC 29407
 Phone: 843.763.7064 Fax: 843.763.7061
 www.coastarchitects.net