

ALL DESIGNS, DRAWINGS AND SPECIFICATIONS DEPICTED ON THIS SHEET ARE PROPERTY OF COAST ARCHITECTS, INC. COPYRIGHT © 6/1/2018 ANY UNAUTHORIZED USE OR REPRODUCTION IS SUBJECT TO LEGAL PROSECUTION. POSSESSION IN ANY FORM CONSTITUTES ACCEPTANCE OF THESE CONDITIONS.  
 10:48:17 AM

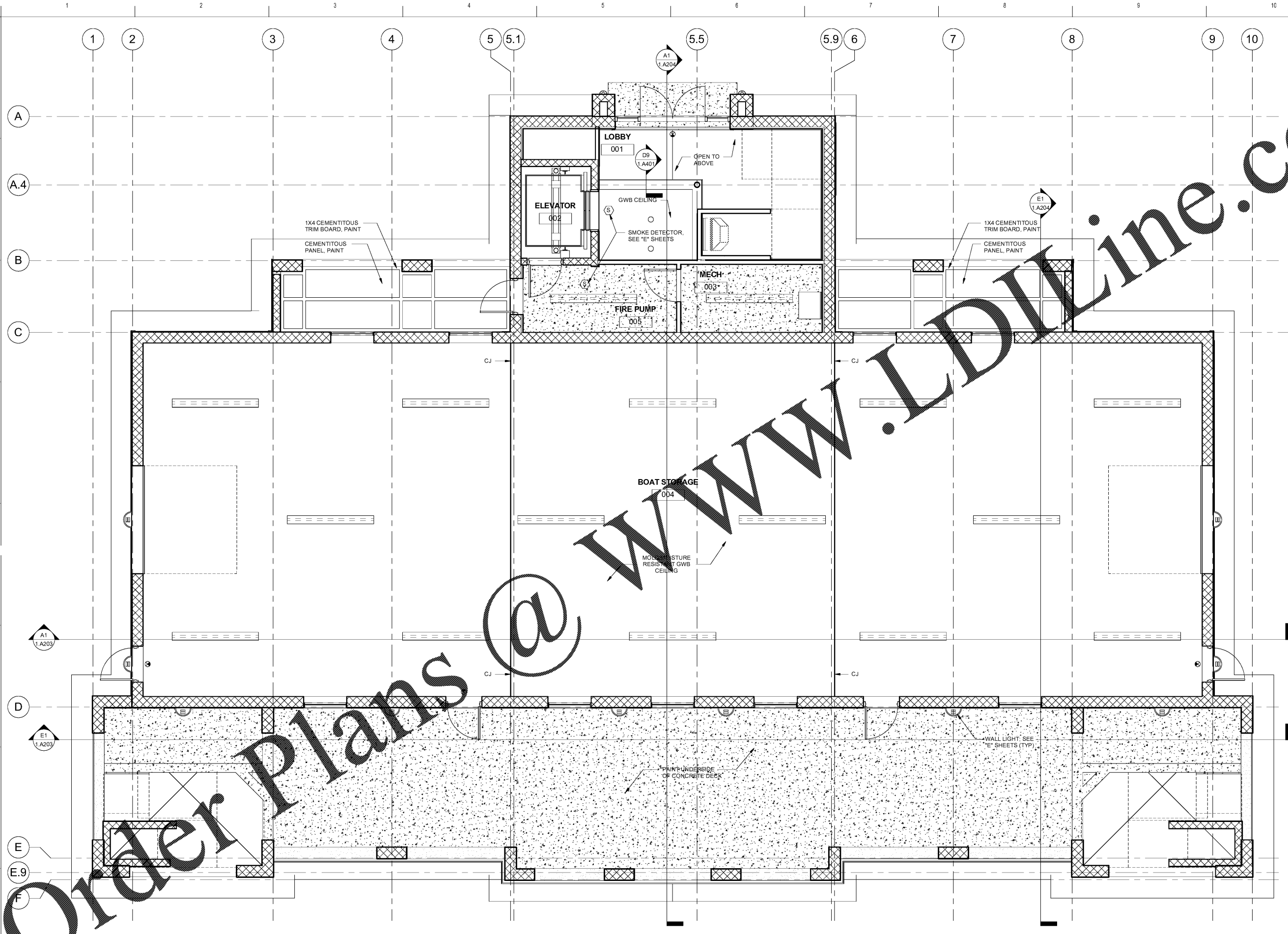

A1  
 1.A102 GROUND FLOOR REFLECTED CEILING PLAN  
 SCALE: 1/4" = 1'-0"

NOTE: SEE REFLECTED CEILING PLAN NOTES ON 1.A103

Order Plans @ WWW.LDVLIne.com

BID DOCUMENTS

BOATING CENTER REDEVELOPMENT -  
 SWAIN BOATING CENTER  
 H09-9617-PG-C

THE CITADEL  
 11 HAMMOND AVENUE  
 CHARLESTON, SC

Revisions	
Rev. No.	Rev. Date

DRAWN BY: MCC  
 CHECKED BY: FAM  
 DATE: 06.01.2018

COAST PROJECT NO: 1722.00

BOAT HOUSE  
 GROUND FLOOR  
 REFLECTED  
 CEILING PLAN

1.A102

coast architects  
 671 St. Andrews Blvd Charleston, SC 29407  
 Phone: 843.763.7064 Fax: 843.763.7061  
 www.coastarchitects.net

