

ALL DESIGNS, DRAWINGS AND SPECIFICATIONS DEPICTED ON THIS SHEET ARE PROPERTY OF COAST ARCHITECTS, INC. COPYRIGHT © 2017 ANY UNAUTHORIZED USE OR REPRODUCTION IS SUBJECT TO LEGAL PROSECUTION. POSSESSION IN ANY FORM CONSTITUTES ACCEPTANCE OF THESE CONDITIONS.

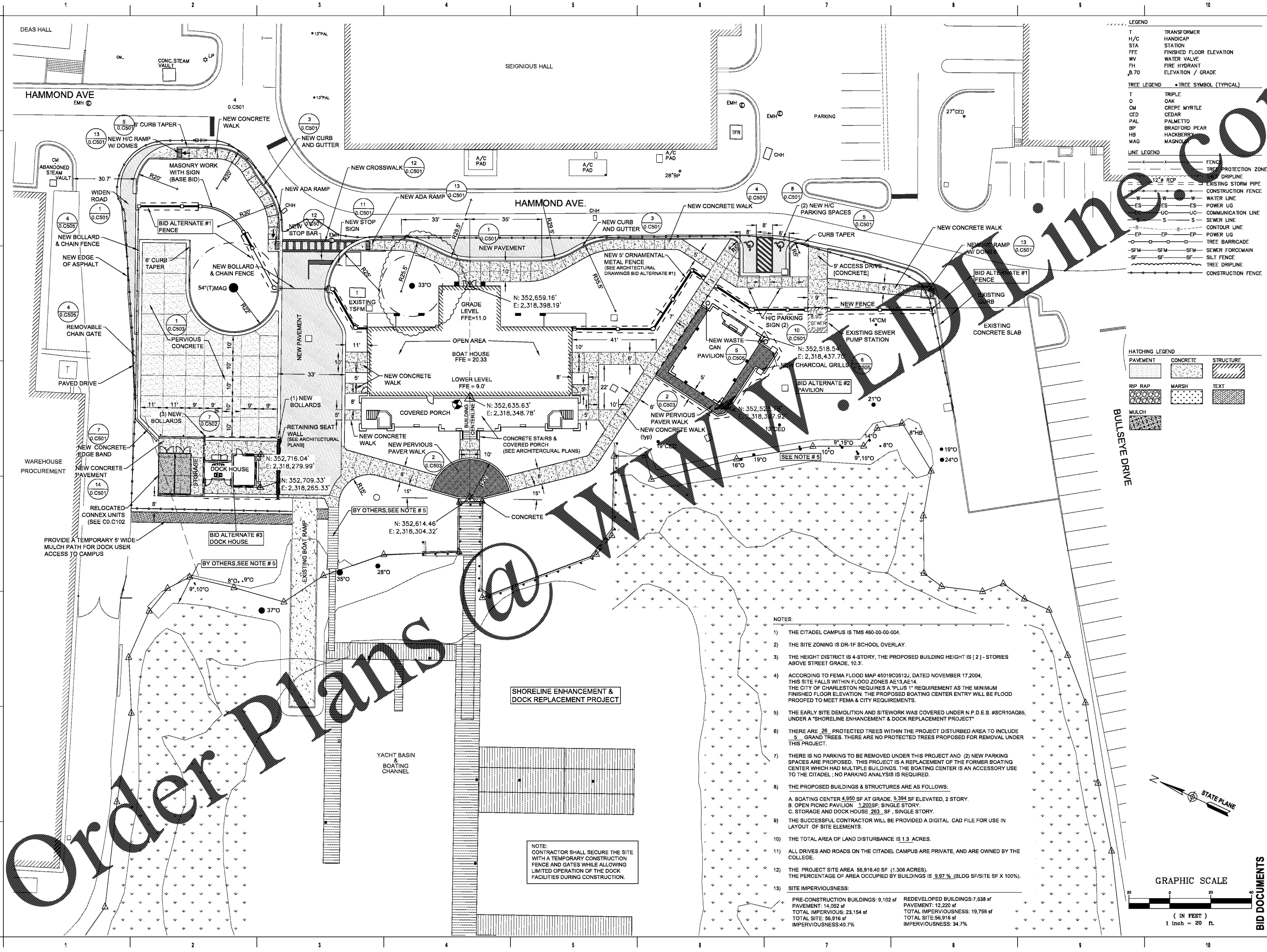

LEGEND

T	TRANSFORMER
H/C	HANDICAP STATION
FF	FINISHED FLOOR ELEVATION
WV	WATER VALVE
FH	FIRE HYDRANT
8.70	ELEVATION / GRADE

TREE LEGEND • TREE SYMBOL (TYPICAL)

T	TRIPLE OAK
CM	CREPE MYRTLE
CED	CEDAR
PAL	PALMETTO
BP	BRADFORD PEAR
HB	HACKBERRY
MAG	MAGNOLIA

LINE LEGEND

---	FENCE
---	TREE PROTECTION ZONE
---	DRIPLINE
---	EXISTING STORM PIPE
---	CONSTRUCTION FENCE
---	WATER LINE
---	POWER UG
---	COMMUNICATION LINE
---	SEWER LINE
---	CONTOUR LINE
---	POWER UG
---	TREE BARRICADE
---	SEWER FORCEMAIN
---	SILT FENCE
---	TREE DRIPLINE
---	CONSTRUCTION FENCE

HATCHING LEGEND

[Hatching]	PAVEMENT	[Hatching]	CONCRETE	[Hatching]	STRUCTURE
[Hatching]	GRASS	[Hatching]	MARSH	[Hatching]	TEXT
[Hatching]	MULCH	[Hatching]		[Hatching]	

- NOTES:**
- 1) THE CITADEL CAMPUS IS TMS 460-00-004.
 - 2) THE SITE ZONING IS DR-1F SCHOOL OVERLAY.
 - 3) THE HEIGHT DISTRICT IS 4-STORY, THE PROPOSED BUILDING HEIGHT IS (2) - STORIES ABOVE STREET GRADE, 10.3'.
 - 4) ACCORDING TO FEMA FLOOD MAP 45019C0512J, DATED NOVEMBER 17, 2004, THIS SITE FALLS WITHIN FLOOD ZONES AE13, AE14. THE CITY OF CHARLESTON REQUIRES A "PLUS 1" REQUIREMENT AS THE MINIMUM FINISHED FLOOR ELEVATION. THE PROPOSED BOATING CENTER ENTRY WILL BE FLOOD PROOFED TO MEET FEMA & CITY REQUIREMENTS.
 - 5) THE EARLY SITE DEMOLITION AND SITEWORK WAS COVERED UNDER N.P.D.E.S. #SCR10AQ65, UNDER A "SHORELINE ENHANCEMENT & DOCK REPLACEMENT PROJECT"
 - 6) THERE ARE 26 PROTECTED TREES WITHIN THE PROJECT DISTURBED AREA TO INCLUDE 5 GRAND TREES. THERE ARE NO PROTECTED TREES PROPOSED FOR REMOVAL UNDER THIS PROJECT.
 - 7) THERE IS NO PARKING TO BE REMOVED UNDER THIS PROJECT AND (2) NEW PARKING SPACES ARE PROPOSED. THIS PROJECT IS A REPLACEMENT OF THE FORMER BOATING CENTER WHICH HAD MULTIPLE BUILDINGS. THE BOATING CENTER IS AN ACCESSORY USE TO THE CITADEL; NO PARKING ANALYSIS IS REQUIRED.
 - 8) THE PROPOSED BUILDINGS & STRUCTURES ARE AS FOLLOWS:
 A. BOATING CENTER 4,950 SF AT GRADE, 5,394 SF ELEVATED, 2 STORY.
 B. OPEN PICNIC PAVILION 1,200 SF, SINGLE STORY.
 C. STORAGE AND DOCK HOUSE 263 SF, SINGLE STORY.
 - 9) THE SUCCESSFUL CONTRACTOR WILL BE PROVIDED A DIGITAL CAD FILE FOR USE IN LAYOUT OF SITE ELEMENTS.
 - 10) THE TOTAL AREA OF LAND DISTURBANCE IS 1.3 ACRES.
 - 11) ALL DRIVES AND ROADS ON THE CITADEL CAMPUS ARE PRIVATE, AND ARE OWNED BY THE COLLEGE.
 - 12) THE PROJECT SITE AREA 56,916.40 SF (1.306 ACRES). THE PERCENTAGE OF AREA OCCUPIED BY BUILDINGS IS 9.97% (BLDG SF/SITE SF X 100%).
 - 13) SITE IMPERVIOUSNESS:
 PRE-CONSTRUCTION BUILDINGS: 9,102 sf PAVEMENT: 14,052 sf TOTAL IMPERVIOUS: 23,154 sf TOTAL SITE: 56,916 sf IMPERVIOUSNESS: 40.7%
 REDEVELOPED BUILDINGS: 7,538 sf PAVEMENT: 12,220 sf TOTAL IMPERVIOUSNESS: 19,758 sf TOTAL SITE: 56,916 sf IMPERVIOUSNESS: 34.7%

NOTE:
CONTRACTOR SHALL SECURE THE SITE WITH A TEMPORARY CONSTRUCTION FENCE AND GATES WHILE ALLOWING LIMITED OPERATION OF THE DOCK FACILITIES DURING CONSTRUCTION.

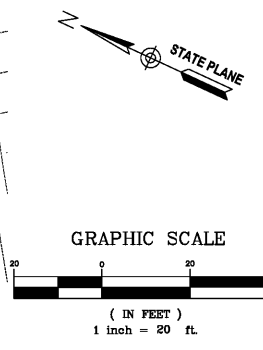

coast architects
 671 St. Andrews Blvd., Charleston, SC 29407
 Phone: 843.763.7064 Fax: 843.763.7061
 www.coastarchitects.net

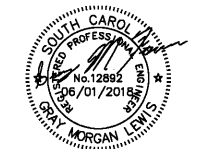
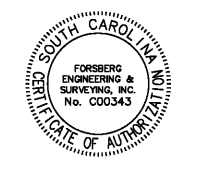

FORSBERG ENGINEERING AND SURVEYING, INC.
 1587 SAVANNAH HIGHWAY SUITE B
 P.O. BOX 30575
 CHARLESTON, SOUTH CAROLINA 29417
 (843) 571-2622 FAX (843) 571-6780
 CIVIL ENGINEERING, SURVEYING AND LAND PLANNING

**BOATING CENTER REDEVELOPMENT
 SWAN BOATING CENTER
 H09-9617-PG-C**
 11 HAMMOND AVENUE
 CHARLESTON, SC

Revisions

Rev. No.	Rev. Date

DRAWN BY: WFS
 CHECKED BY: DCF
 DATE: 06-01-2018
 COAST PROJECT NO.: 1722.00

GEOMETRIC SITE PLAN
0.C201
 JOB# 4727-1

BID DOCUMENTS