

ALL DESIGNS, DRAWINGS AND SPECIFICATIONS DEPICTED ON THIS SHEET ARE PROPERTY OF COAST ARCHITECTS, INC. COPYRIGHT © 2017 ANY UNAUTHORIZED USE OR REPRODUCTION IS SUBJECT TO LEGAL PROSECUTION. POSSESSION IN ANY FORM CONSTITUTES ACCEPTANCE OF THESE CONDITIONS.

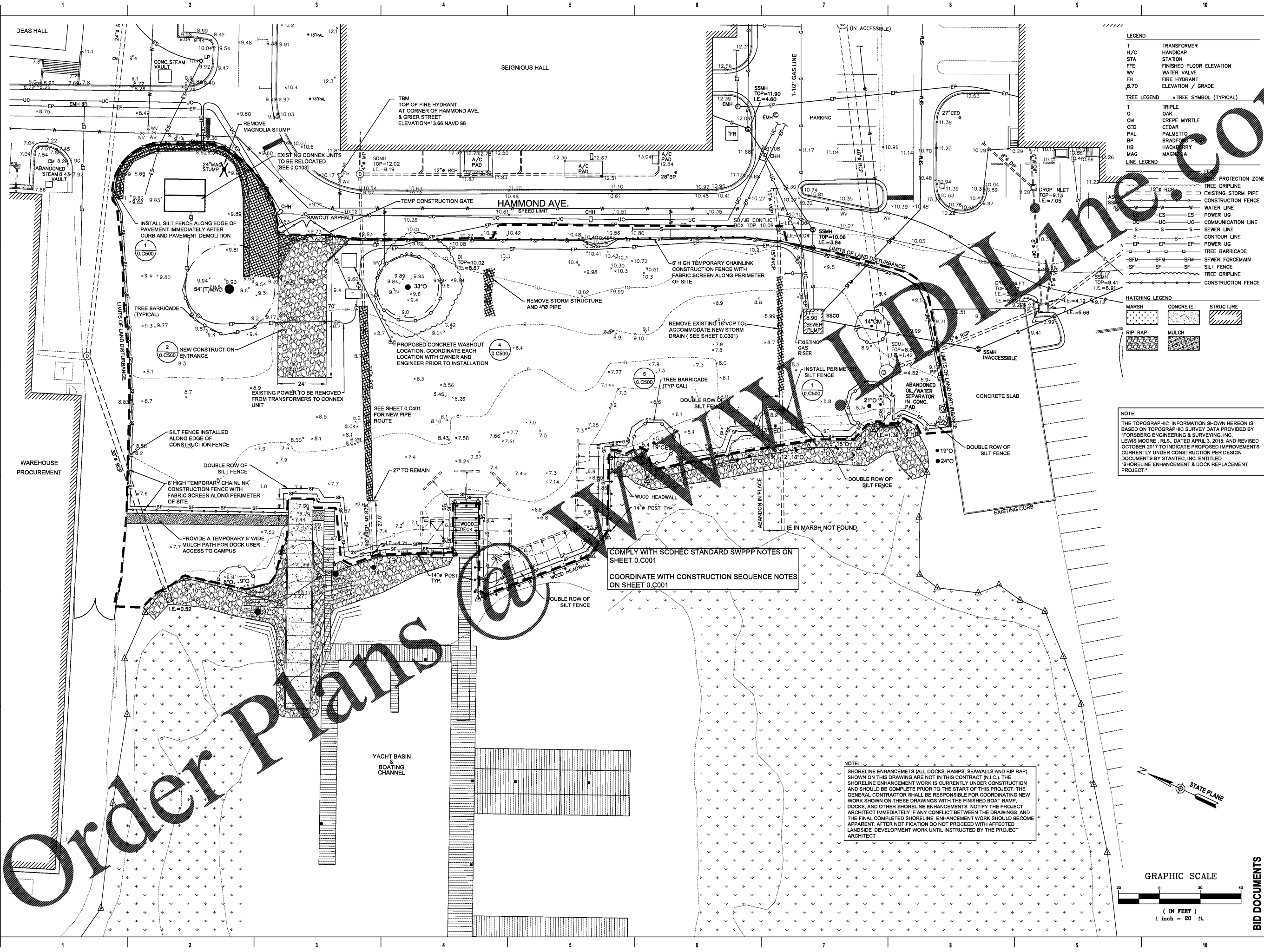

- LEGEND**
- T TRANSFORMER
 - H/C HANDICAP
 - STA STATION
 - FFE FINISHED FLOOR ELEVATION
 - WV WATER VALVE
 - FR FIRE HYDRANT
 - ELEVATION / GRADE
- TREE LEGEND** • TREE SYMBOL (TYPICAL)
- T TRIPLE
 - O OAK
 - CM CREPE MYRTLE
 - CED CEDAR
 - PAL PALMETTO
 - BP BRADFOOT PALM
 - HB HACKBERRY
 - MAG MAGNOLIA
- LINE LEGEND**
- TREE PROTECTION ZONE
 - TREE DRIFLINE
 - EXISTING STORM PIPE
 - CONSTRUCTION FENCE
 - WATER LINE
 - ES ES
 - UC UC
 - S SEWER LINE
 - CONTOUR LINE
 - POWER UG
 - TREE BARRICADE
 - SFM SFM
 - SFM SFM
 - SFM SFM
 - TREE DRIFLINE
 - CONSTRUCTION FENCE
- HATCHING LEGEND**
- MARSH
 - CONCRETE
 - STRUCTURE
 - RIP RAP
 - MULCH

NOTE:
THE TOPOGRAPHIC INFORMATION SHOWN HEREON IS BASED ON TOPOGRAPHIC SURVEY DATA PROVIDED BY FORSBERG ENGINEERING & SURVEYING, INC. LEWIS MOORE, RLS., DATED APRIL 3, 2015; AND REVISED OCTOBER 2017 TO INDICATE PROPOSED IMPROVEMENTS CURRENTLY UNDER CONSTRUCTION PER DESIGN DOCUMENTS BY STANTEC, INC. ENTITLED "SHORELINE ENHANCEMENT & DOCK REPLACEMENT PROJECT."

COMPLY WITH SCDHEC STANDARD SWPPP NOTES ON SHEET 0.C001
COORDINATE WITH CONSTRUCTION SEQUENCE NOTES ON SHEET 0.C001

NOTE:
SHORELINE ENHANCEMENTS (ALL DOCKS, RAMPS, SEAWALLS AND RIP RAP) SHOWN ON THIS DRAWING ARE NOT IN THIS CONTRACT (N.I.C.). THE SHORELINE ENHANCEMENT WORK IS CURRENTLY UNDER CONSTRUCTION AND SHOULD BE COMPLETE PRIOR TO THE START OF THIS PROJECT. THE GENERAL CONTRACTOR SHALL BE RESPONSIBLE FOR COORDINATING NEW WORK SHOWN ON THESE DRAWINGS WITH THE FINISHED BOAT RAMP, DOCKS, AND OTHER SHORELINE ENHANCEMENTS. NOTIFY THE PROJECT ARCHITECT IMMEDIATELY IF ANY CONFLICT BETWEEN THE DRAWINGS AND THE FINAL COMPLETED SHORELINE ENHANCEMENT WORK SHOULD BECOME APPARENT. AFTER NOTIFICATION DO NOT PROCEED WITH AFFECTED LANDSIDE DEVELOPMENT WORK UNTIL INSTRUCTED BY THE PROJECT ARCHITECT

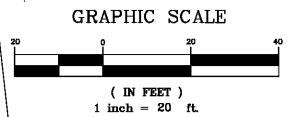
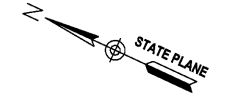

coast architects
671 St. Andrews Blvd., Charleston, SC 29407
Phone: 843.763.7064 Fax: 843.763.7061
www.coastarchitects.net

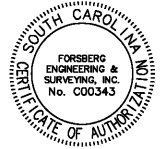

FORSBERG ENGINEERING AND SURVEYING, INC.
1587 SAVANNAH HIGHWAY, SUITE B
P.O. BOX 30575
CHARLESTON, SOUTH CAROLINA 29417
(843) 571-2622 FAX (843) 571-6780
CIVIL ENGINEERING, SURVEYING AND LAND PLANNING

**BOATING CENTER REDEVELOPMENT
SWAIN BOATING CENTER
H09-9617-PG-C**

CITADEL
THE MILITARY COLLEGE OF SOUTH CAROLINA

11 HAMMOND AVENUE
CHARLESTON, SC

Revisions	
Rev. No.	Rev. Date

DRAWN BY: WFS
CHECKED BY: DCF
DATE: 06-01-2018

COAST PROJECT NO: 1722.00

SITE, DEMOLITION, & EROSION CONTROL PLAN

0.C102

JOB# 4727-1

BID DOCUMENTS