

Window Schedule					
Mark	Family and Type	Sill Height	Comments	Type	Comments
51	Double Hung with Trim: 36" x 48"	1' - 0"	X	REPLACE ALL WINDOWS	
52	Double Hung with Trim: 36" x 48"	1' - 0"	X	REPLACE ALL WINDOWS	
53	Double Hung with Trim: 36" x 48"	1' - 0"	X	REPLACE ALL WINDOWS	
54	Double Hung with Trim: 36" x 48"	1' - 0"	X	REPLACE ALL WINDOWS	
55	Double Hung with Trim: 36" x 48"	1' - 0"	X	REPLACE ALL WINDOWS	
56	Double Hung with Trim: 36" x 72"	1' - 0"	Y	REPLACE ALL WINDOWS	
57	Double Hung with Trim: 36" x 72"	1' - 3"	Y	REPLACE ALL WINDOWS	
58	Double Hung with Trim: 36" x 72"	1' - 3"	Y	REPLACE ALL WINDOWS	
59	Double Hung with Trim: 36" x 72"	1' - 3"	Y	REPLACE ALL WINDOWS	
60	Double Hung with Trim: 36" x 72"	1' - 3"	Y	REPLACE ALL WINDOWS	
61	Double Hung with Trim: 36" x 72"	1' - 0"	Y	REPLACE ALL WINDOWS	
62	Double Hung with Trim: 36" x 48"	3' - 0"	X	REPLACE ALL WINDOWS	

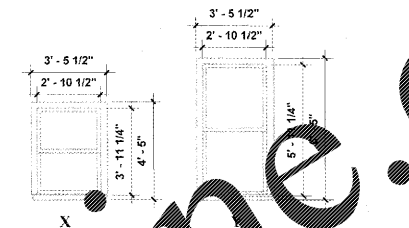

Door Schedule						
Mark	Family and Type	Height	Width	Door/Hardware Type	Comments	
1	Single-Flush: 36" x 84" Exterior	7' - 0"	3' - 0"	C/2	UPON INSPECTION DETERMINE WHAT HAS TO BE REPLACED	
2	Single-Flush: 36" x 84" Exterior	7' - 0"	3' - 0"	C/2	UPON INSPECTION DETERMINE WHAT HAS TO BE REPLACED	
3	Single-Flush: 36" x 84"	7' - 0"	3' - 0"	C/1	UPON INSPECTION DETERMINE WHAT HAS TO BE REPLACED	
4	Door-Exterior-Single-Entry-Half Flat Glass-Wood Clad: 36" x 84"	7' - 0"	3' - 0"	A/1	REPLACE INCLUDING METAL FRAME	
5	Door-Exterior-Single-Entry-Half Flat Glass-Wood Clad: 36" x 84"	7' - 0"	3' - 0"	A/1	REPLACE INCLUDING METAL FRAME	
6	Door-Exterior-Single-Two Lite: 36" x 84"	7' - 0"	3' - 0"	B/2	REPLACE INCLUDING METAL FRAME	
7	Single-Flush: 36" x 84"	7' - 0"	3' - 0"	C/1	SAND AND SEAL TO REUSE EXISTING DOORS	
8	Single-Flush: 36" x 84"	7' - 0"	3' - 0"	C/1	SAND AND SEAL TO REUSE EXISTING DOORS	
9	Single-Flush: 36" x 84"	7' - 0"	3' - 0"	C/1	SAND AND SEAL TO REUSE EXISTING DOORS	
10	Single-Flush: 36" x 84" Exterior	7' - 0"	3' - 0"	C/2	SAND AND SEAL TO REUSE EXISTING DOORS	
11	Single-Flush: 36" x 84"	7' - 0"	3' - 0"	C/1	SAND AND SEAL TO REUSE EXISTING DOORS	
12	Single-Flush: 36" x 84"	7' - 0"	3' - 0"	C/1	SAND AND SEAL TO REUSE EXISTING DOORS	
13	Single-Flush: 36" x 84"	7' - 0"	3' - 0"	C/1	SAND AND SEAL TO REUSE EXISTING DOORS	
14	Single-Flush: 36" x 84"	7' - 0"	3' - 0"	C/1	SAND AND SEAL TO REUSE EXISTING DOORS	
15	Single-Flush: 36" x 84"	7' - 0"	3' - 0"	C/1	SAND AND SEAL TO REUSE EXISTING DOORS	
16	Single-Flush: 36" x 84"	7' - 0"	3' - 0"	C/1	MATCH EXISTING DOORS IN USE	
17	Single-Flush: 36" x 84"	7' - 0"	3' - 0"	C/1	MATCH EXISTING DOORS IN USE	
18	Single-Flush: 36" x 84"	7' - 0"	3' - 0"	C/1	SAND AND SEAL TO REUSE EXISTING DOORS	
19	Door-Exterior-Single-Two Lite: 36" x 84"	7' - 0"	3' - 0"	B/2	NEW CONSTRUCTION	
20	Single-Flush: 36" x 84" Exterior	7' - 0"	3' - 0"	C/2	NEW CONSTRUCTION	
21	Door-Garage-Flush Panel: 12X12	12' - 0"	12' - 0"	D/3	REPLACE INCLUDING METAL FRAME WITH NEW MOTORS WITH ONE PANEL OF WINDOWS	
22	Door-Garage-Flush Panel: 12X12	12' - 0"	12' - 0"	D/3	REPLACE INCLUDING METAL FRAME WITH NEW MOTORS WITH ONE PANEL OF WINDOWS	

FLOORCOVERING FINISH SCHEDULE		
Area	Family and Type	Description
1517 SF	Floor: Sealed Concrete	Polished and sealed concrete.
609 SF	Floor: Carpet Finish	Tandus Centiva - Streetlife 03973 - Lights Out 36101
233 SF	Floor: Ceramic Tile SMALL	6x6 Gray with 1/8" Charcoal Gray Grout
1921 SF	Floor: Sealed Concrete W/broadcast	Polished and sealed concrete.
	Bathroom Walls: Ceramic Tile	4x4 White with 1/8" Charcoal Gray Grout
	Base Trim Throughout: Rubberbase	Johnsonite 40 Black B

FINISH PAINT SCHEDULE		
ROOMS	SHERWIN WILLIAMS	CITYSCAPE SW706
BEDROOMS	SHERWIN WILLIAMS	CITYSCAPE SW706
DAY ROOM	SHERWIN WILLIAMS	DORIAN GRAY SW517
KITCHEN ACCENT WALL - SINK WALL ONLY	SHERWIN WILLIAMS	POSITIVE RED SW 687
BATHROOMS/TRAINING ROOM/OFFICE	SHERWIN WILLIAMS	SPATIAL WHITE SW 6259
INTERIOR CEILINGS & INTERIOR TRIM	SHERWIN WILLIAMS	CEILING WHITE
ENGINE BAY / GARAGE CEILINGS	SHERWIN WILLIAMS	FLAT BLACK
ENGINE BAY / GARAGE WALLS BELOW 8'	SHERWIN WILLIAMS	CITYSCAPE SW706
ENGINE BAY / GARAGE WALLS ABOVE 8'	SHERWIN WILLIAMS	SPATIAL WHITE SW 6259

CONTRACTOR SHALL CONFIRM PAINT NAME AND NUMBERS MATCH PAINT SHALL BE EGGSHELL WHITE UNLESS NOTED OTHERWISE

HARDWARE SET SCHEDULE		
SET #	QUANTITY	DESCRIPTION
1	3 EACH	INTERIOR SOLID WOOD DOOR
	1 EACH	BB BUTT HINGES (VERIFY IN THE FIELD)
	1 EACH	PRIVACY LOCK SET-LEVER HANDLE
	1 EACH	STRIKE PLATE
	1 EACH	FLOOR/WALL STOP
2	3 EACH	EXTERIOR HOLLOW METAL DOOR
	1 EACH	BB BUTT HINGES (VERIFY IN THE FIELD)
	1 EACH	SINGLE DEADBOLT LOCK
	1 EACH	PASSAGE-LEVER HANDLE
	1 EACH	STRIKE PLATE
	1 EACH	FLOOR/WALL STOP
3	1 EACH	ELECTRIC DOOR OPERATOR PROVIDED BY MANUFACTURER
	1 EACH	ELECTRIC MOTOR
	1 EACH	AUXILIARY CHAIN HOIST
	2 EACH	INSIDE SLIDE LOCKS - MANUAL

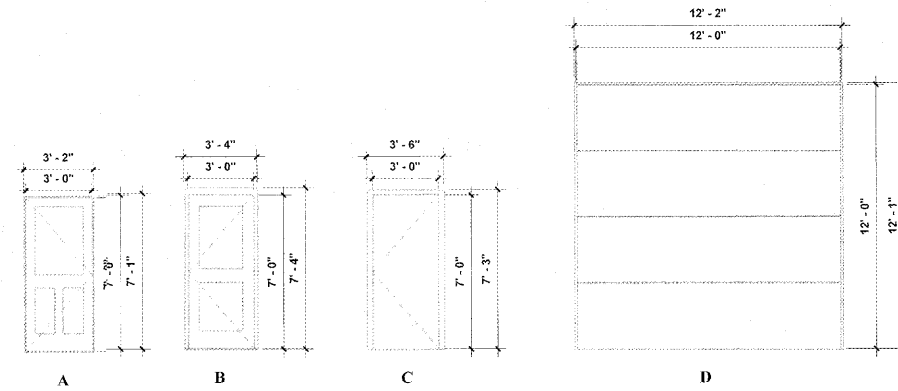

**MILLER**  
Architecture and Planning

Architecture - Interior Design - Renovation  
Master Planning - Restoration - Commercial  
Facilities Management - Residential - Industrial

6534 Spring Street, Douglasville, GA 30134  
678-715-1556 | millerap.com | info@millerap.com

- GENERAL CONSTRUCTION NOTES:**
- THE CONTRACTOR SHALL GUARANTEE TO THE OWNER ALL WORKMANSHIP AND MATERIALS, WHETHER FURNISHED BY THE CONTRACTOR OR SUB-CONTRACTORS, AGAINST DEFECTS FOR A MINIMUM PERIOD OF ONE (1) YEAR AFTER THE DATE OF FINAL ACCEPTANCE BY OWNER. FAILURE OF ANY SUCH ITEMS SHALL BE MADE GOOD BY THE CONTRACTOR AT THE CONTRACTOR'S OWN EXPENSE.
  - THE CONTRACTOR SHALL TAKE ALL NECESSARY PRECAUTIONS TO PROTECT FROM DAMAGE OR DESTRUCTION ALL EXISTING MATERIALS AND FINISHES TO REMAIN IN ADJACENT OR NEARBY AREAS. THE CONTRACTOR SHALL REPLACE ANY DAMAGED OR DESTROYED ITEMS BY OPERATIONS UNDER THIS CONTRACT.
  - PRODUCTS, TRADE NAMES AND/OR MANUFACTURERS NOTED WITHIN THESE DOCUMENTS ARE PROVIDED TO ESTABLISH A STANDARD OF QUALITY. UNLESS OTHERWISE INDICATED, APPROVED EQUAL PRODUCTS OF ANOTHER MANUFACTURER MAY BE USED WITH THE WRITTEN PERMISSION OF THE ARCHITECT. IT IS THE RESPONSIBILITY OF THE CONTRACTOR AND SUPPLIER TO PROVE TO THE ARCHITECT BEFORE THE DATE OF BID THAT THEIR PRODUCT IS EQUAL TO OR BETTER THAN THOSE PRODUCTS SPECIFIED. IF AN "OR EQUAL" PRODUCT IS USED, IT IS THE RESPONSIBILITY OF THE CONTRACTOR TO MAKE ANY NECESSARY CHANGES TO THE STRUCTURE AND INTERIOR LAYOUT AT THE CONTRACTOR'S OWN EXPENSE, AFTER OBTAINING THE ARCHITECT'S ACCEPTANCE OF SUCH CHANGES.
  - THE CONTRACTOR SHALL COORDINATE WITH THE OWNER A DESIGNATED SITE OR SPACES FOR STORAGE OF MATERIALS AND EQUIPMENT FOR THE DURATION OF THE CONSTRUCTION CONTRACT.
  - DIMENSIONS SHOWN ON THE DRAWINGS ARE TO ROUGH SURFACES, EXCLUSIVE OF FINISH MATERIALS, EXCEPT AS NOTED OTHERWISE. DO NOT SCALE THE DRAWINGS.
  - THE CONTRACTOR SHALL COMPLY WITH ALL RELEVANT AND CURRENTLY ENFORCED BUILDING CODES AND LAWS BY ALL GOVERNING JURISDICTIONS, INCLUDING BUT NOT LIMITED TO ALL PROVISIONS OF THE AMERICAN WITH DISABILITIES ACT.

The contractor shall be responsible for all fees and obtaining all necessary and relevant permits and approvals relating to staging and construction of this project. The contractor shall comply with all relevant building, construction and work safety codes. The contractor shall verify all dimensions and elevations in the field before starting work and immediately report to the architect any discrepancies discovered.

STATE OF GEORGIA  
REGISTERED ARCHITECT

DOUGLAS COUNTY FIRE STATION 3  
5203 KILROY LANE  
DOUGLASVILLE, GA 30135

CLIENT: DOUGLAS COUNTY  
FIRE/EMS DEPARTMENT  
6856 WEST BROAD STREET  
DOUGLASVILLE, GA 30134

DRAWING TITLE: SCHEDULES AND SELECTIONS

ISSUANCE: DATE: DRAWING NO:  
BID SET 12/2014

A-93

COMMISSION: 2011  
DRAWN BY: SCB

Order Plans