

PLAN LEGEND	
	4x4 STEEL COLUMN
	EXTERIOR DOOR
	12'X12' GARAGE DOOR
	MAN DOOR
	CASED OPENING
	PARTITION
	EXISTING TO REMAIN
	WINDOW
	SHOWER PAN
	COMMODE
	2 COMPARTMENT SINK
	VANITY SINK
	ICE MAKER
	REFRIGERATOR
	RANGE
	DISHWASHER

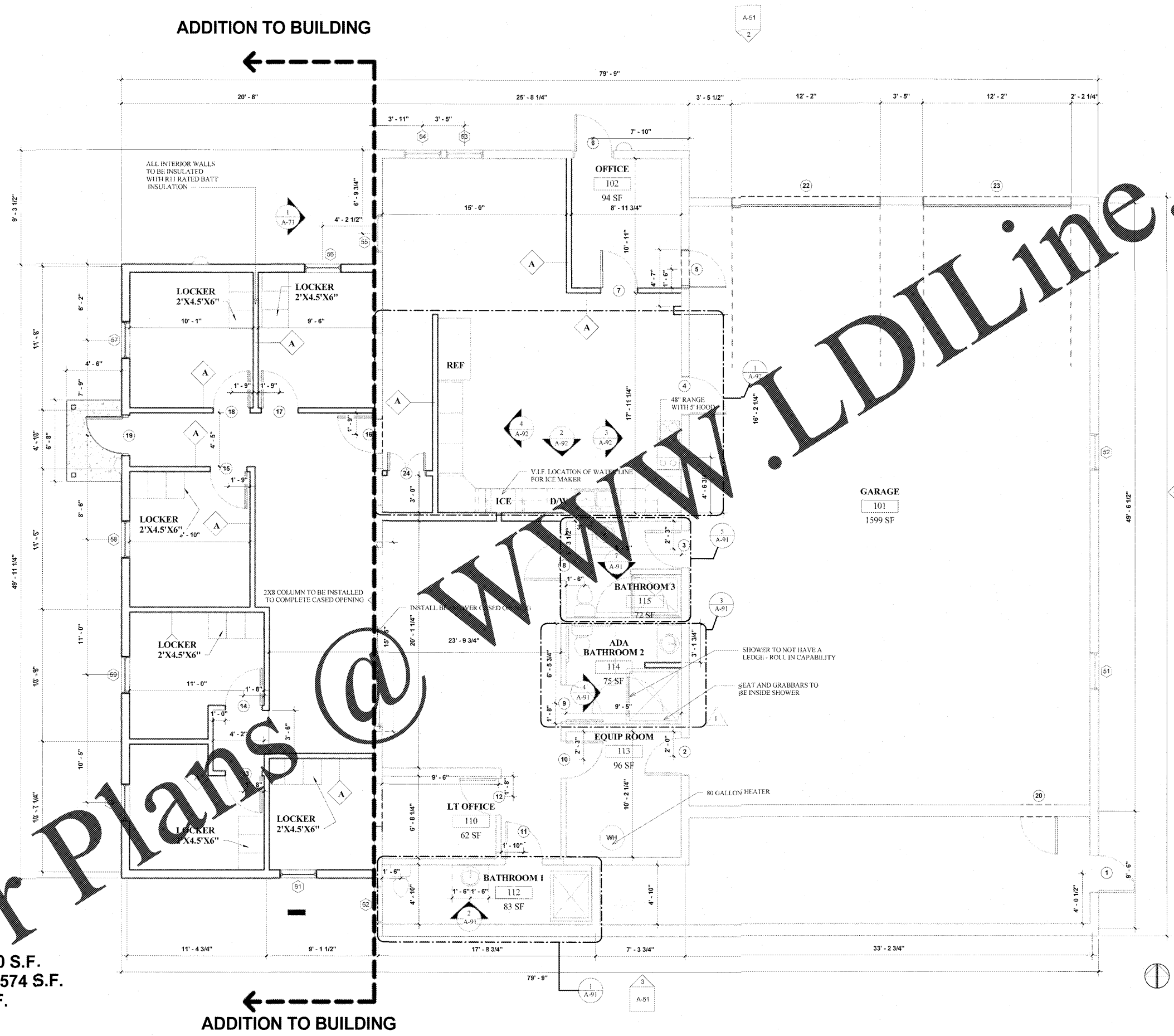

TOTAL AREA: 4,471 S.F.
 TOTAL LIVING SPACE: 2,050 S.F.
 EXISTING LIVING SPACE: 1,574 S.F.
 AREA OF ADDITION: 976 S.F.

1 FLOOR PLAN
 A-21 / 1/4" = 1'-0"



Architecture - Interior Design - Renovation
 Master Planning - Restoration - Commercial
 Facilities Management - Residential - Industrial

6534 Spring Street, Douglasville, GA 30134
 678-715-1586 | millerap.com | info@millerap.com

The drawings herein represent the physical and intellectual property of Miller Architecture and Planning and may not be reproduced or transmitted in any form without the prior written consent of said firm.

GENERAL CONSTRUCTION NOTES:

- THE CONTRACTOR SHALL GUARANTEE TO THE OWNER ALL WORKMANSHIP AND MATERIALS, WHETHER FURNISHED BY THE CONTRACTOR OR SUB-CONTRACTORS, AGAINST DEFECTS FOR A MINIMUM PERIOD OF ONE (1) YEAR AFTER THE DATE OF FINAL ACCEPTANCE BY OWNER. FAILURE OF ANY SUCH ITEMS SHALL BE MADE GOOD BY THE CONTRACTOR AT THE CONTRACTOR'S OWN EXPENSE.
- THE CONTRACTOR SHALL TAKE ALL NECESSARY PRECAUTIONS TO PROTECT FROM DAMAGE OR DESTRUCTION ALL EXISTING MATERIALS AND FINISHES TO REMAIN IN ADJACENT OR NEARBY AREAS. THE CONTRACTOR SHALL REPLACE ANY DAMAGED OR DESTROYED ITEMS BY OPERATIONS UNDER THIS CONTRACT.
- PRODUCTS, TRADE NAMES AND/OR MANUFACTURERS NOTED WITHIN THESE DOCUMENTS ARE PROVIDED TO ESTABLISH A STANDARD OF QUALITY. UNLESS OTHERWISE INDICATED, APPROVED EQUAL PRODUCTS OF ANOTHER MANUFACTURER MAY BE USED WITH THE WRITTEN PERMISSION OF THE ARCHITECT. IT IS THE RESPONSIBILITY OF THE CONTRACTOR AND SUPPLIER TO PROVE TO THE ARCHITECT BEFORE THE DATE OF BID THAT THEIR PRODUCT IS EQUAL TO OR BETTER THAN THOSE PRODUCTS SPECIFIED. IF AN "OR EQUAL" PRODUCT IS USED, IT IS THE RESPONSIBILITY OF THE CONTRACTOR TO MAKE ANY NECESSARY CHANGES TO THE STRUCTURE AND INTERIOR LAYOUT AT THE CONTRACTOR'S OWN EXPENSE, AFTER OBTAINING THE ARCHITECT'S ACCEPTANCE OF SUCH CHANGES.
- THE CONTRACTOR SHALL COORDINATE WITH THE OWNER A DESIGNATED SITE OR SITES FOR STORAGE OF MATERIALS AND EQUIPMENT FOR THE DURATION OF THE CONSTRUCTION CONTRACT.
- DIMENSIONS SHOWN ON THE DRAWINGS ARE TO ROUGH SURFACES, EXCLUSIVE OF FINISH MATERIALS, EXCEPT AS NOTED OTHERWISE. DO NOT SCALE THE DRAWINGS.
- THE CONTRACTOR SHALL COMPLY WITH ALL RELEVANT AND CURRENTLY ENFORCED BUILDING CODES AND LAWS BY ALL GOVERNING JURISDICTIONS, INCLUDING BUT NOT LIMITED TO ALL PROVISIONS OF THE AMERICAN WITH DISABILITIES ACT.

The contractor shall be responsible for all fees and obtaining all necessary and relevant permits and approvals relating to staging and construction of this project. The contractor shall comply with all relevant building, construction and work safety codes. The contractor shall verify all dimensions and elevations in the field before starting work and immediately report to the architect any discrepancies discovered.



DOUGLAS COUNTY FIRE STATION 3
 5203 KILROY LANE
 DOUGLASVILLE, GA 30135

CLIENT: DOUGLAS COUNTY
 FIRE/EMS DEPARTMENT
 6856 WEST BROAD STREET
 DOUGLASVILLE, GA 30134

DRAWING TITLE: FLOOR PLAN

ISSUANCE	DATE	DRAWING NO.
RID SET	3/29/2018	A-21
COMMISSION	2018	961
DRAWN BY		