

DEMOLITION NOTES

- 1 REMOVE CEILING TILES CEILING ACCESSORIES, LIGHT FIXTURES, CEILING FANS AND EMERGENCY LIGHTING, RELOCATE PER REFLECTED CEILING PLAN (A-11)
- 2 REMOVE EXISTING INSULATION IN ATTIC SPACE. SEE MECHANICAL DRAWINGS FOR DEMOLITION OF EXISTING MEPS. ALL MATERIALS TO BE DEPOSITED PER LOCAL, STATE OR ORDINANCES.
- 3 REMOVE EXISTING DOOR, HARDWARE AND FRAME AND STORE FOR REUSE WHERE POSSIBLE. FOR OWNER'S CONSTRUCTION, DOORS TO BE SANITIZED, REPAIRED AND REUSED IN SLEEPING QUARTERS.
- 3A REMOVE DOORS DURING CONSTRUCTION PHASE TO BEHIND CAN BE REUSED THROUGHOUT RENOVATION.
- 4 REMOVE ALL FLOORCOVERING AND DISPOSE IN ACCORDANCE WITH LOCAL, STATE, FEDERAL, REMOVAL, REPAIR ANY SUBFLOOR.
- 5 REMOVE EXISTING WALL AND/OR FLOOR TILE AND DISPOSE IN ACCORDANCE WITH LOCAL WASTE REMOVAL ORDINANCES. PREPARE & ENLARGE REFINISH FOR TILE INSTALLATION DURING CONSTRUCTION PHASE.
- 6 REMOVE EXISTING PLUMBING FIXTURES AND RESTROOM ACCESSORIES AND REPAIR OR REPLACE IN ACCORDANCE WITH LOCAL, STATE, FEDERAL, REMOVAL ORDINANCES. PREPARE REMAINING SURFACES FOR FIXTURE INSTALLATION DURING CONSTRUCTION PHASE.
- 7 REMOVE EXISTING EXTERIOR BRICK WHERE ADDITION WILL ATTACH TO EXISTING BUILDING. REPAIR ALL WINDOW OPENINGS AND SHIELD UP AREA TO SUITING CODE.

COUNTY TO HANDLE DEMOLITION

BRICK TO BE REMOVED AND SAVED BY MASONRY SUBCONTRACTOR

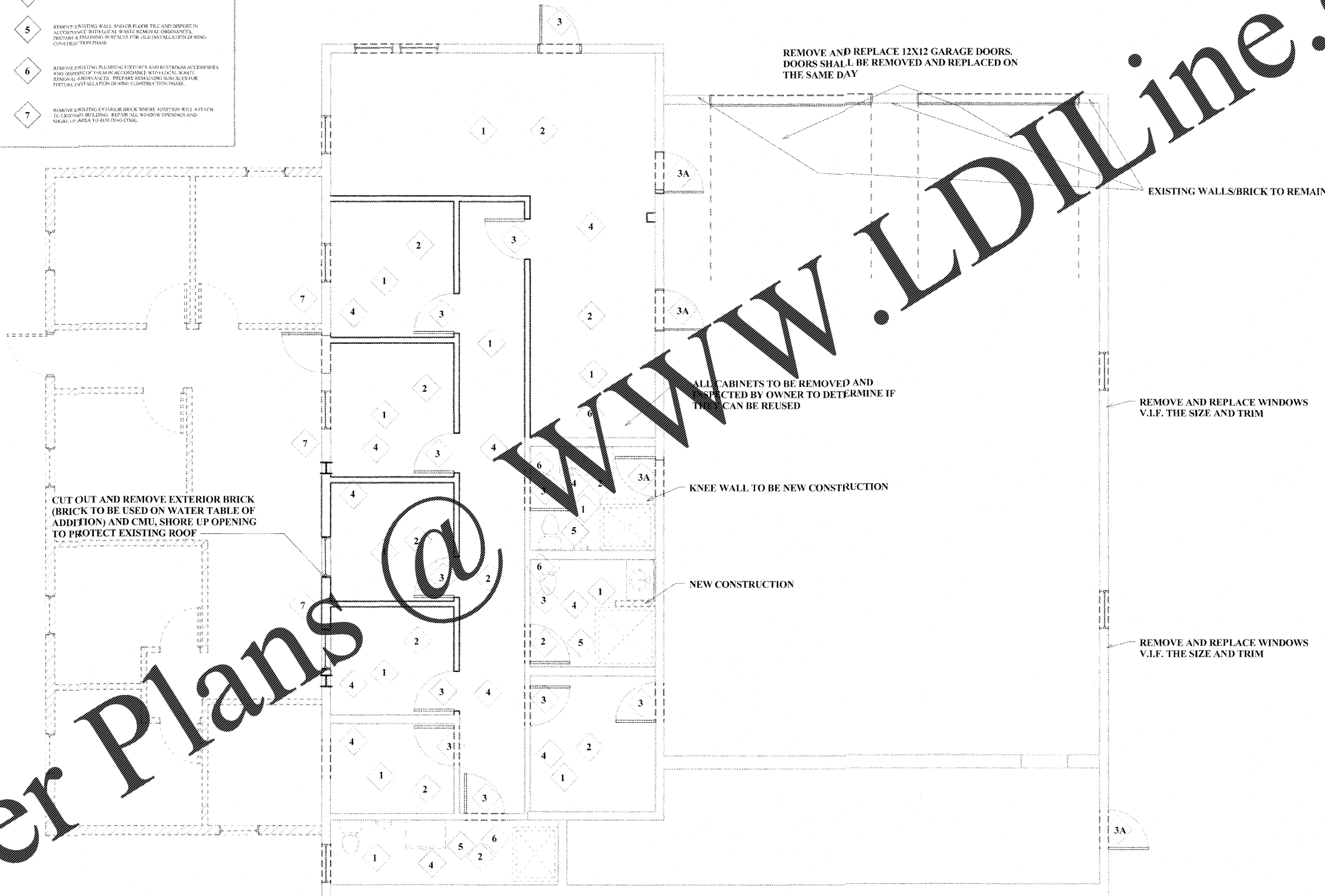

COUNTY TO HANDLE DEMOLITION

BRICK TO BE REMOVED AND SAVED BY MASONRY SUBCONTRACTOR



Miller
Architecture and Planning
Architecture - Interior Design - Renovation
Master Planning - Restoration - Commercial
Facilities Management - Residential - Industrial

6534 Spring Street, Douglasville, GA 30134
678-715-1586 | millerap.com | info@millerap.com

The drawings herein represent the physical and intellectual property of Miller Architecture and Planning and may not be reproduced or transmitted in any form without the prior written consent of said firm.

GENERAL CONSTRUCTION NOTES:

1. THE CONTRACTOR SHALL GUARANTEE TO THE OWNER ALL WORKMANSHIP AND MATERIALS, WHETHER FURNISHED BY THE CONTRACTOR OR SUB-CONTRACTORS, AGAINST DEFECTS FOR A MINIMUM PERIOD OF ONE (1) YEAR AFTER THE DATE OF FINAL ACCEPTANCE BY OWNER. FAILURE OF ANY SUCH ITEMS SHALL BE MADE GOOD BY THE CONTRACTOR AT THE CONTRACTOR'S OWN EXPENSE.
2. THE CONTRACTOR SHALL TAKE ALL NECESSARY PRECAUTIONS TO PROTECT FROM DAMAGE OR DESTRUCTION ALL EXISTING MATERIALS AND FINISHES TO REMAIN IN ADJACENT OR NEARBY AREAS. THE CONTRACTOR SHALL REPLACE ANY DAMAGED OR DESTROYED ITEMS BY OPERATIONS UNDER THIS CONTRACT.
3. PRODUCTS, TRADE NAMES AND/OR MANUFACTURERS NOTED WITHIN THESE DOCUMENTS ARE PROVIDED TO ESTABLISH A STANDARD OF QUALITY. UNLESS OTHERWISE INDICATED, APPROVED EQUAL PRODUCTS OF ANOTHER MANUFACTURER MAY BE USED WITH THE WRITTEN PERMISSION OF THE ARCHITECT. IT IS THE RESPONSIBILITY OF THE CONTRACTOR AND SUPPLIER TO PROVE TO THE ARCHITECT BEFORE THE DATE OF BID THAT THEIR PRODUCT IS EQUAL TO OR BETTER THAN THOSE PRODUCTS SPECIFIED. IF AN "OR EQUAL" PRODUCT IS USED, IT IS THE RESPONSIBILITY OF THE CONTRACTOR TO MAKE ANY NECESSARY CHANGES TO THE STRUCTURE AND INTERIOR LAYOUT AT THE CONTRACTOR'S OWN EXPENSE, AFTER OBTAINING THE ARCHITECT'S ACCEPTANCE OF SUCH CHANGES.
4. THE CONTRACTOR SHALL COORDINATE WITH THE OWNER A DESIGNATED SITE OR SITES FOR STORAGE OF MATERIALS AND EQUIPMENT FOR THE DURATION OF THE CONSTRUCTION CONTRACT.
5. DIMENSIONS SHOWN ON THE DRAWINGS ARE TO ROUGH SURFACES, EXCLUSIVE OF FINISH MATERIALS, EXCEPT AS NOTED OTHERWISE. DO NOT SCALE THE DRAWINGS.
6. THE CONTRACTOR SHALL COMPLY WITH ALL RELEVANT AND CURRENTLY ENFORCED BUILDING CODES AND LAWS BY ALL GOVERNING JURISDICTIONS, INCLUDING BUT NOT LIMITED TO ALL PROVISIONS OF THE AMERICAN WITH DISABILITIES ACT.

The contractor shall be responsible for all fees and obtaining all necessary and relevant permits and approvals relating to staging and construction of this project. The contractor shall comply with all relevant building, construction and work safety codes. The contractor shall verify all dimensions and elevations in the field before starting work and immediately report to the architect any discrepancies discovered.



DOUGLAS COUNTY FIRE STATION 3
5203 KILROY LANE
DOUGLASVILLE, GA 30135

CLIENT: DOUGLAS COUNTY
FIRE/EMS DEPARTMENT
6856 WEST BROAD STREET
DOUGLASVILLE, GA 30134

DRAWING TITLE: DEMOLITION PLAN		
ISSUANCE:	DATE:	DRAWING NO:
BID SET	SEP 2018	
		A-11
		COMMISSION: 2014
		DRAWN BY: SGA

Order Plans @

1 DEMOLITION PLAN
A-11 1/4" = 1'-0"