

REFRIGERATION RACK TO BE LOCATED IN REFRIGERATION MECHANICAL CENTER.
ALL CONTRACTORS TO VERIFY AND COORDINATE LOCATION OF RACKS WITH REFRIGERATION CONTRACTOR, ARCHITECT & STRUCTURAL ENGINEER BEFORE PERFORMING ANY RELATED WORK. ARCHITECT & STRUCTURAL ENGINEER ARE NOT PROVIDED BY HUSSMANN.

REFRIG. MECH. CENTER VENTILATION NOTE
HVAC DESIGNER TO PROVIDE A NEW VENTILATION SYSTEM FOR 4KW COMPRESSOR RACKS. DESIGN NEW VENTILATION SYSTEM BASED ON 112 HORSEPOWER TOTAL FOR NEW RACKS. SEE HVAC PLANS FOR ALL INFORMATION REGARDING VENTILATION SYSTEM.

RACK LIFTING LUGS NOTE:
IT IS RECOMMENDED THAT THE BOTTOM LIFTING LUGS ON THE RACKS BE REMOVED ONCE THE RACKS ARE IN PLACE.

HEAT RECLAIM TANK - RACK A:
PER THE REFRIGERATION SCHEDULE THE HEAT RECLAIM TANK LOAD IS WITH RACK A. ALL INVOLVED CONTRACTORS TO COORDINATE INSTALLATION PROCESS WITH REFRIG. CONTR. ARCHITECT, STRUCTURAL ENGINEER & BOX MANUFACTURER BEFORE ANY RELATED WORK. ARCHITECT, STRUCTURAL ENGINEER & BOX MANUFACTURER ARE NOT PROVIDED BY HUSSMANN.

EMERGENCY BREAK GLASS PANEL BY HUSSMAN

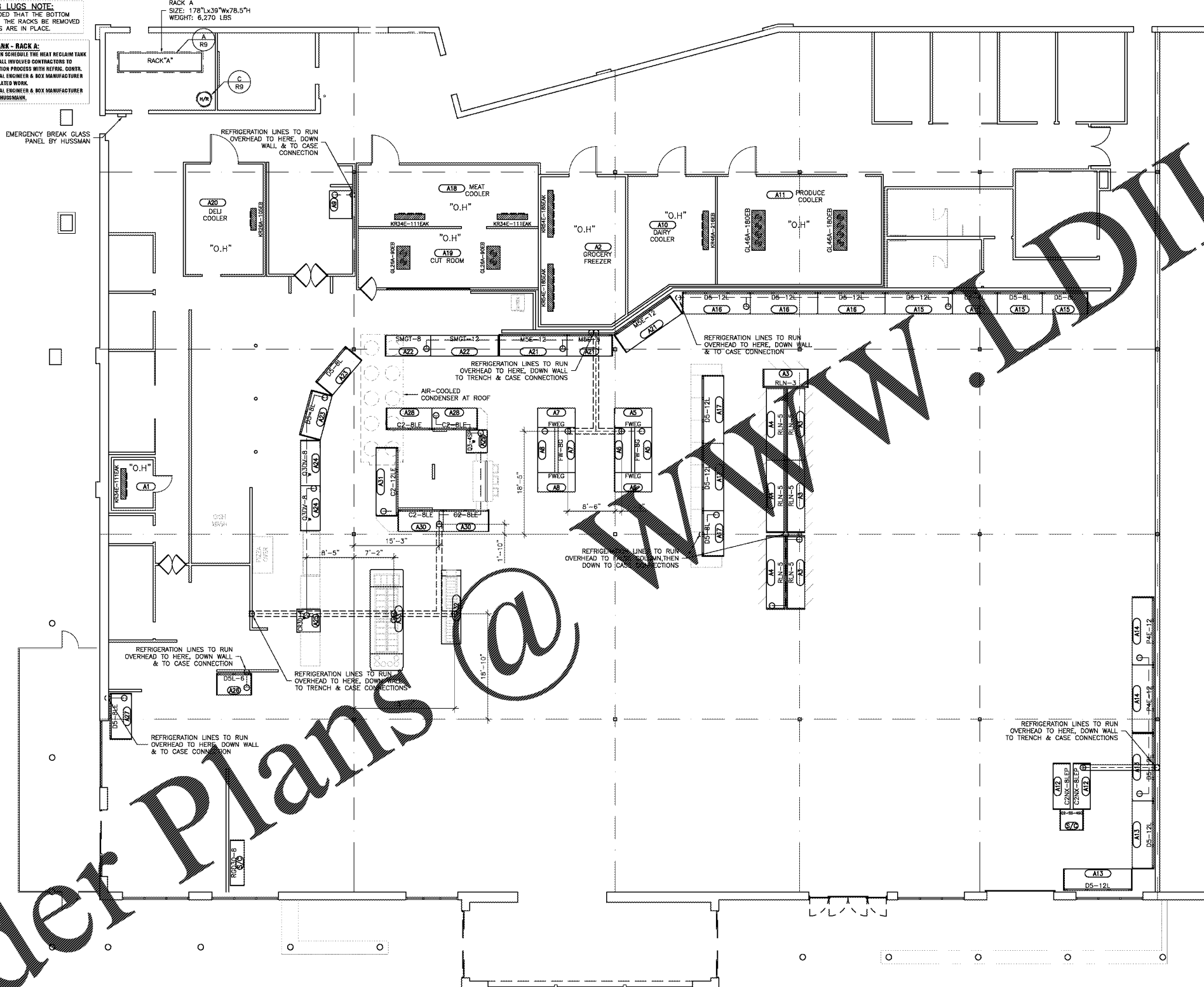

- ### GENERAL NOTES
- IT IS THE RESPONSIBILITY OF THE ARCHITECT OR DESIGNATED CONTRACTOR TO PROVIDE ALL DIMENSIONS FOR THIS PROJECT PER CUSTOMER SPECIFICATIONS AND GUIDELINES.
- ### GENERAL SHEET NOTES
- ALL REFRIGERATION LINES TO GO OVERHEAD UNLESS OTHERWISE NOTED.
 - ALL TRENCHING, SAND BACKFILL, COMPACTION CONCRETE, CONCRETE CORING, & CUTTING REQUIRED FOR REFRIGERATION LINES BY GENERAL CONTRACTOR.
 - GENERAL CONTRACTOR TO VERIFY LOCATION OF TRENCHING, CORING, OR CUTTING WITH THE REFRIG. CONTR. BEFORE WORK IS STARTED.
 - GENERAL CONTRACTOR TO FURR AROUND REFRIG. LINES FROM FLOOR TO CEILING WHERE EXPOSED.
 - REFRIGERATION CONTRACTOR TO VERIFY FINAL LOCATIONS OF OVERHEAD LINES AND TRENCHING WITH GENERAL CONTRACTOR.
 - REFRIGERATION PIPE CHASE OPENING(S) WITH CURB PER STATE AND LOCAL CODES FOR REFRIGERATION LINES PENETRATIONS AS NEEDED WHEN BEING AND TRENCHING PROTOCOL OF RACK AREA ARE BY GENERAL CONTRACTOR. CONDITIONS TO BE VERIFIED BY REFRIGERATION CONTRACTOR.
 - INSULATE ALL LOW TEMPERATURE SUCTION LINES WITH MIN. 1" INSULATION. INSULATE MEDIUM TEMPERATURE SUCTION LINES WITH MIN. 3/4" INSULATION. INSULATE ALL LINES TO COILS INCLUDING EXPOSED LINES.
 - INSULATE ALL LIQUID LINES WITH MIN. 1/2" INSULATION.
 - SLOPE SUCTION LINES TOWARD REFRIGERATION MECHANICAL CENTER (COMPRESSOR, RACK/UNITS) AT A MINIMUM OF 1" PER 20'.
 - UNDERGROUND REFRIGERATION LINES TO BE RUN THROUGH AN 8" PVC PIPE PER CUSTOMER SPECIFICATIONS. PVC PROVIDED AND INSTALLED BY REFRIGERATION CONTRACTOR.
 - TRENCH DEPTHS GUIDELINES - DEPTH OF TRENCH AT SUB-UPS TO BE A MINIMUM OF -12" AND A MINIMUM OF -18" AT RACEWAY.
 - INSTALL EXPANSION LOOP IN ALL HOT-GAS SUCTION LINES THAT EXCEED 75 FEET IN A STRAIGHT LINE. SEE ACCEPTED RULES FOR EXPANSION LOOPS OF DIFFERENT SIZE TUBING.
 - ALL TUBING SHOULD BE CLEANED AND CAPPED.
 - ONLY COMMERCIAL GRADE COPPER PIPING TO BE USED WITH HUSSMANN EQUIPMENT.
 - FOR HOT-GAS OR KOOL-GAS SYSTEMS, CONNECT AS CLOSE TO CENTER OF LINEUP AS POSSIBLE FOR MAXIMUM DEFROST EFFICIENCY.
 - ON HOT-GAS OR KOOL-GAS DEFROSTING SYSTEMS THE LIQUID LINE MUST NOT BE REDUCED. MAINTAIN THE SAME SIZE LIQUID LINE THROUGHOUT THE COMPLETE LINEUP AS SPECIFIED IN THE REFRIGERATION LEGEND.
 - REFRIGERATION CONTRACTOR TO COORDINATE REFRIGERATION LINE RUNS WITH FIRE SPRINKLER CONTRACTOR, PLUMBING CONTRACTOR, AND ALL OTHER TRADES THAT MAY BE INVOLVED.
 - ALL PIPING (REFRIGERANT, WATER, OR OTHER) REQUIRED PER THE REFRIGERATION SCHEDULE TO BE PROVIDED AND CONNECTED TO COMPRESSORS BY THE INSTALLING CONTRACTOR UNLESS NOTED OTHERWISE. ALL INVOLVED CONTRACTORS TO COORDINATE.
 - ALL VALVES FOR D/T CASES INSTALLED AT CASES.
 - NEW TRENCH PIPING TO BE USED UNLESS EXISTING TRENCH PIPING CAN BE RE-USED. FIELD VERIFY.
 - NEW CONTROLS AT EXISTING RACKS, AS SHOWN ON THE REFRIGERATION SCHEDULE, TO BE MOUNTED BY REFRIGERATION CONTRACTOR. SEE REFRIGERATION SCHEDULE FOR MORE INFORMATION.
 - REFRIGERATION CONTRACTOR TO VERIFY REFRIGERATION LINE LOCATIONS WITH PROJECT MANAGER PRIOR TO INSTALL OF NEW LINE SETS.
 - ALL DIMENSIONS GIVEN ARE FROM EITHER:
 - INSIDE FINISHED FACE OF WALL
 - OUTSIDE FINISHED FACE OF WALL
 - CENTERLINE OF COLUMN

SYMBOLS LEGEND

	NEW REFRIGERATION SYSTEM NUMBERS
	EXISTING REFRIGERATION SYSTEM NUMBERS
	"O.H." OVERHEAD REFRIGERATION LINES
	ABOVE FLOOR REFRIGERATION LINES
	UNDER FLOOR REFRIGERATION LINES
	PIPE DOWN - PIPE UP
	REFRIGERATION STUB-UP
	EXISTING REFRIGERATION STUB-UP OR REFRIGERATION LINES DROP
	REFRIGERATION LINES JUNCTION OR TERMINATION POINT
	REFRIGERATION LINES PVC FALSE COLUMN PROVIDED BY REFRIGERATION CONTRACTOR
	REFRIGERATION PIT BOX
	REFRIGERATION LINES UNDERGROUND TRENCH BY DESIGNATED CONTRACTOR

HUSSMANN®
U.C. #644405

13770 RAMONA AVENUE
CHINO, CA 91710
PHONE (909) 590-9110
FAX (909) 590-9113

SALES PERSON
ROZCO

PROJECT MANAGER
N. RENTERIA

DATE: 05.05.18
SCALE: 1/8" = 1'-0"
DRAWN BY: N. RENTERIA
CHK'D BY: _____
APR'D BY: _____
PLAN: 82419ER1-9-DNS1-4.dwg

LUCKY'S MARKET
THE PROMENADE AT NAPLES CENTRE
NEW STORE
6424 NAPLES BLVD., SUITE 601, NAPLES, FL.

REFRIGERATION FLOOR PLAN
SHEET **R3**